

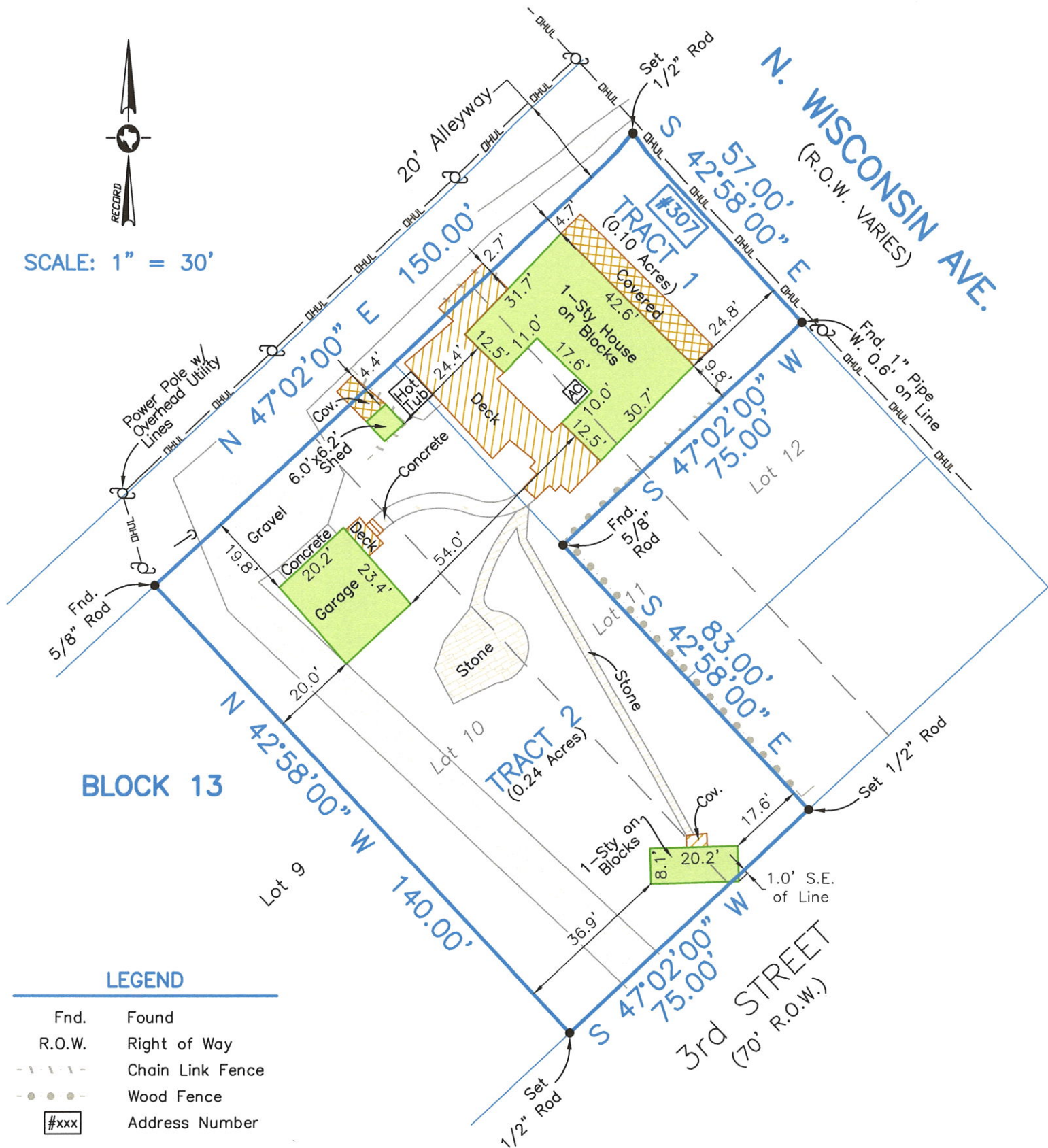

SCALE: 1" = 30'



Survey of Lot Ten (10) and parts of Lots Eleven (11) and Twelve (12), in Block Thirteen (13), of **LEAGUE CITY TOWNSITES**, a subdivision in Galveston County, Texas, according to the map or plat thereof made for J.C. League by R.W. Luttrell in 1909 and now in common use, tract surveyed as "Tract 1" being described in deed recorded under Instrument Number 2004068252 in the Galveston County Records, and tract surveyed as Tract "2" being described in deed recorded under Instrument Number 2009024219 in the Galveston County Records.

I hereby certify that on the below date, the herein described property, together with improvements located thereon, was surveyed on the ground and under my direction, and that this map, together with dimensions as shown hereon, accurately represents the facts as found on the ground this date.

Stephen C. Blaskey
Stephen C. Blaskey
Registered Professional
Land Surveyor No. 5856



SURVEY DATE:	JUNE 8, 2021
FILE No.:	4640-0015-0011-003
DRAFTING:	JMH
JOB No.:	21-0454

LEAGUE CITY OFFICE
Registration Number: 10194549
(281) 554-7739 www.hightidelandsurveying.com
200 HOUSTON AVE, SUITE B | LEAGUE CITY, TX 77573
Mailing | P.O. BOX 16142 | GALVESTON, TX 77552

NOTES:

- 1) This property partially lies within Zone "X" (shaded), defined by FEMA as areas of 0.2% Annual Chance Flood Hazard, Areas of 1% annual chance flood with average depth less than one foot or with drainage areas of less than one square mile, and Zone "AE", (BFE 14') defined by FEMA as areas subject to inundation by the 1% flood event determined by detailed methods. Mandatory flood insurance purchase requirements and floodplain management standards apply. Flood Insurance Rate Map Community-Panel Number 48167C0039G, with effective date of August 15, 2019.
- 2) This property is subject to any restrictions of record as established by the City, Plat, or Subdivision Covenants and Restrictions; may also be subject to easements and setbacks for utility services and power lines as individually recorded or established by OSHA (call your power company).
- 3) Bearings based on Monumentation of the Southwest R.O.W. line of N. Wisconsin Avenue.
- 4) Surveyed without benefit of a Title Report.