

NOTES:
 1. CONCRETE DRIVE &
 WALK OVER 5' SAN.
 S.E.

**MULLINGAR WALK
 (50' R.O.W.)**

PLAT OF LOT 3 BLOCK 4 OF SIENNA VILLAGE OF WATERS LAKE, SECTION 24-B
 ACCORDING TO THE PLAT RECORDED IN PLAT NO. 20080144 OF
 THE PLAT RECORDS OF FORT BEND COUNTY, TEXAS

PROPERTY IS NOT IN THE 100 YEAR FLOOD ZONE, IN ZONE "X"
 ACCORDING TO F.I.R.M. MAP NO. 48157C 0270J, DATE 1-3-97
 BY GRAPHING PLOTTING ONLY, WE DO NOT ASSUME RESPONSIBILITY FOR EXACT DETERMINATION.

PROPERTY SUBJECT TO SUBDIVISION COVENANTS, CONDITIONS AND RESTRICTIONS.
 I hereby certify that this survey was made on the ground and that this plat correctly represents
 the facts found at the time of survey showing any improvements, from legal descriptions supplied
 by client. There are no encroachments apparent on the ground, except as shown. This survey is
 only certified for boundary and this transaction only. Surveyor did not abstract property. Easements,
 building lines, etc. shown are as identified by:

GP 78355-79 of UNIVERSAL LAND TITLE COMPANY

This survey is being provided solely
 for the use of the current parties
 and that no license has been created,
 express or implied, to copy the survey
 except as is necessary in conjunction
 with the original transaction.

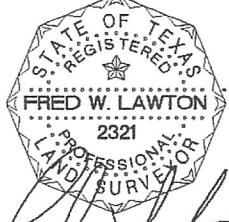

Fred W. Lawton, Registered Professional Land Surveyor No. 2321

ADDRESS: 3011 MULLINGAR WALK LENDER:
 CITY: MISSOURI CITY, TEXAS ZIP: 77459
 PURCHASER: DAVID & RODONA OLIVER
 JOB NO: NM23810 DATE: 10-18-07 SCALE: 1"=20'-00" REVISION: Key Map 650 J/N

SOUTH TEXAS SURVEYING ASSOCIATES, INC.
 BUILDER DIVISION
 11281 Richmond Ave. Suite J-101 Houston, Texas 77082
 TEL (281) 556-9715 FAX (281) 556-6959 J.D.G.
 Copyright 2007 South Texas Surveying Associates, Inc.