

*Patricia Villarreal Vargas*

**EAST TWIN PONDS**  
(100' R.O.W.)

**NOTES:**

1. ALL BEARINGS SHOWN HEREON ARE BASED ON THE RECORDED PLAT.
2. SUBJECT TO APPLICABLE RESTRICTIVE COVENANTS LISTED IN ITEM No.1, SCHEDULE "B" OF TITLE COMMITMENT ISSUED BY STEWART TITLE GUARANTY UNDER G.F. No. 1420191038.
3. AGREEMENT FOR UNDERGROUND ELECTRIC SERVICE PER C.F. No. 20130561668.

© 2014, ALLPOINTS SERVICES, CORP., All Rights Reserved. This original work is protected under copyrights laws, Title 17 U.S. Code Sections 101 & 102. All violators will be prosecuted to the extent of the law. This survey is being provided solely for the use of the recipients and no license has been created, express or implied, to copy the survey except as is necessary in conjunction with the original transaction.

**PLAT OF SURVEY**  
SCALE: 1" = 20'

**FLOOD MAP:**  
THIS PROPERTY LIES IN ZONE "X"  
AS DEPICTED ON COMMUNITY PANEL  
No. 48201C 0070 L, DATED: 6-18-07  
\*THIS INFORMATION IS BASED ON GRAPHIC PLOTTING.  
WE DO NOT ASSUME RESPONSIBILITY FOR EXACT  
DETERMINATION\*

FOR: PATRICIA VILLARREAL VARGAS  
PATRICIA MARGARITA VARGAS BRYAN  
ADDRESS:  
11 EAST TWIN PONDS  
ALLPOINTS JOB #: DG82381 KM  
G.F.: 1420191038

**LOT 41, BLOCK 1,**  
**THE WOODLANDS CREEKSIDE PARK WEST, SEC. 10,**  
**FILM CODE NO. 653031, MAP RECORDS**  
**HARRIS COUNTY, TEXAS**

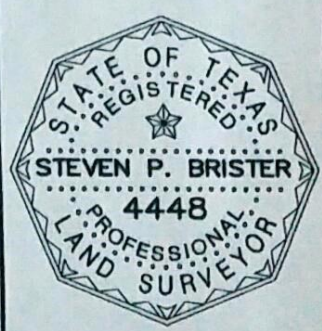

I HEREBY CERTIFY THAT THIS PLAT REPRESENTS THE RESULTS OF A SURVEY MADE ON THE GROUND, ON THE 5TH DAY OF DECEMBER, 2014.

*Steven P. Brister*

