

Legend:

- x-x-x-x-x- Fence
- Lot
- - - - - Building Line
- - - - - Easement
- Drive/Walk/Patio
- ▣ Retaining Wall
- ▨ Pad Area
- ▩ Slab/Porch
- Drainage Direction

Structural Options:

1. Foundation: 3 Sides Brick.
2. Roofing : 6:12 Pitch
3. Covered Patio

Lot Coverage Calculations:

Lot Area	5986 Sq. Ft.
Slab Area	2078 Sq. Ft.
Coverage Ratio	35%

Sod Calculation:

Front	201 Sq.Yd.
Side	146 Sq.Yd.
Rear	155 Sq.Yd.
Total	502 Sq.Yd.

Fence Calculation:

Front	21 Ln.Ft.
Left	79 Ln.Ft.
Right	79 Ln.Ft.
Back	51 Ln.Ft.
Total	230 Ln.Ft.

Flatwork Areas:

Private Walk (A)	40 Sq. Ft.
Driveway (B)	422 Sq. Ft.
In-Turn (C)	189 Sq. Ft.
Public Walk (D)	664 Sq. Ft.
Conc. Patio (E)	0 Sq. Ft.
AC Pad	16 Sq. Ft.

- General Notes:**
1. The purpose of this plan is to show the proposed building footprint as defined by the metes and bounds of the recorded plat.
 2. Dimensions, setbacks, easements, plan selection, and any other information shown here in shall be verified at permitting and prior to construction for accuracy and compliance with all applicable codes and ordinances.
 3. Builder is solely responsible for ensuring that the footprint is contained within the prepared building pad. The building pad shall be set high enough to allow for adequate drainage.
 4. All calculations are approximate. They must be verified prior to permitting, purchasing, and/or construction.
 5. Per FEMA Floodplain Map 48339C0600G, dated 08-18-2014, this property lies entirely within the Unshaded Zone "X".

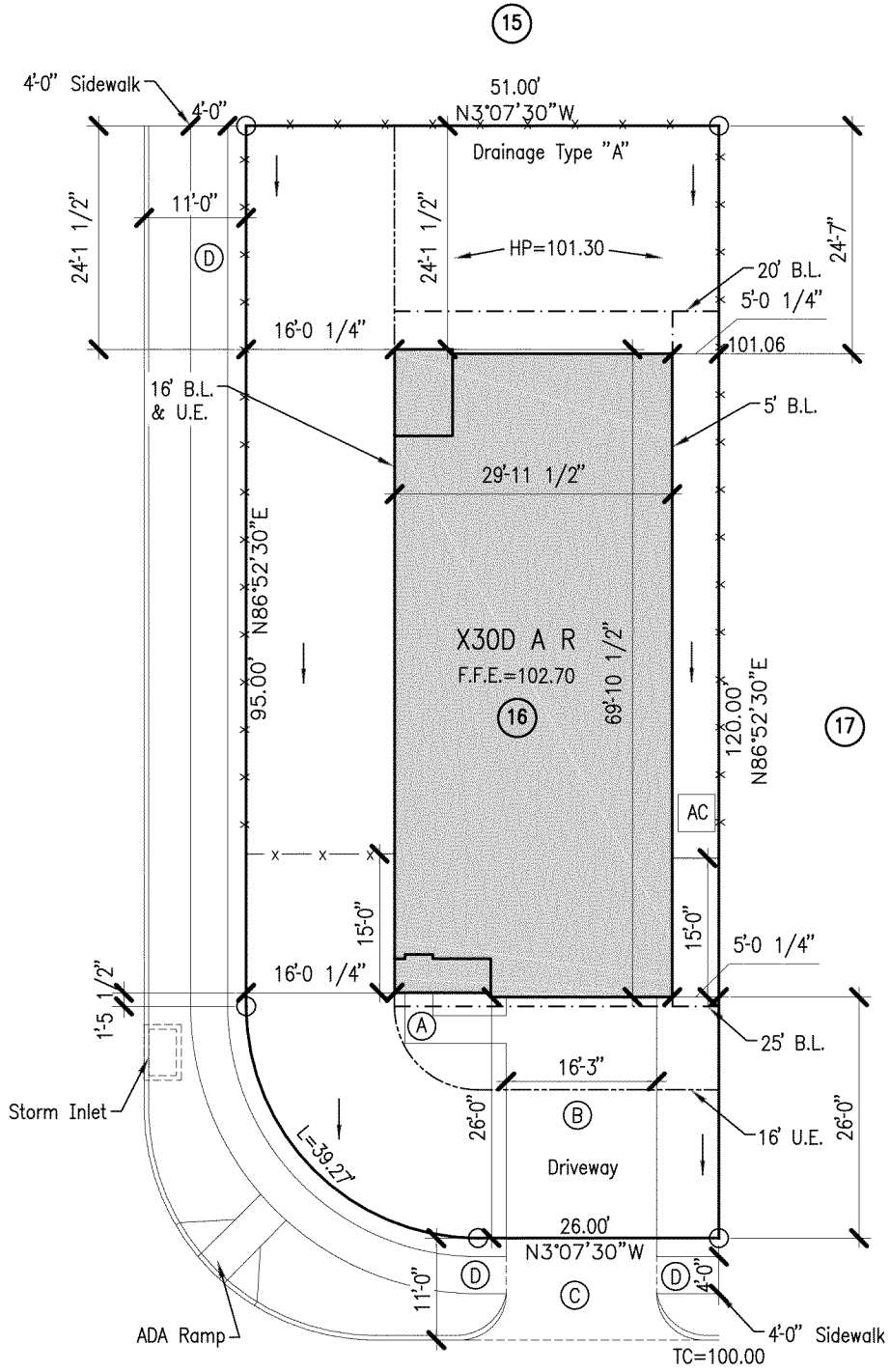

Houston - North Plot Plan - Harrington Trails Section 5A X30D AR LOT 16 BLK 5 (2162793PL).dwg 1/10/2022 9:20:42 AM Audit#: 7911

STRAND 2162793	PL1	DATE	1/07/22	BUILDER	Express Homes Houston (North)	VER. 4	PLOT PLAN	 1/10/22	10003 Technology Blvd. West Dallas, TX 75220 972-620-8204 Registration No. F-1629	STRAND
		SCALE	1"=20'	SUBD.	Harrington Trails Section 5A					
		DRN	J.F.	LOT	16 BLOCK 05					
				ADDRESS	14596 Valley Ridge Drive					
				CITY	New Caney, Texas					
				PLAN	X30D A R					