

## Building Sketch

Borrower	Conner Turner			
Property Address	9639 Weatherwood Dr			
City	Houston	County Harris	State TX	Zip Code 77080
Lender/Client	Security America Mortgage			

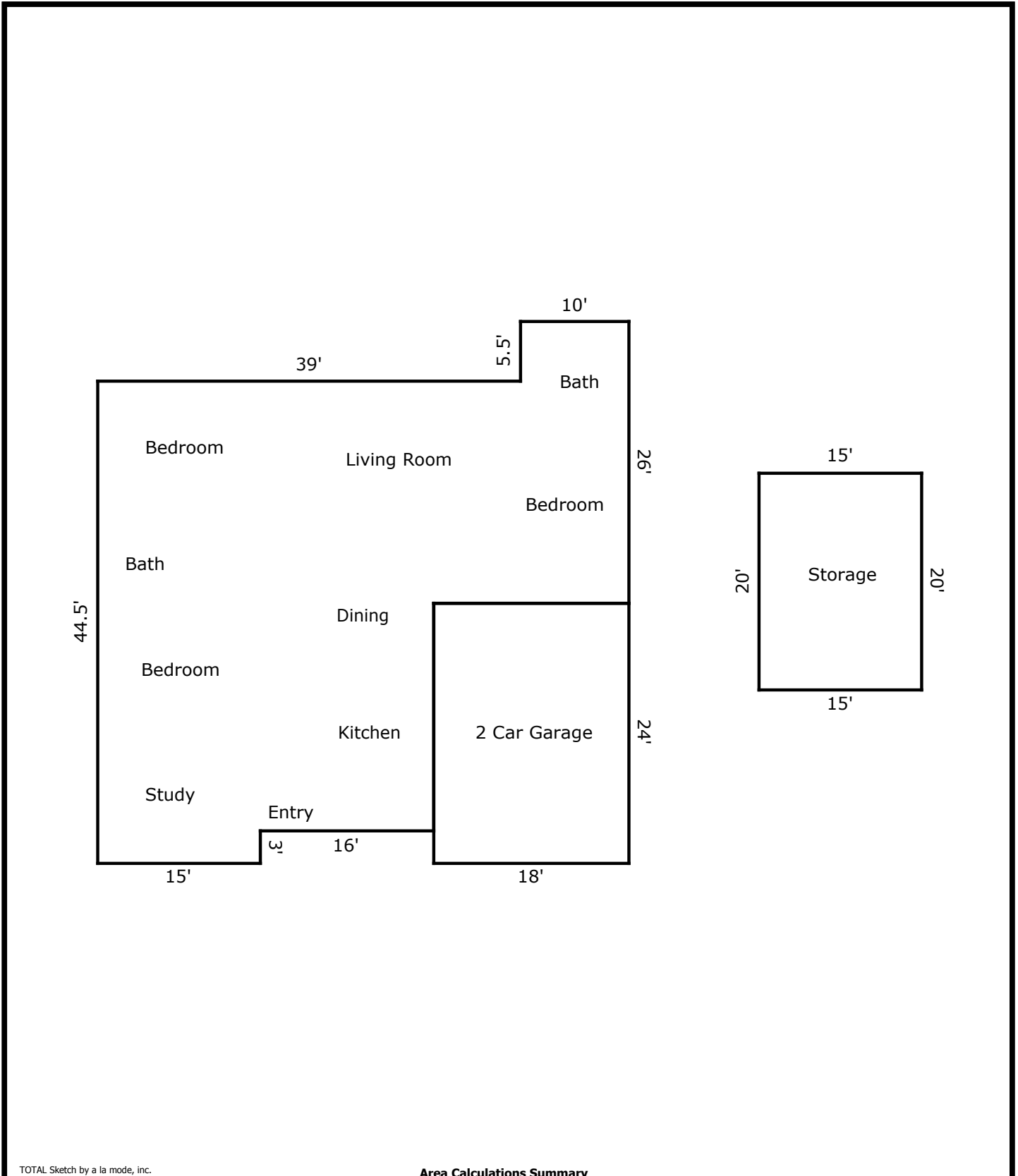

TOTAL Sketch by a la mode, inc.

### Area Calculations Summary

Living Area	Calculation Details	
First Floor	1755.5 Sq ft	$10 \times 5.5 = 55$ $20.5 \times 18 = 369$ $31 \times 41.5 = 1286.5$ $3 \times 15 = 45$
<b>Total Living Area (Rounded):</b>	<b>1756 Sq ft</b>	
Non-living Area		
2 Car Attached	432 Sq ft	$24 \times 18 = 432$
Storage	300 Sq ft	$20 \times 15 = 300$