

## Building Sketch

Borrower	Alicia M. Jammer			
Property Address	29459 Westhope Dr			
City	Spring	County	Montgomery	State TX Zip Code 77386
Lender/Client	Alicia M. Jammer			

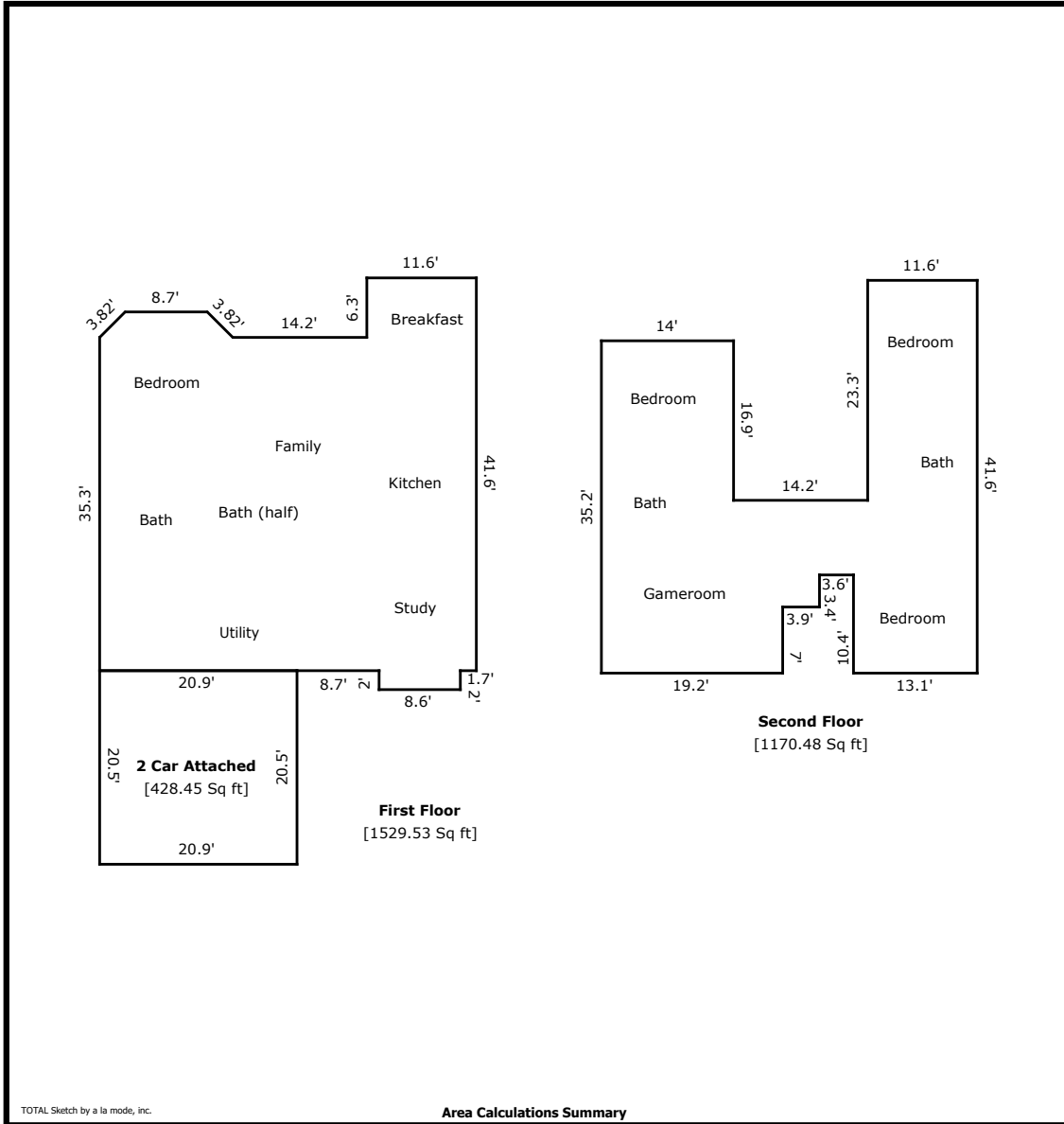

TOTAL Sketch by a la mode, inc.

### Area Calculations Summary

Living Area	Area	Calculation Details
First Floor	1529.53 Sq ft	$0.5 \times 2.7 \times 2.7 = 3.64$ $0.5 \times 2.7 \times 2.7 = 3.64$ $8.7 \times 2.7 = 23.49$ $8.6 \times 2 = 17.2$ $39.9 \times 35.3 = 1408.47$ $11.6 \times 6.3 = 73.08$
Second Floor	1170.48 Sq ft	$11.6 \times 23.3 = 270.28$ $14 \times 16.9 = 236.6$ $18.3 \times 19.2 = 351.36$ $13.1 \times 10.4 = 136.24$ $3.9 \times 3.4 = 13.26$ $7.9 \times 20.6 = 162.74$
<b>Total Living Area (Rounded):</b>	<b>2700 Sq ft</b>	
<b>Non-living Area</b>		
2 Car Attached	428.45 Sq ft	$20.9 \times 20.5 = 428.45$

# Certification



The Ambrose Group  
Appraisal Services

## QUALIFICATIONS OF JAMES R. HAMON

James R. Hamon is a State Certified General Real Estate Appraiser in the State of Texas with The Ambrose Group, which has offices in Houston, Dallas and San Antonio, Texas. Mr. Hamon is under the direct supervision of David M. Ambrose, MAI, president of The Ambrose Group. Mr. Hamon's experience includes the valuation of residential and commercial properties.

## BIOGRAPHICAL DATA

Mr. Hamon was born in Houston, Texas in 1982. He graduated from Friendswood High School in Friendswood, Texas prior to attending Texas Christian University.

## EDUCATION

Bachelor of Business Administration (Finance)  
Texas Christian University, Fort Worth (2004)

## MISCELLANEOUS

State Certified General Real Estate Appraiser - Certificate No. TX-1338001-G

	<b>Certified General Real Estate Appraiser</b>
Appraiser: <b>James Robert Hamon</b>	License Expires: <b>07/31/2024</b>
License #: <b>TX 1338001 G</b>	
Having provided satisfactory evidence of the qualifications required by the Texas Appraiser Licensing and Certification Act, Occupations Code, Chapter 1103, authorization is granted to use this title: Certified General Real Estate Appraiser	
For additional information or to file a complaint please contact TALCB at <a href="http://www.talcb.texas.gov">www.talcb.texas.gov</a> .	 <b>Chelsea Buchholtz Commissioner</b>

## Certification

Borrower	Alicia M. Jammer				
Property Address	29459 Westhope Dr				
City	Spring	County	Montgomery	State	TX Zip Code 77386
Lender/Client	Alicia M. Jammer				



The Ambrose Group  
Appraisal Services

### QUALIFICATIONS OF CHASE E. PETRICH

Chase E. Petrich is an Appraiser Trainee with The Ambrose Group, Appraisal Division, which has offices in Spring, Houston and Dallas, Texas. Mr. Petrich is under the direction and supervision of Roland Gomez, Senior Appraiser at The Ambrose Group. Mr. Petrich's experience includes the valuation of residential properties.

### BIOGRAPHICAL DATA

Mr. Petrich was born in Houston, Texas in 1994. He graduated from Cypress Woods High School in Cypress, Texas in 2012 prior to attending college at Texas Tech University.

### EDUCATION

Undergraduate Studies

Bachelor of Science, Kinesiology: Texas Tech University (2012 – 2017)

### PROFESSIONAL AFFILIATIONS

Appraiser Trainee  
Authorization #: TX 1342806

	<b>Appraiser Trainee</b>
Trainee: <b>Chase Edward Petrich</b>	
Authorization #: <b>TX 1342806 Trainee</b>	Expires: <b>08/31/2023</b>
Review the list of the above Trainee's Supervisors on the License Holder Search at <a href="http://www.talcb.texas.gov">www.talcb.texas.gov</a> .	
Having provided satisfactory evidence of the qualifications required by the Texas Appraiser Licensing and Certification Act, Occupations Code, Chapter 1103, authorization is granted to use this title: Appraiser Trainee	
For additional information or to file a complaint please contact TALCB at <a href="http://www.talcb.texas.gov">www.talcb.texas.gov</a> .	 <b>Chelsea Buchholtz</b> Commissioner