

EXHIBIT "A"

A tract of land containing 3.251 acres out of the I. & G.M.R.R. Survey, Abstract Number 398 for Waller County, Texas and Abstract Number 966 for Harris County, Texas, and being a portion of a called 17.4 acre tract as described in deed to Reuben Mayer as recorded under Volume 2598, Page 321 of the Harris County Deed Records (H.C.D.R.) with bearings based on said deed and being more particularly described by metes and bounds as follows:

BEGINNING at a 1/2 Inch iron rod found for the southwest corner of a said 17.4 acre tract and the northwest corner of a called 123 acre tract as described in deed to M. S. Worley ET AL as recorded under Harris County Clerk's File Number (H.C.C.F.No.) D142038 and being in the easterly right-of-way line of F.M. 362 (Called 100 feet wide);

THENCE N 19 deg 28 min 42 sec W, along said easterly right-of-way line of F.M. 362 and along the westerly line of said 17.4 acre tract a distance of 249.00 feet to a 1/2 Inch iron rod (found) for the northwest corner of the herein described tract;

THENCE N 73 deg 16 min 46 sec E, through said 17.4 acre tract a distance of 446.84 feet to 5/8 Inch Iron rod (found) with "Swonkye" plastic cap for the northeast corner of the herein described tract;

THENCE S 19 deg 30 min 36 sec E, continuing through a portion of said 17.4 acre tract a distance of 386.44 feet to a 5/8 Inch iron rod (found) with "Swonkye" plastic cap in the south line of said 17.4 acre tract and the north line of the aforementioned 123 acre tract and being the southwest corner of the herein described tract;

THENCE West, (with this line held for bearing) along the south line of said 17.4 acre tract and the north line of said 123 acre tract a distance of 473.65 feet to the Point of Beginning and containing 3.251 acres of land.

RP 023-93-2191

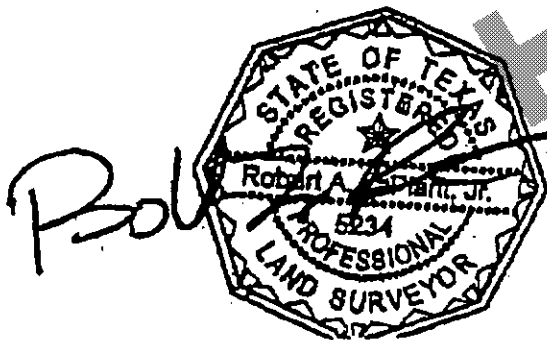

RECORDER'S MEMORANDUM:
At the time of recordation, this instrument was found to be inadequate for the best photographic reproduction because of illegibility, carbon or photo copy, discolored paper, etc. All blockouts, additions and changes were present at the time the instrument was filed and recorded.

A separate plat map has been prepared in conjunction with these metes and bounds.

ANY PROVISION HEREIN WHICH RESTRICTS THE SALE, RENTAL, OR USE OF THE DESCRIBED REAL PROPERTY BECAUSE OF COLOR OR RACE IS INVALID AND UNFORCEABLE UNDER FEDERAL LAW.
THE STATE OF TEXAS
COUNTY OF HARRIS
I hereby certify that this instrument was FILED in file number Sequence on the date and at time stamped herein by me, and was duly RECORDED, in the Official Public Records of Real Property of Harris County Texas on

JUN 29 2006



Dorothy B. Keyman
COUNTY CLERK
HARRIS COUNTY, TEXAS

FILED
2006 JUN 29 PM 12:07
County Clerk
HARRIS COUNTY, TEXAS
COPY

D