

305 Glenwood Drive

SITE PLAN

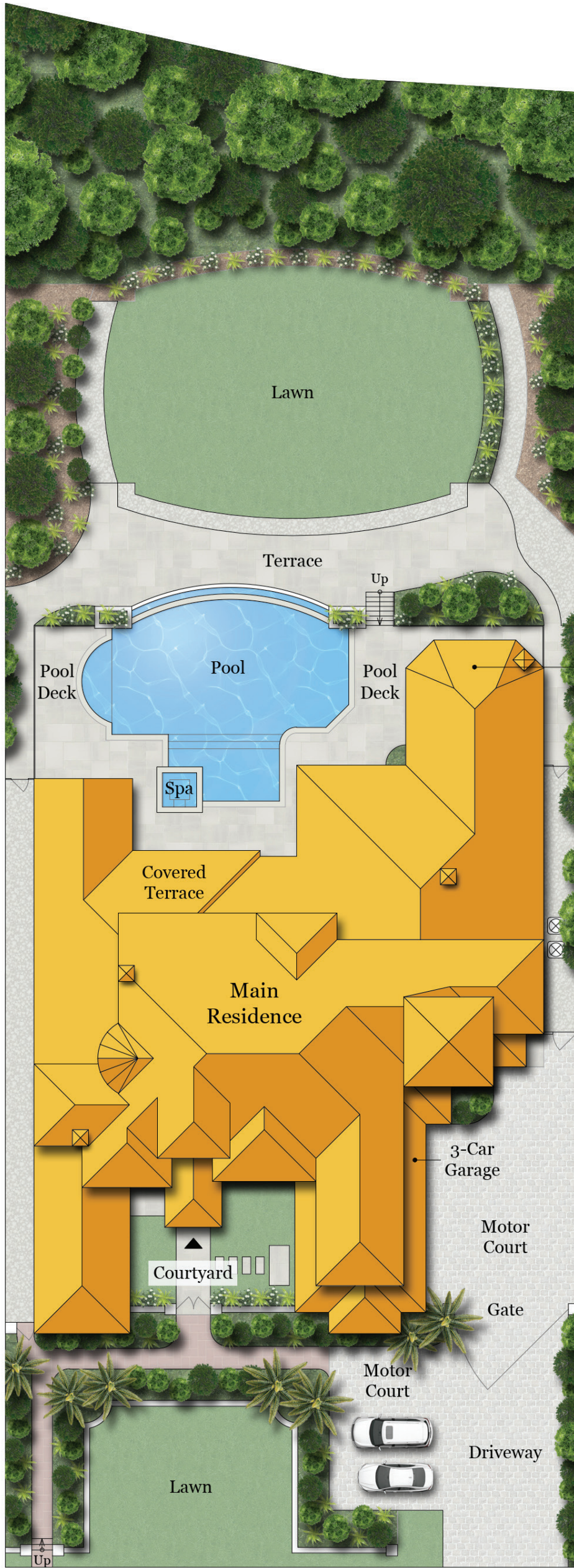

Covered Terrace w/Outdoor Kitchen

3-Car Garage

Motor Court

Gate

Motor Court

Driveway

Glenwood Dr

Walter Bering 713.851.9753

Broker Associate walter.bering@sothebys.realty

Martha Turner | Sotheby's INTERNATIONAL REALTY

If your property is listed with a real estate broker, please disregard. It is not our intention to solicit the offerings of other real estate brokers. We are happy to work with them and cooperate fully. This material is based upon information which we consider reliable but because it has been supplied by third parties, we cannot represent that it is accurate or complete and it should not be relied upon as such. This offering is subject to errors, omissions, changes including price or withdrawal without notice. Sotheby's International Realty and the Sotheby's International Realty logo are registered (or unregistered) service marks used with permission. Operated by Sotheby's International Realty, Inc. © MMXIII Sotheby's International Realty, Inc. All Rights Reserved. An Equal Opportunity Company. Equal Housing Company.

305 Glenwood Drive



Estimated Total Finished Square Footage: 7,755 SQ FT

Above-Grade: 7,755 SQ FT Below-Grade: N/A
Plus 960 SQ FT 3-Car Garage on Main Level
Calculated per ANSI Standard Z765-2003.

* Estimated Total Finished & Unfinished Square Footage: 8,715 SQ FT

MAIN LEVEL
4,990 SQ FT

Walter Bering 713.851.9753
Broker Associate walter.bering@sothebys.realty

Martha Turner | Sotheby's
INTERNATIONAL REALTY

If your property is listed with a real estate broker, please disregard. It is not our intention to solicit the offerings of other real estate brokers. We are happy to work with them and cooperate fully. This material is based upon information which we consider reliable but because it has been supplied by third parties, we cannot represent that it is accurate or complete and it should not be relied upon as such. This offering is subject to errors, omissions, changes including price or withdrawal without notice. Sotheby's International Realty and the Sotheby's International Realty logo are registered (or unregistered) service marks used with permission. Operated by Sotheby's International Realty, Inc. © MMXIII Sotheby's International Realty, Inc. All Rights Reserved. An Equal Opportunity Company. Equal Housing Company.

305 Glenwood Drive



Walter Bering 713.851.9753
Broker Associate walter.bering@sothebys.realty

Martha Turner | Sotheby's
INTERNATIONAL REALTY

If your property is listed with a real estate broker, please disregard. It is not our intention to solicit the offerings of other real estate brokers. We are happy to work with them and cooperate fully. This material is based upon information which we consider reliable but because it has been supplied by third parties, we cannot represent that it is accurate or complete and it should not be relied upon as such. This offering is subject to errors, omissions, changes including price or withdrawal without notice. Sotheby's International Realty and the Sotheby's International Realty logo are registered (or unregistered) service marks used with permission. Operated by Sotheby's International Realty, Inc. © MMXIII Sotheby's International Realty, Inc. All Rights Reserved. An Equal Opportunity Company. Equal Housing Company.