

Tract No. 21
 Dennis J. Mahoney
 2.000 ac
 Clerk's File No. 98-046075

Tract No. 20
 Dennis J. Mahoney
 2.000 ac
 Clerk's File No. 98-046075

Tract No. 19
 San N. Napoleon
 2.000 ac
 Clerk's File No. 97-024797

FND. 1/2" I.R.

Tract No. 15B
 Cindy Suckles
 6.000 ac

FND. 1/2" I.R.

FND. 1/2" I.R.

P.O.B.
 FND. 1/2" I.R.

FND. 1" I.P.

FND. 1 1/2" I.P.

N 86°41'00" E
 400.0000'

N 03°19'00" W
 217.8000'

S 86°41'00" W
 400.0000'

S 03°19'00" E
 217.8000'

COUNTY ROAD No. 48

N 03°19'00" W
 780.57'

S 89°37'15" W
 28.4200'

S 89°34'34" W
 128.1100'

ANGLE PT. COUNTY ROAD No. 1462

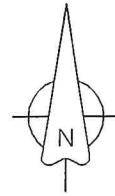

SURVEYOR'S NOTE:
 UNDER SCHEDULE B:
 EXCEPTION FROM COVERAGE

- (9)
- 12: Not located on Tract
- 13: Not located on Tract
- 14: Not located on Tract
- 15: Not located on Tract

The undersigned does hereby certify that this survey was this day made on the ground of the property legally described hereon and is correct, and that there are no discrepancies, conflict, encroachments, or other improvements, apparent easements, or rights of way, except as shown hereon, and that the property is not adjacent to and from a dedicated roadway, except as shown.

Surveyed on the ground May 15, 2003

W.E. Wilson (W. E. Wilson)
 Registered Professional Land Surveyor No. 4652
 G&G SURVEY AND CONSULTING, INC.
 1037 F. M. 359
 RICHMOND, TEXAS 77469
 (281) 344-8505

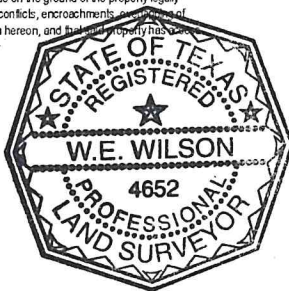

FLOOD INSURANCE NOTE: By graphics plotting only, this property is in ZONE X of the Flood Insurance Rate Map, Community Panel No. 48039C0275 H effective date of June 05, 1989. Exact designations can only be determined by an Elevation Certificate. Based on the above information, this property IS NOT in a Special Flood Hazard Area.

Prepared for
 Dennis J. Mahoney
 2.00 acres In the H.T.& B. R. R. Company Survey
 Section No. 10, Abstract No. 535, Brazoria County,
 Texas. (Same being Tract No. 20)

Scale: 1"=100'	Date: 05/19/03	LT:
Drawn: G.P.Y.	Checked: W.E.W.	Job: 511256-B