

**AUTUMN POND CIRCLE
(CUL-DE-SAC)**

**PLAT OF SURVEY
SCALE: 1" = 20'**

NOTES:

1. ALL BEARINGS SHOWN HEREON ARE BASED ON THE RECORDED PLAT.
2. SUBJECT TO APPLICABLE RESTRICTIVE COVENANTS LISTED IN ITEM No.1, SCHEDULE "B" OF TITLE COMMITMENT ISSUED BY ALAMO TITLE INSURANCE Co. UNDER G.F. No. ATCH-05-ATCH14041427CI.

FLOOD MAP:
THIS PROPERTY LIES IN ZONE "X"
AS DEPICTED ON COMMUNITY PANEL
No. 48039 C 0135 I, DATED: 09-22-99
"THIS INFORMATION IS BASED ON GRAPHIC
PLOTTING ONLY. WE DO NOT ASSUME
RESPONSIBILITY FOR EXACT DETERMINATION"

© 2014, ALLPOINTS SERVICES, CORP., All Rights Reserved. This original work is protected under copyrights laws, Title 17 U.S. Code Sections 101 & 102. All violators will be prosecuted to the extent of the law. This survey is being provided solely for the use of the recipients and no license has been created, express or implied, to copy the survey except as is necessary in conjunction with the original transaction.

FOR: MATTHEW MICHAEL ELLER
BRITTANI DAWN ELLER
ADDRESS: 1805 AUTUMN POND
CIRCLE
ALLPOINTS JOB #: KHS9821 AF
G.F.: ATCH-05-ATCH14041427CI

**LOT 4, BLOCK 1,
MIDTOWN PARK SUBDIVISION, SECTION 1,
DOC. NO. 2005072042, OFFICIAL RECORDS
BRAZORIA COUNTY, TEXAS**

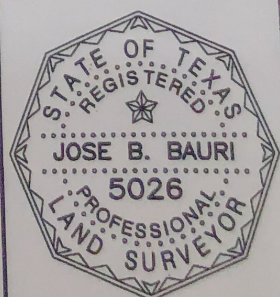

I HEREBY CERTIFY THAT THIS PLAT REPRESENTS THE RESULTS OF A SURVEY MADE ON THE GROUND, ON THE 19TH DAY OF NOVEMBER, 2014.

Jose B. Bauri

