

# ENVIRONMENTAL ENFORCEMENT OFFICE

Les Labertew  
Environmental Enforcement Officer  
Burleson County  
countyeeo@burlesoncounty.org



100 West Buck St, Suite 303  
Caldwell, Texas 77836  
Phone:(979) 567-2360  
Fax:(979) 567-2371

## LICENSE TO OPERATE ON-SITE SEWAGE FACILITY

OSSF PERMIT #: 2018086

# OF BEDROOMS: 2

NAME: CESAR MORA

MAXIMUM GPD: 180

PHYSICAL ADDRESS: 207 SLEEPY HOLLOW SOMERVILLE, TX 77879

INSTALLER: SUROVSK, FRANK JR.

LICENSE NUMBER: OSO 29560

DATE OF FINAL INSPECTION: 12/20/2018

The private sewage facility licensed above was installed according to the current and minimum guidelines of the Texas Commission on Environmental Quality (TCEQ) and Burleson County.

This is a NON-TRANSFERABLE license. Upon transfer of ownership, the new owner is required to transfer the original license into his/her name. Should the system malfunction in the future, it will be the licensee's responsibility to bring the system in compliance with all current TCEQ and county regulations.

We strongly recommend pumping of the primary treatment tank (also known as the trash tank) every 2 to 3 years or as needed.

To help with the evapotranspiration process, the drainfield should be mowed on a regular basis. However, it is recommended that livestock NOT be allowed to walk or graze on the drainfield.

The specified should not be altered or covered in any way except for sodded grass or grass seeded cover to promote evaporation. All plumbing in the house should be kept in good repair to minimize flooding of the drainfield.

This license does not extend to the materials workmanship, or fabrication, of the system so as to expressly or impliedly grant the owner, or installer of the system any warranty by or rights against Burleson County Authorized Agent or it's designated representative as to the quality or durability of the system, nor compliance with licensee's individual specifications and requirements, but solely relates to the system meeting the requirements of the above named regulatory body in effect as of this date.

SPECIAL NOTE: \_\_\_\_\_

Signature of Designated Representative :

*Les Labertew*

Date: 12/20/2018

Designated Representative License Number:

05 0031182

# ENVIRONMENTAL ENFORCEMENT OFFICE

Les Labertew  
Environmental Enforcement Officer  
Burlison County  
countyeeo@burlisoncounty.org



100 West Buck St, Suite 303  
Caldwell, Texas 77836  
Phone: (979) 567-2360  
Fax: (979) 567-2371

## ON-SITE SEWAGE FACILITY CONSTRUCTION INSPECTION

OSSF PERMIT #: 2018086

NAME: CESAR MORA

PHYSICAL ADDRESS: 207 SLEEPY HOLLOW SOMERVILLE, TX 77879

INSTALLER: *Surovik, Frank Jr.*

LICENSE NUMBER: OSO *29560*

SYSTEM TYPE:  Aerobic/Spray Distribution  Wetland  
 Anaerobic/Sub-surface disposal  Other

INSPECTION RESULT:  Passed, License will be sent within 7 working days  
 Failed, Please see below deficiencies:

DEFICIENCIES:  No electrical power to system  
 System not constructed or incomplete at time of inspection  
 Installer not on site at time of inspection  
 Improper back fill material (must use Class Ib, II, III Soil type)  
 System component failure: \_\_\_\_\_  
 Other: \_\_\_\_\_

Date of Inspection : *12/20/2018* Time: *3:00pm*

Designated Representative: *Leslie Labertew* DR License Number: *050031182*

Note: If system construction "Failed," please call for re-inspection at (979) 567-2360

April 30, 2018

**Travis Weiser, PE 107845**  
**STW Engineering, PLLC F-14496**  
**5962 FM 1624**  
**Lexington, Tx 78947**  
**979-224-7748**  
**s.travis.weiser@gmail.com**

Name: Cesar Mora  
Address: 203 Sleepy Hollow Drive Somerville, Texas  
County: Burleson  
Subdivision: Birch Creek Forest Section 3, Block 8 Lot 55 and 56

Installer:  
Phone:

Pro Flo 500 SLPT<sup>2</sup>  
Pre Treatment Tank: 397 gal Treatment tank  
Aeration Chamber: 620 gal  
Pump Tank: 768 gal  
Pump: 1- ½ hp Franklin or equiv  
Sprinklers: 2 X Krain low angle spray heads with #3 nozzle @ 30 PSI Dosing Rate (3.0 gpm per head)  
Lateral Line – 150 LF of 1.25" Sch 40  
Collection Main Line – 20 LF of 4" Sch 40  
Chlorinator: Liquid  
Dosing Tank: None

**Selection:**

Friction Head = 125 LF of 1-1/4" supply line=	
0.55 x (125ft/100ft) + 20 %	0.8 ft
Pressure Head =	78.3 ft
Elevation Head =	5.7 ft
Total Head=	84.8 ft

**Pump Capacity: minimum of 6 gpm @ 84.8 T.D.H.**

**Pump Float Switch heights:**

Alarm Height: 44 inches  
Turn On Height: 30 inches  
Turn Off Height: 10 inches

**House Details**

Bedroom: 2 bedrooms  
Square Footage: Less Than 1500 SF  
Water Saving Fixtures: Yes  
Water Supply: Public  
Flood Hazard: 100 year Floodplain: No  
Daily Flow: 180 gpd



# OSSF SOIL EVALUATION

DATE PERFORMED: 5/25/17

PROPOSED EXCAVATION DEPTH: 5'

NAME OF SITE EVALUATOR: Travis Weiser

REG.# 107845

**Requirements:**

At least two soil excavations must be performed on the site, at opposite ends of the proposed disposal area. Locations of soil boring or dug pits must be shown on the site drawing. For subsurface disposal, soil evaluations must be performed to a depth of at least two feet below the proposed excavation depth. For surface disposal, the surface horizon must be evaluated. Describe each soil horizon and identify any restrictive features on the form. Indicate depths where features appear.

Soil Boring Number: 1

Depth (feet)	Textural Class	Structure (if applicable)	Drainage (Mottles/ Water Table)	Restrictive Horizon	Observations
0-	 IV ↓	Red clay		clay	
1-					
2-					
3-					
4-					
5-	_____				

Soil Boring Number: 2

Depth (feet)	Textural Class	Structure (if applicable)	Drainage (Mottles/ Water Table)	Restrictive Horizon	Observations
0-	 TV ↓	Red clay			
1-					
2-					
3-					
4-					
5-	_____				

I certify that the findings of this report are based on my field observations and are accurate to the best of my ability.

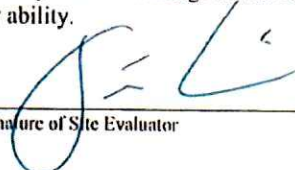
  
 \_\_\_\_\_  
 Signature of Site Evaluator

4/30/18  
 \_\_\_\_\_  
 Date



# Burleson County, Texas

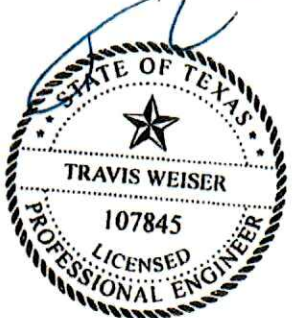
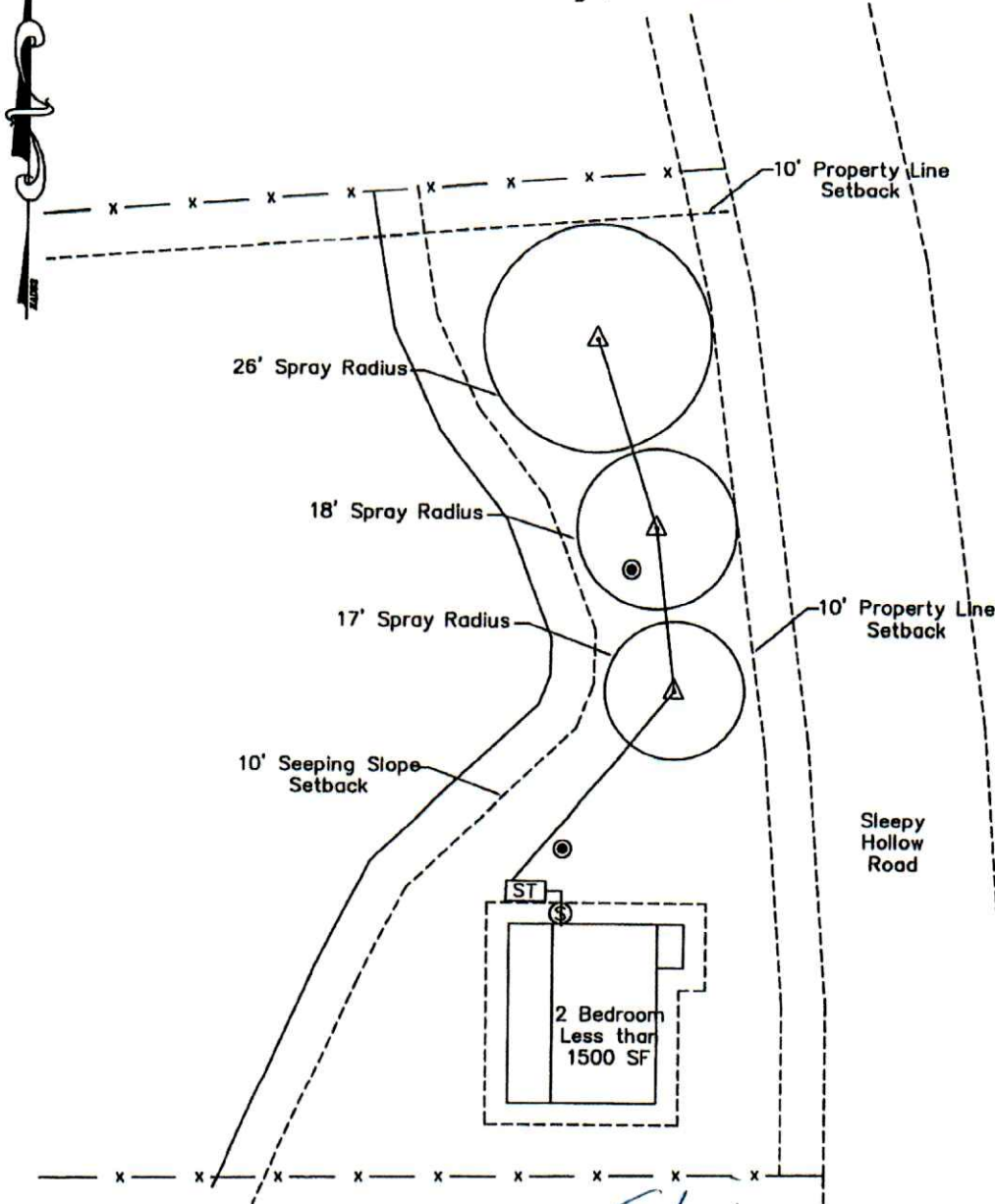

4/28/18

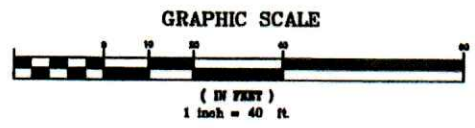

- ⊙ Two Way Cleanout
- Bore Hole Locations
- ST Septic Tank (Pro Flo 500)
- ET Existing Tank
- Solid Pipe
- △ Spray Head

STW Engineering, PLLC F-14496 5962 FM 1624, Lexington Texas 78947	By: STW	Date: 4/30/18	Scale: 1" = 40'
	Rev:	File# OSSF Sleepy H.dwg	WO # 178

