

LAKE LIVINGSTON

ARROWHEAD LANE
18' Asphalt County Road

NOTE:
A PLAT OF THE LAKESIDE VILLAGE SUBD.,
PHASE 2 IS RECORDED IN VOLUME 7, PAGE 36
OF THE DEED RECORDS OF SAN JACINTO COUNTY,
TEXAS.

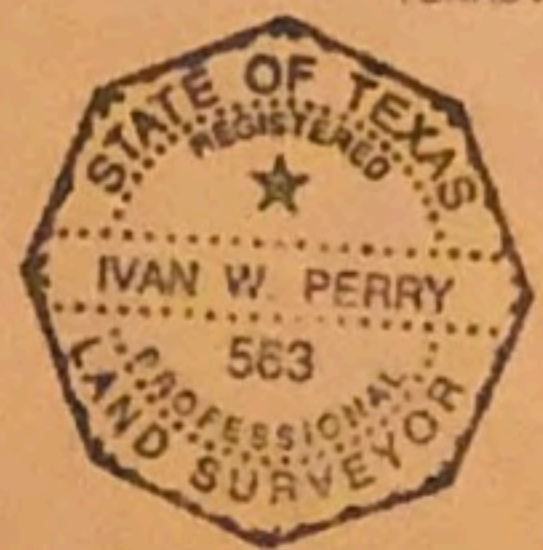

I HEREBY CERTIFY THAT THIS PLAT
CORRECTLY SHOWS THE RESULTS OF
A SURVEY THAT WAS MADE UNDER MY
SUPERVISION, THAT THERE ARE NO
ENCROACHMENTS OR PROTRUSIONS AND
THAT THE LAND HAS ACCESS TO AND
FROM A DEDICATED PUBLIC ROAD.

Ivan W. Perry 8/23/92
IVAN W. PERRY
REGISTERED PROFESSIONAL SURVEYOR
NO. 563.

GF NO. 93A5207
REL. 20262

GLOBAL SURVEYORS, INC.
SURVEY PLAT OF
LOTS 284 AND 285
LAKESIDE VILLAGE SUBDIVISION, PHASE 2
JOHN DAVIS SURVEY, A-15
SAN JACINTO COUNTY, TEXAS
SCALE 1"=40 FT. 7-15-93