

Direct Appraisal Service
SKETCH ADDENDUM

File No. 15091201
 Case No. 512-2004319

Borrower Drew Pierce/Summer Pierce
 Property Address 11115 Gilmore Rd
 City Cleveland County Liberty State TX Zip Code 77328
 Lender/Client Pacific Union Financial Address 8900 Freeport Parkway, Suite 150, Irving, TX 75063

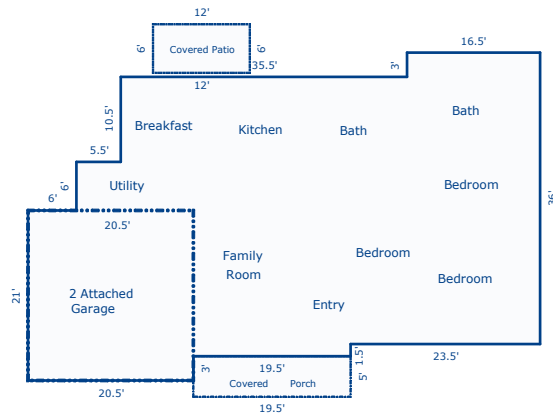

Sketch by Apex Sketch v5 Standard™

Comments:

AREA CALCULATIONS SUMMARY			
Code	Description	Net Size	Net Totals
GLA1	First Floor	1679.25	1679.25
GAR	Garage	430.50	430.50
P/P	Porch	97.50	
	Covered Patio	72.00	169.50
Net LIVABLE Area		(rounded)	1679

LIVING AREA BREAKDOWN			
Breakdown			Subtotals
First Floor			
3.0	x	20.5	61.50
6.0	x	57.5	345.00
16.5	x	63.5	1047.75
1.5	x	40.0	60.00
10.5	x	52.0	546.00
3.0	x	16.5	49.50
G			-
6 Items			(rounded)
Net LIVABLE Area			1679