

Fawn Forest (50' R/W) was accepted into the Montgomery County Road Maintenance System by Commissioner's Court minutes dated 8/19/1989

**TRACT 2**

12.5' utility easement

390.93'

**FAWN FOREST**

N 89°28'00" E 404.57'

4"x4" concrete monument at wood post

fld. 1/2" iron rod

**TRACT 1  
5.01 ACRES**

N 00°10'40" W 465.40'

**3**

metal barn & stalls

well hse

one story brick/frame residence

asphalt drive

231.4'

utility lines

S 16°00'11" E 480.63'

**BETHEL ROAD**

535.66'  
S 89°14'05" W

4"x4" concrete monument 2.5' S of fence line

4"x4" concrete monument at wood post

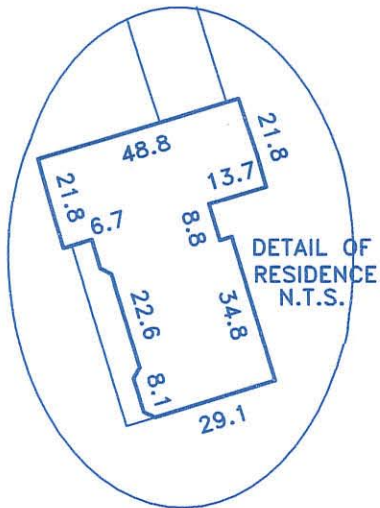

SCALE: 1"=100'



LAND TITLE SURVEY  
FOR: JOHN A. MCKENZIE  
15665 BETHEL ROAD  
MONTGOMERY, TEXAS 77356

TRACT ONE (1) OF FAWN FOREST SUBDIVISION, a subdivision in Montgomery County, Texas, according to the map or plat thereof recorded in Volume 7, Page 69 of the Map Records of Montgomery County, Texas.



First American Title Company  
G.F. No. 1545868- H043  
Effective date: 1/04/11

Covenants of Record:  
7/69 Map Records

Flood Zone: X FEMA Map No. 48339C 0160F

I hereby certify that this survey was made on the ground under my supervision and that this drawing correctly represents the facts found at the time of survey.

Date of Survey: 27 January 2011

Michael C. Warren  
Registered Professional Land Surveyor No. 4935

PROJECT NO.: 322911A