

**Legend:**

- x-x-x-x-x- Fence
- Lot
- - - - - Building Line
- - - - - Easement
- - - - - Drive/Walk/Patio
- ▬▬▬▬▬▬▬ Retaining Wall
- ▨ Pad Area
- ▩ Slab/Porch
- Drainage Direction

**Structural Options:**  
 1. Foundation: 3 Sides Brick.  
 2. Roofing: 8:12 Pitch  
 3. Covered Patio

**Lot Coverage Calculations:**

Lot Area	7409 Sq. Ft.
Slab Area	3118 Sq. Ft.
Coverage Ratio	42%

**Sod Calculation:**

Front	137 Sq.Yd.
Side	86 Sq.Yd.
Rear	225 Sq.Yd.
Total	448 Sq.Yd.

**Fence Calculation:**

Front	25 Ln.Ft.
Left	81 Ln.Ft.
Right	81 Ln.Ft.
Back	49 Ln.Ft.
Total	236 Ln.Ft.

**Flatwork Areas:**

Private Walk (A)	53 Sq. Ft.
Driveway (B)	399 Sq. Ft.
In-Turn (C)	186 Sq. Ft.
Public Walk (D)	244 Sq. Ft.
Conc. Patio (E)	0 Sq. Ft.
AC Pad	16 Sq. Ft.

**General Notes:**

- The purpose of this plan is to show the proposed building footprint as defined by the metes and bounds of the recorded plat.
- Dimensions, setbacks, easements, plan selection, and any other information shown here in shall be verified at permitting and prior to construction for accuracy and compliance with all applicable codes and ordinances.
- Builder is solely responsible for ensuring that the footprint is contained within the prepared building pad. The building pad shall be set high enough to allow for adequate drainage.
- All calculations are approximate. They must be verified prior to permitting, purchasing, and/or construction.
- This property lies outside of the 100-YR Floodplain as per FEMA FIRM, Map NO. 48339C0360G, Map dated August 18, 2014, LOMA Case NO. 07-06-2427A

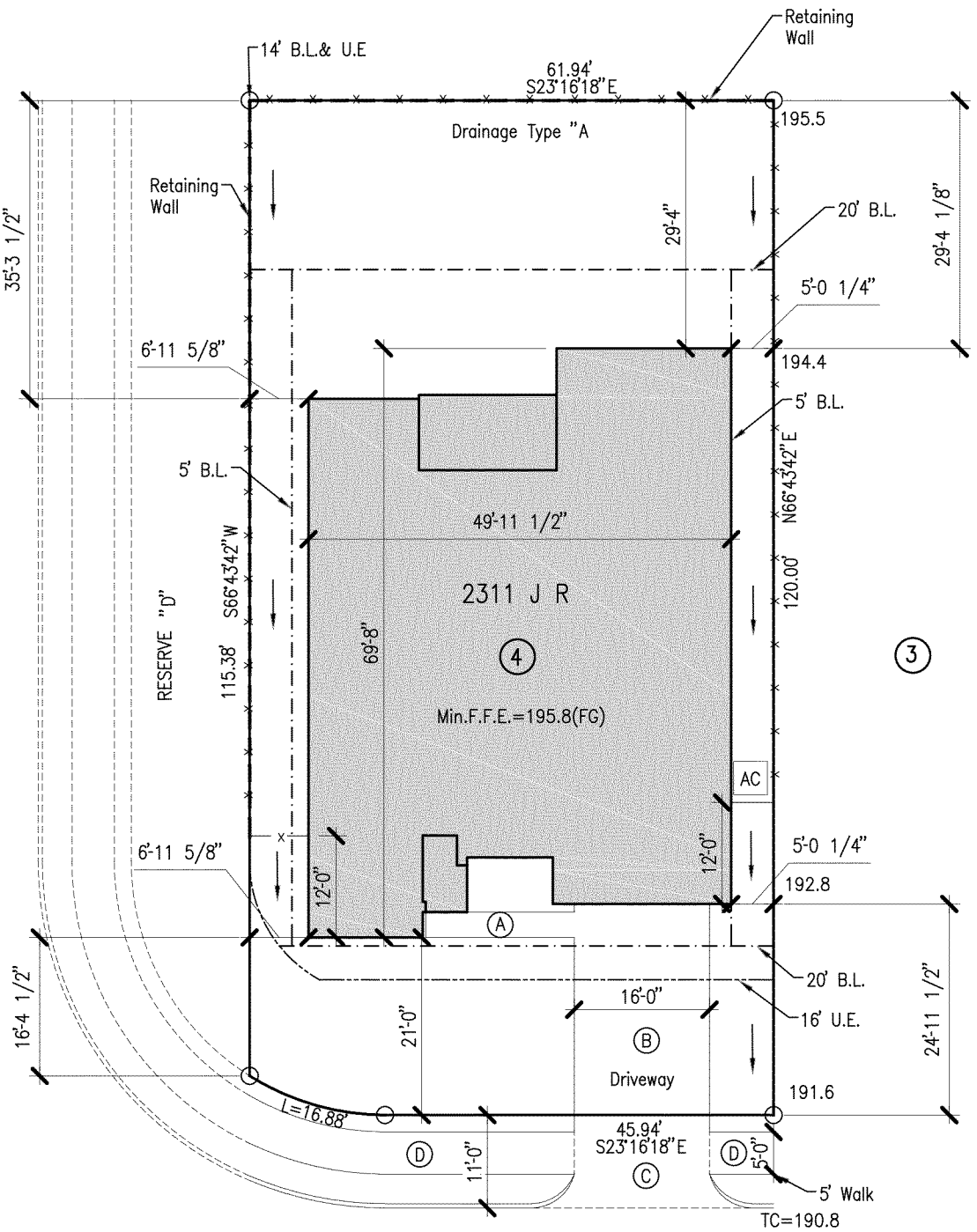

H:\House Plans\DR\_Horton\_Houston - North\Plot Plans\Hills of Westlake Section 2\2311 JR LOT 4 BLK 2 (2113329R2P1).dwg 4/7/2022 3:14:55 PM Audit#: 8509

<b>PL1</b>	DATE	4/07/22	BUILDER	DR Horton Houston North
	SCALE	1"=20'	SUBD.	Hills of Westlake Section 2
	DRN	KP	LOT	4 BLOCK 2
			ADDRESS	462 Westlake Landing
			CITY	Conroe, Texas
			PLAN	2311 J R

**PLOT PLAN**

VER. 2

  
 4/07/22

10003 Technology Blvd West  
 Dallas, TX 75220  
 972-620-8204  
 Registration No. F-1629

STRAND