

Pro-Surv

PO Box 1366
Friendswood, TX 77549
Ph. 281-996-1113
Fax 281-996-0112

Invoice

Date	Invoice #
5/19/2010	1005210

Ordered By
UNIVERSAL LAND TITLE - STEPHANIE
 1 SUGAR CREEK CENTER BULD. #650
 SUGAR LAND, TX 77478
 281-491-4191
 713-491-4199

Delivered To
UNIVERSAL LAND TITLE
 1 SUGAR CREEK CENTER BULD. #650
 SUGAR LAND, TX 77478
 281-491-4191
 281-491-4199

Closing Date	GF#
5/27/2010	72-11604

Item	Description	Amount
Residential Survey	1.9986 ACRES H & T, C. R.R. COMPANY SURVEY 14436 DOVE LANE	500.00T

Thank you for your business.	Subtotal	\$500.00
	Sales Tax (7.75%)	\$38.75
	Total	\$538.75

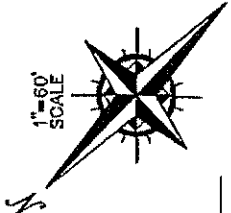

14436 DOVE LANE
30' ROAD ESMT.

P.O.B. S 44°52'10" E 229.30'

S 44°52'10" E 229.56'

379.66'

51.0'

56.3'

70.5'

229.30'

F.I.P. 1" 1/4

N 44°52'10" W

229.30'

F.I.P. 1" 1/4

S 45°10'22" E

379.66'

DEED BOOK: 2536

DEED PAGE: 2294

DEED BOOK: 2536

DEED PAGE: 2294

DEED BOOK: 2536

DEED PAGE: 2294

DEED BOOK: 2536

DEED PAGE: 2294

DEED BOOK: 2536

DEED PAGE: 2294

DEED BOOK: 2536

DEED PAGE: 2294

DEED BOOK: 2536

DEED PAGE: 2294

DEED BOOK: 2536

DEED PAGE: 2294

DEED BOOK: 2536

DEED PAGE: 2294

DEED BOOK: 2536

DEED PAGE: 2294

DEED BOOK: 2536

DEED PAGE: 2294

DEED BOOK: 2536

DEED PAGE: 2294

DEED BOOK: 2536

DEED PAGE: 2294

DEED BOOK: 2536

DEED PAGE: 2294

DEED BOOK: 2536

DEED PAGE: 2294

30' ROAD ESMT.

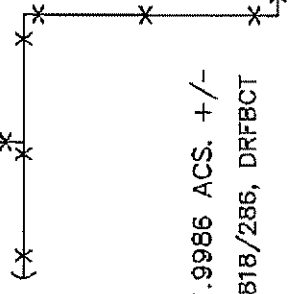
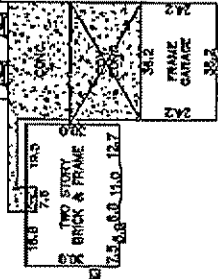
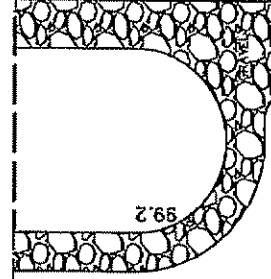

1.9986 ACS. +/-
818/286, DRFBCT

HURTA, LEE ROY
0224 H. AND TC RY,
ACRES 1.65

Reviewed & Accepted by: _____ Date: _____

BUYER
BRIAN PITTMANN
STACIE PITTMANN

PROPERTY ADDRESS
14436 DOVE LANE
NEEDVILLE, TEXAS 77461

LEGAL DESCRIBED PROPERTY

FIELD NOTES FOR A 1.9986 ACRE TRACT OF LAND OUT OF A CALLED 64.970 ACRE TRACT BEING THE ORIGINAL CALLED 65.00 ACRE TRACT (VOLUME 411, PAGE 41, FORT BEND COUNTY DEED RECORDS) IN THE H.&T.C.R.R. COMPANY SURVEY SECTION 39, ABSTRACT 224, FORT BEND COUNTY, TEXAS, AND BEING THAT SAME CERTAIN CALLED 2.00 ACRE TRACT OF LAND DESCRIBED IN DEED, JOE C. YELDERMAN AND HUGO F. LEY TO KEVON L. FUCHS ET UX, AS RECORDED IN VOLUME 818, PAGE 286, FORT BEND COUNTY DEED RECORDS, MORE PARTICULARLY DESCRIBED BY METES AND BOUNDS ATTACHED.

- NOTES:
- BEARING BASIS: PLAT
 - SUBJECT TO ANY AND ALL RECORDED AND UNRECORDED EASEMENTS
 - SURVEYOR HAS NOT INDEPENDENTLY ABSTRACTED PROPERTY IMPROVEMENTS, UTILITY INSTALLATIONS, UNDERGROUND STRUCTURES, FOUNDATIONS AND/OR OTHER UNDERGROUND IMPROVEMENTS WERE NOT LOCATED BY THIS SURVEY
 - THIS SURVEY IS CERTIFIED FOR THIS TRANSACTION ONLY, IT IS NOT TRANSFERABLE TO ADDITIONAL INSTITUTIONS OR SUBSEQUENT OWNERS
 - SUBJECT TO RESTRICTIVE COVENANTS AS PER TITLE COMMITMENT

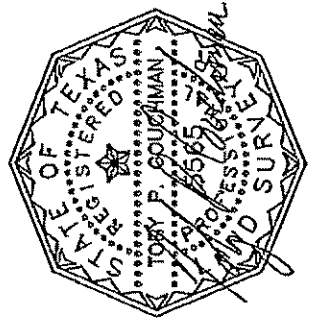

SUBJECT PROPERTY DOES NOT LIE IN A F.I.A. DESIGNATED FLOOD ZONE AS PER FLOOD MAP NO: 480228 0375 J 1-3-97 ZONE X

FLOOD INFORMATION IS BASED ON GRAPHIC PLOTTING ONLY DUE TO INHERENT INACCURACIES ON FEMA MAPS. WE DO NOT ASSUME RESPONSIBILITY FOR EXACT DETERMINATION.

© 2010 PRO-SURV SURVEYING COMPANY

INVOICE#	1005210	JOB#	1005210
C.F.#	72-11604	DATE	5-20-10

PRO-SURV

P.O. BOX 1966
FRIENDSWOOD, TX 77549
PHONE- 281-996-1113 Fax - 281-996-0112

FIELD WORK COMPLETED	_____
DRAFTING COMPLETED	_____
FINAL CHECK CALLED	_____

(TO SAME CERTAIN CASE)
CO. P. LEY TO KEVON L.
DEEDS, MORE P.

FIELD NOTES
OF A SURVEY OF

A tract of land containing 1.9986 acres, more or less, out of a called 64.970 acre tract being the original called 65 acre tract (Volume 411, Page 41, D.R.F.B.C.T.) in the H. & T. C. R.R. Company Survey, Section 39, Abstract 224, Fort Bend County, Texas, and being that same certain called 2.00 acre tract of land described in Deed recorded in Volume 818, Page 286, D.R.F.B.C.T., and being more particularly described by metes and bounds as follows:

COMMENCING at the point of intersection of the centerline of State Highway 36 with the centerline of Colony Road, said point being the common corner of the H. & T. C. R.R. Company Survey, Sections 35, 36, 39 and 40;

THENCE South 45°00'00" West, along the centerline of Colony Road, at a distance of 2330.00 feet pass the North corner of said called 64.970 acre tract, and continue for a total distance of 3022.50 feet to a point;

THENCE South 44°52'10" East, at a distance of 40.00 feet pass the Southeast right-of-way line of Colony Road, and continue for a total distance of 229.56 feet to the North corner and POINT OF BEGINNING of the herein described tract, in the centerline of Dove Lane;

THENCE South 44°52'10" East, along the centerline of said Dove Lane, a distance of 229.30 feet to the East corner of the herein described tract;

THENCE South 45°10'22" West, at a distance of 30.00 feet pass a 1 inch iron pipe found for reference and continue for a total distance of 379.66 feet to a 1 inch iron pipe found marking the South corner of the herein described tract;

THENCE North 44°52'10" West, a distance of 229.30 feet to a 1 inch iron pipe found marking the West corner of the herein described tract;

THENCE North 45°10'22" East, at a distance of 349.66 feet pass a ½ inch iron rod set for reference and continue for a total distance of 1.9986 acres of land, more or less.

