

FEATURES AND IMPROVEMENTS

16714 CREEKLEA RD

New 30 Year Roof with Transferable Warranty	September 2022
New Dishwasher	October 2022
Gutters on Home	front 2022, rear 2016
Added Engineered Vinyl Plank Flooring in Utility Room	September 2022
Electric Driveway Gate	2021
Storage Shed	2021
Front Porch and Walkway	2021
New Asphalt Driveway	2016
Extra Additional Drive extension and Sealed Main driveway	2021
Backyard Sidewalk and Firepit area	2019
Hall Bathroom Redo, counters, lighting, flooring, tub/shower	2018
Aerobic Septic System Installed	2018
Double Pane Windows with Lifetime Transferrable warranty Installed	
By Window World	2018
Carpet Replaced in 2 bedrooms	2016
Replaced Both Waters Heaters	one in 2017, One in 2020

ADDITIONAL FEATURES AND IMPROVEMENTS

Real Hardwood Floors that can be sanded and stained Not engineered

**Kitchen Features Five Burner Gas Cooktop, Granite Counters and Tumbled
Marble Backsplash, Under Cabinet Lighting**

Travertine Floors in Kitchen and Game room

**Master Bath Complete Redo, New Shower with dual Shower Heads, Counters,
Cabinets, Lighting, Flooring**

Samsung Counter Depth Refrigerator to Stay

Replaced Electric Panel with GE Box

Patterned and Stained Concrete Patio plus Added Pergola

Three Car Oversized Garage

Tons of Vehicle Parking

Landscaped Gardens

No Backyard Neighbors

Loads of Beautiful Mature Trees

Original House Plans Left for the Buyers

NEVER FLOODED

**Bammel Forest was established originally for the cultivation of Pecans and Sugar
Cane in early 1900's and is named for the German Houstonian founder Charles
Bammel. He built the first merchandise store and post office in 1915.**

Today Bammel Forest has a Civic Association with deed restrictions.

**Bammel Forest features oversized lots nestled just minutes from major
intersections, downtown and IAH airport.**

SKETCH ADDENDUM

Intended User _____
 Property Address 16714 Creeklea Rd
 City Houston County Harris State TX Zip Code 77068
 Client _____

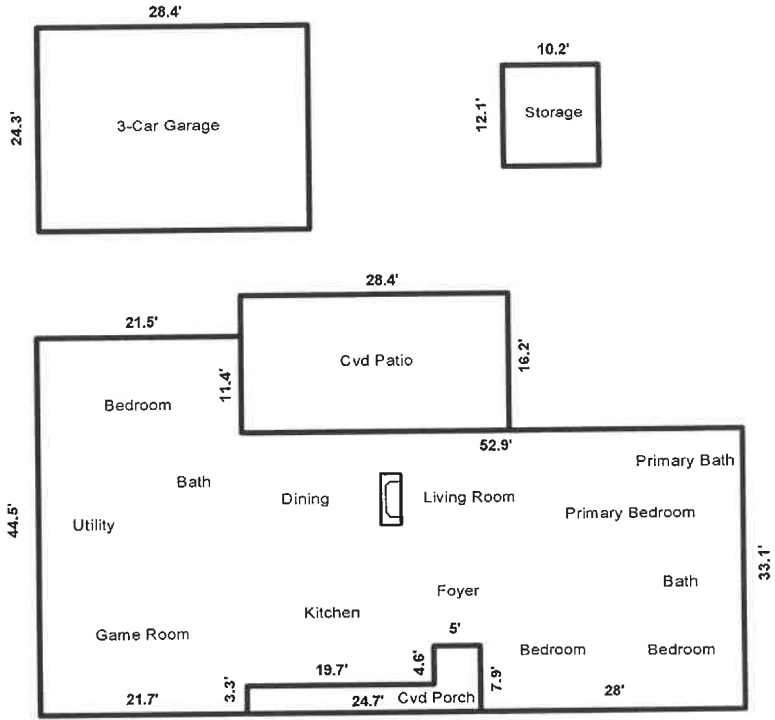

SUMMARY	SQ FT AREA	PERIMETER	AREA CALCULATION DETAILS
Living Area First Floor	2603	254	First Floor 21.5 X 44.5 = 956.7 52.9 X 25.2 = 1333.0 19.9 X 4.6 = 91.5 28.0 X 7.9 = 221.2 0.2 X 3.3 = 0.6 Total 2603.0
Porch Porch	105	65	
Other Garage Storage	690 123	105 45	
Porches/Patios Patio	460	89	