

LOT 12

LOT 14

12910
SOUTHERN OAKS LANDING
(50' R.O.W.)

NOTES:

1. BASIS OF BEARING: SOUTH SUBMISSION LINE BEING "S86°43'54\"W".
2. SUBJECT TO APPLICABLE RESTRICTIVE COVENANTS LISTED IN ITEM No. 10-A, SCHEDULE "B" OF TITLE COMMITMENT ISSUED BY FIRST AMERICAN TITLE INSURANCE Co. UNDER G.F. No. 2217440-27.
3. AGREEMENT FOR UNDERGROUND ELECTRIC SERVICE PER C.F. No. 2015034537.
4. SHORT FORM BLANKET EASEMENT PER C.F. No. 2016015887.
5. ALL ELEVATIONS SHOWN HEREON ARE BASED ON ASSUMED DATUM.

PLAT OF SURVEY
SCALE: 1" = 20'

FLOOD MAP:

THIS PROPERTY LIES IN ZONE "X" AS DEPICTED ON COMMUNITY PANEL No. 48039 C 0020 H, DATED: 06-05-89
THIS INFORMATION IS BASED ON GRAPHIC PLOTTING. WE DO NOT ASSUME RESPONSIBILITY FOR EXACT DETERMINATION"

© 2016, ALLPOINTS SERVICES, CORP., All Rights Reserved. This original work is protected under copyrights laws, Title 17 U.S. Code Sections 101 & 102. All violators will be prosecuted to the extent of the law. This survey is being provided solely for the use of the recipients and no license has been created, express or implied, to copy the survey except as is necessary in conjunction with the original transaction, which shall take place within ninety (90) days from the date adjacent to the signature line herein.

FOR: BRITTANY G. TURNER
ADDRESS: 12910 SOUTHERN OAKS LANDING
BEAZER JOB # 15021-1213
ALLPOINTS JOB #: BHI112877 MC
G.F.: 2217440-27



LOT 13, BLOCK 2,
SOUTHERN OAKS,
DOC. No. 2016005932, OFFICIAL RECORDS,
BRAZORIA COUNTY, TEXAS

I HEREBY CERTIFY THAT THIS PLAT REPRESENTS THE RESULTS OF A SURVEY MADE ON THE GROUND, ON THE 14TH DAY OF OCTOBER, 2016.

Steven P. Brister

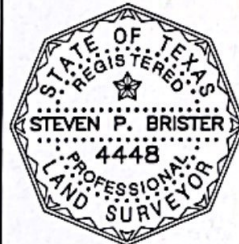

ALLPOINTS SERVICES CORP. COMMERCIAL/BUILDER DIVISION 1515 WITTE ROAD HOUSTON, TEXAS 77080