

# 11102 Wickwood Drive

## SITE PLAN

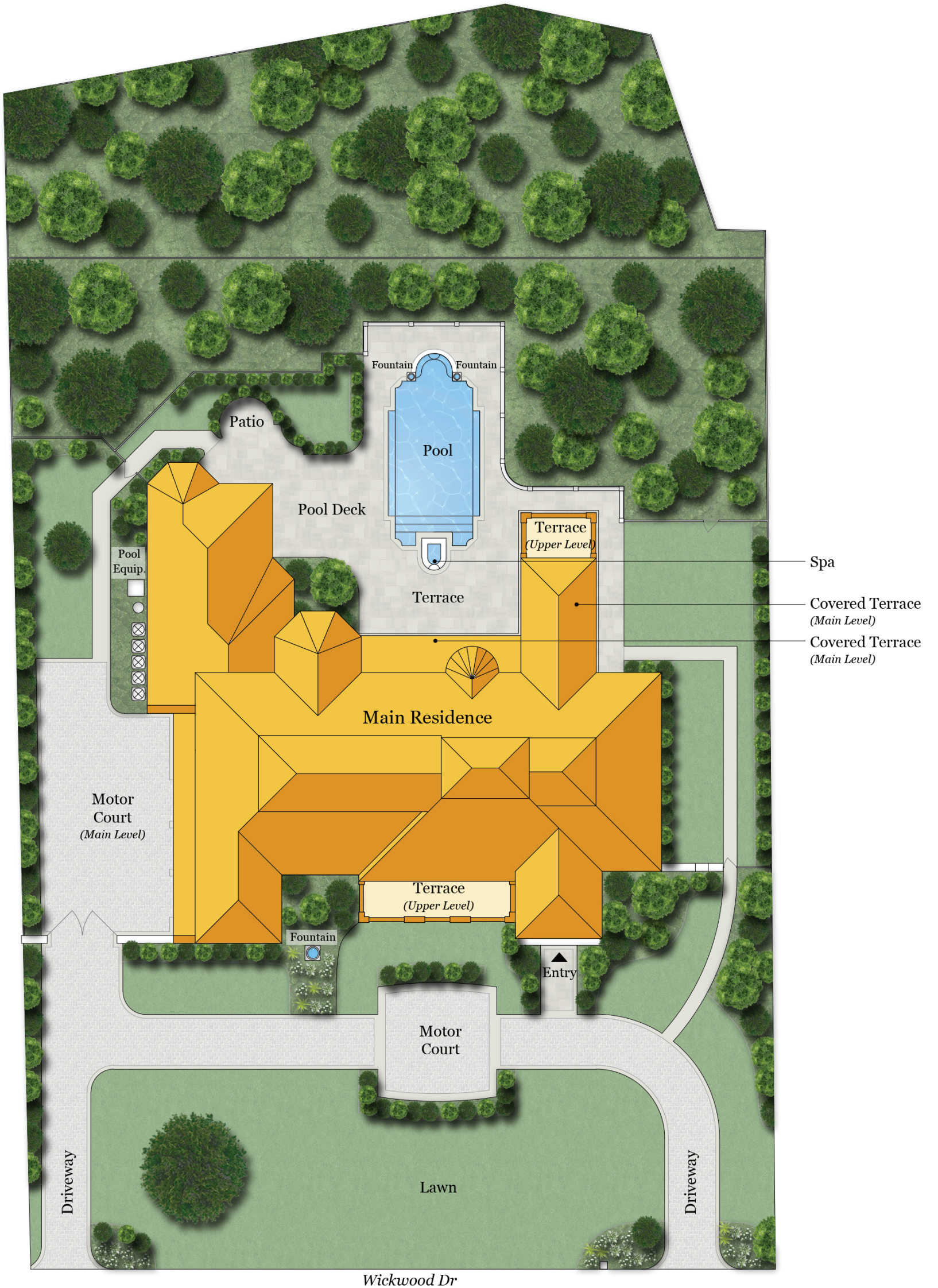

Walter Bering 713.851.9753  
Broker Associate walter.bering@sothebys.realty

Martha Turner | Sotheby's  
INTERNATIONAL REALTY

If your property is listed with a real estate broker, please disregard. It is not our intention to solicit the offerings of other real estate brokers. We are happy to work with them and cooperate fully. This material is based upon information which we consider reliable but because it has been supplied by third parties, we cannot represent that it is accurate or complete and it should not be relied upon as such. This offering is subject to errors, omissions, changes including price or withdrawal without notice. Sotheby's International Realty and the Sotheby's International Realty logo are registered (or unregistered) service marks used with permission. Operated by Sotheby's International Realty, Inc. © MMXIII Sotheby's International Realty, Inc. All Rights Reserved. An Equal Opportunity Company. Equal Housing Company.

# 11102 Wickwood Drive



## Total Finished Square Footage: 10,542 SQ FT

Above-Grade: 10,542 SQ FT Below-Grade: N/A  
Plus 894 SQ FT 2-Car Garage on Main Level  
Calculated per ANSI Standard Z765-2003.

\* Total Finished & Unfinished Square Footage: 11,436 SQ FT

**MAIN LEVEL**  
5,597 SQ FT



Walter Bering 713.851.9753  
Broker Associate walter.bering@sothebys.realty

Martha Turner | Sotheby's  
INTERNATIONAL REALTY

If your property is listed with a real estate broker, please disregard. It is not our intention to solicit the offerings of other real estate brokers. We are happy to work with them and cooperate fully. This material is based upon information which we consider reliable but because it has been supplied by third parties, we cannot represent that it is accurate or complete and it should not be relied upon as such. This offering is subject to errors, omissions, changes including price or withdrawal without notice. Sotheby's International Realty and the Sotheby's International Realty logo are registered (or unregistered) service marks used with permission. Operated by Sotheby's International Realty, Inc. © MMXIII Sotheby's International Realty, Inc. All Rights Reserved. An Equal Opportunity Company. Equal Housing Company.

# 11102 Wickwood Drive



**UPPER LEVEL**  
4,945 SQ FT



Walter Bering 713.851.9753  
Broker Associate walter.bering@sothebys.realty

Martha Turner | Sotheby's  
INTERNATIONAL REALTY

If your property is listed with a real estate broker, please disregard. It is not our intention to solicit the offerings of other real estate brokers. We are happy to work with them and cooperate fully. This material is based upon information which we consider reliable but because it has been supplied by third parties, we cannot represent that it is accurate or complete and it should not be relied upon as such. This offering is subject to errors, omissions, changes including price or withdrawal without notice. Sotheby's International Realty and the Sotheby's International Realty logo are registered (or unregistered) service marks used with permission. Operated by Sotheby's International Realty, Inc. © MMXIII Sotheby's International Realty, Inc. All Rights Reserved. An Equal Opportunity Company. Equal Housing Company.