

Building Sketch

Borrower				
Property Address 3 Cottage Grove Pl				
City	Spring	County	Montgomery	State TX Zip Code 77381
Lender/Client				

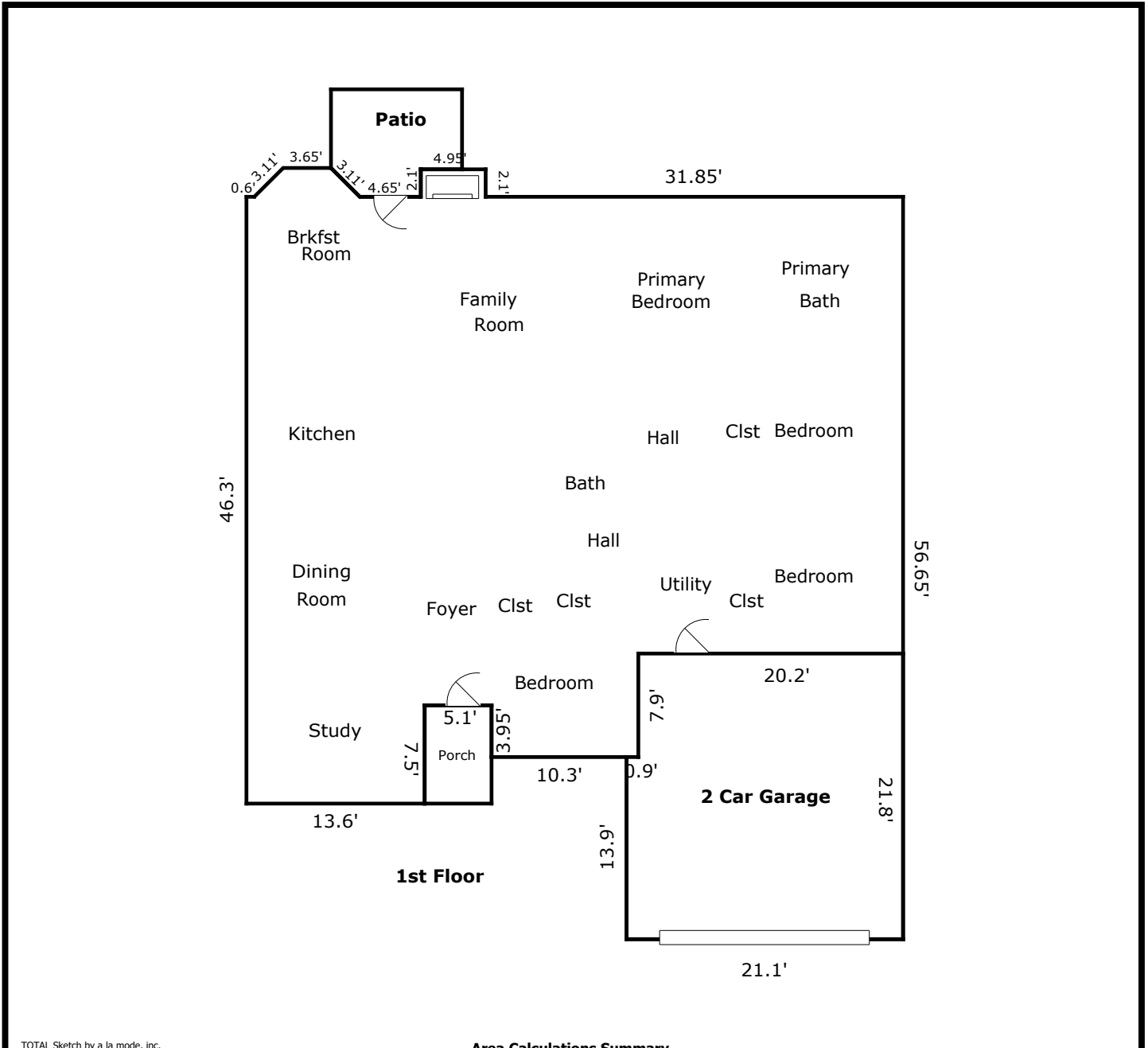

TOTAL Sketch by a la mode, inc.

Area Calculations Summary

Living Area	Area	Calculation Details
2 Car Garage	-452.87 Sq ft	$21.8 \times 20.2 = 440.36$ $13.9 \times 0.9 = 12.51$
1st Floor	2486.47 Sq ft	$0.5 \times 2.2 \times 2.2 = 2.42$ $0.5 \times 2.2 \times 2.2 = 2.42$ $3.65 \times 2.2 = 8.03$ $4.95 \times 2.1 = 10.4$ $50.1 \times 38.8 = 1943.88$ $7.5 \times 13.6 = 102$ $17.85 \times 21.1 = 376.64$ $3.95 \times 10.3 = 40.68$
Total Living Area (Rounded):	2034 Sq ft	
Non-living Area		
Patio	72.96 Sq ft	$10 \times 6 = 60$ $0.1 \times 3.15 = 0.32$ $2.2 \times 4.65 = 10.23$ $0.5 \times 2.2 \times 2.2 = 2.42$
Porch	38.25 Sq ft	$7.5 \times 5.1 = 38.25$