

third floor plan

SCALE: 1/4" = 1'-0"
(10'-0" ceiling)

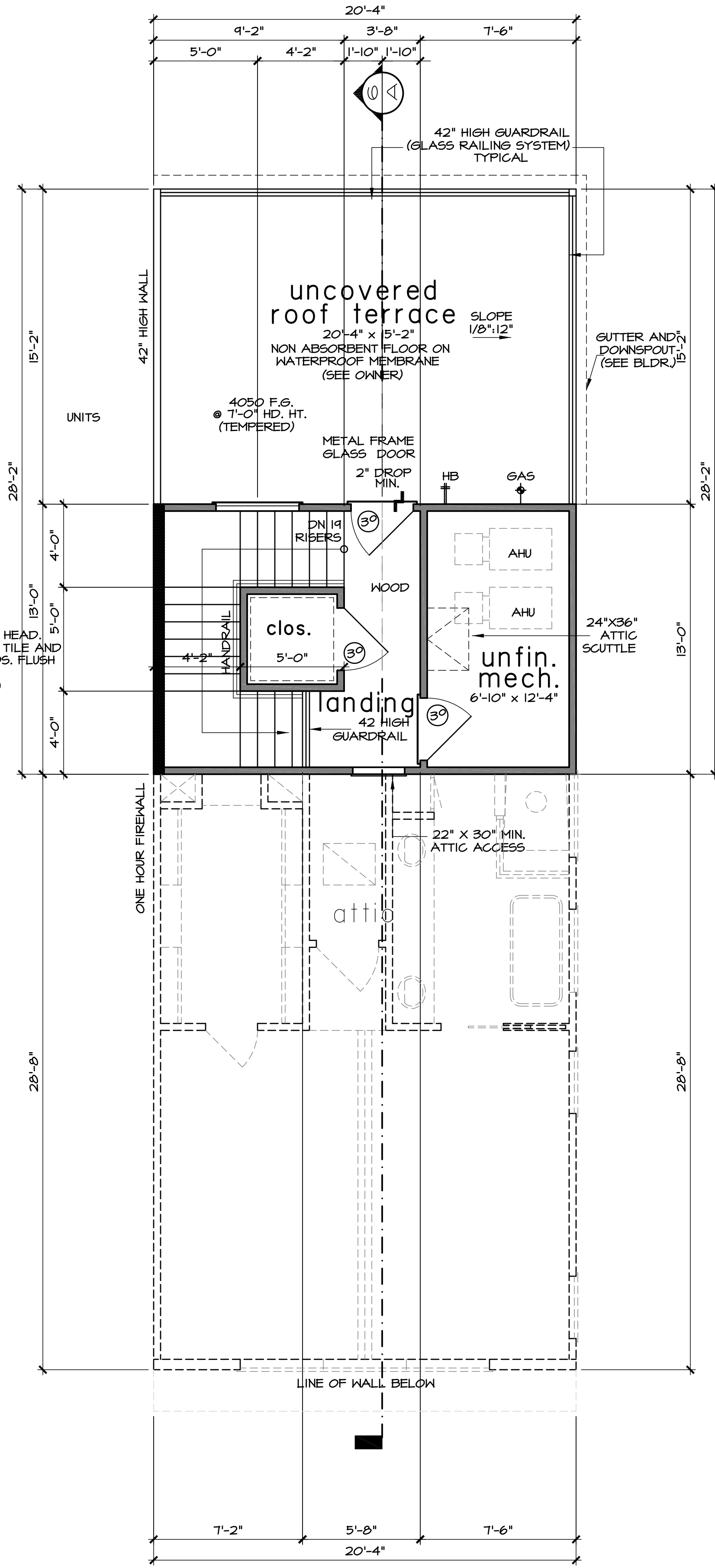

mechanical / roof terrace floor plan

SCALE: 1/4" = 1'-0"
(8'-0" ceiling)

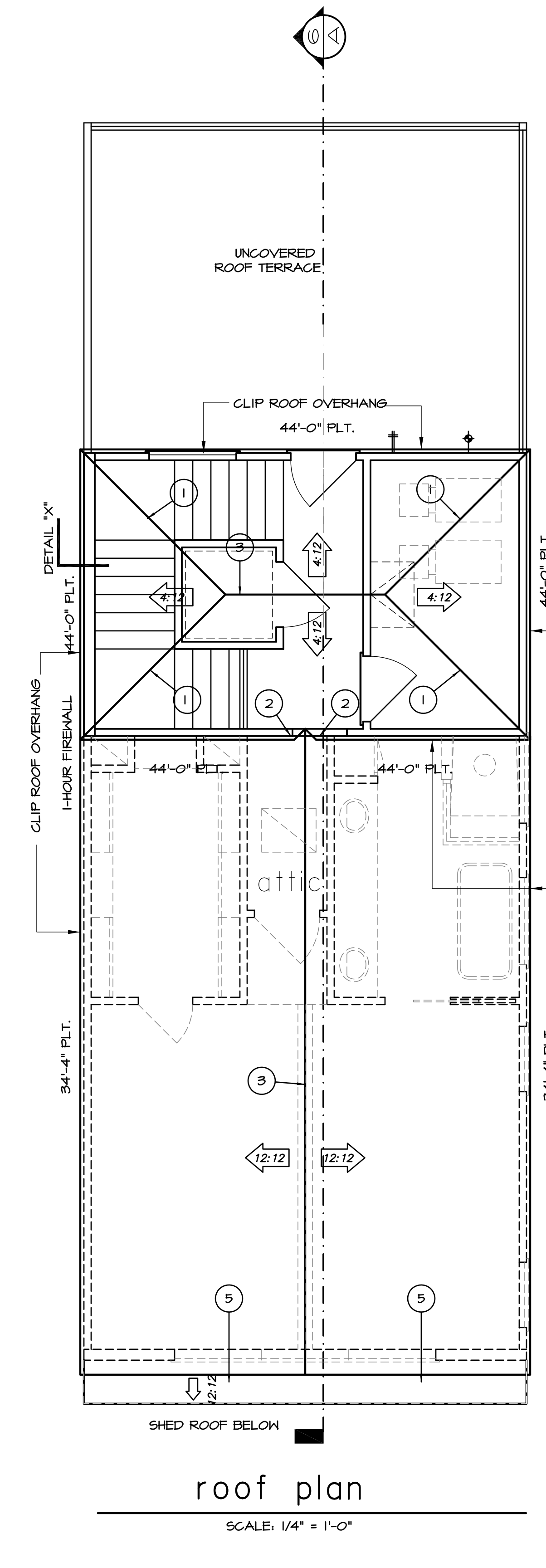

roof plan

SCALE: 1/4" = 1'-0"

roof notes

- CRICKETS SHALL BE APPLIED TO ROOF DECKING.
- ROOF PITCHES AS INDICATED HEREON.
- DOUBLE FRAMING AROUND CHIMNEYS, DORMERS, SKYLITS, AND ANY MAJOR ROOF OPENINGS.
- OUTLOOKERS TO BE 2x4 AT 16" O.C.
- RAKES TO BE 8" UNLESS OTHERWISE NOTED.
- FASCIAS AND RAKE BOARDS TO BE 1x6.
- ATTIC VENTILATION CALCULATIONS SHALL BE PROVIDED BY HVAC CONTRACTOR AND SHALL COMPLY WITH CODE REQUIREMENTS R 806 AND OTHER RELATED SECTIONS.

SULLIVAN HENRY OGGERO & ASSOC., INC. IS A PROFESSIONAL BUILDING DESIGN FIRM. IT IS NOT AN ENGINEERING FIRM. WE ARE NOT QUALIFIED TO NOR LICENSED TO DESIGN STRUCTURAL FRAMING OR FOUNDATIONS. A LICENSED PROFESSIONAL ENGINEER SHOULD BE CONSULTED REGARDING THE FRAMING AND FOUNDATION. SHOULD AN ENGINEER'S SEAL BE PRESENT ON THESE DRAWINGS, THE ENGINEER OF RECORD SHALL BEAR THE RESPONSIBILITY FOR THE STRUCTURAL DESIGN. SULLIVAN HENRY OGGERO & ASSOC., INC. WILL NOT BE HELD RESPONSIBLE FOR THE STRUCTURAL DESIGN IN ANY WAY AND/OR ANY PROBLEMS WHICH MAY ARISE.

- 1 HIP
2 VALLEY
3 RIDGE
4 PURLIN
5 OUTLOOKERS
6 CRICKET
7 KICKOUTS
8 ROOF TRANSITION LINE

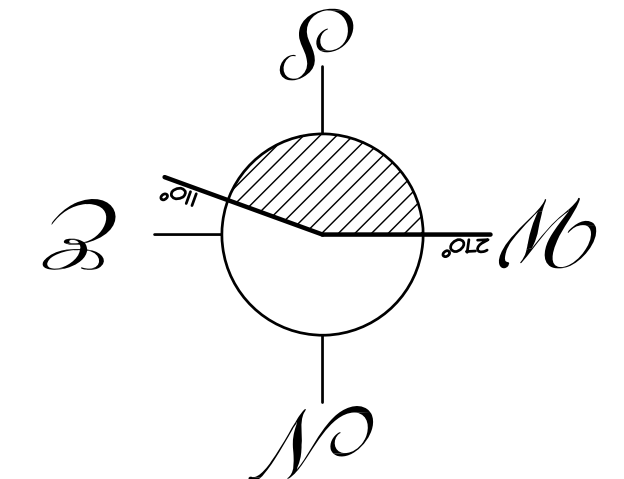

NOTE: THERE IS NOT A SINGLE ROOF SURFACE THAT CONTAINS THE REQUIRED 600 SQ.FT. FOR SOLAR READY PLANNING, WHICH FALLS W/ I10 AND 270 DEGREES

legend:

- 2x4 STUD WALLS
2x6 STUD WALLS

notes:

THE STRUCTURAL DESIGN OF THE STAIRS INCLUDING LOAD CARRYING CAPABILITY, STABILITY, STRENGTH AND CONNECTIONS TO SUPPORT MEMBERS, ARE THE RESPONSIBILITY OF THE GENERAL CONTRACTOR AND THE FRAMING CONTRACTOR. THE STRUCTURAL DESIGN HAS NOT BEEN REVIEWED BY THE STRUCTURAL ENGINEER OF RECORD OR SULLIVAN HENRY OGGERO & ASSOC., INC.

NOTE: LOCATE ADDITIONAL DUCT CHASE TO 1ST. FLOOR AS REQUIRED. COORDINATE WITH H.V.A.C. CONTRACTOR, AND TO BE APPROVED BY OWNER/BLDR.

PERMIT SET

plan B-L
third and mechanical /
roof terrace floor/roof plans
SCALE: 1/4" = 1'-0"