

**PROPERTY DESCRIPTION LOT 8A**

Block 1, 0.184 acres (0.4423 acres less) tract of land situated in Montgomery County, Texas, located in the Madison C. Clark Survey, Abstract No. 8 and being part of and out of a ceded parcel of land being particularly described by reference to the M.C.R.P.N. 2008-057808, which bears South 079727' West a distance of 0.70 feet.

TRACED, South 079727' West, a distance of 37.05 feet along the south line of said 2.274 acre tract to the northeast corner of the parcel described herein from the intersection of which bears South 079727' West a distance of 0.40 feet.

TRACED, South 079727' West, a distance of 222.16 feet to a 5/8 inch line of Diamond Head North Road (bearing north) and one bearing the southeast corner of the herein described tract.

TRACED, North 861702' West, a distance of 37.54 feet to the POINT OF BEGINNING of the herein described tract and containing 0.194 acres (0.4423 acres less) of land.

**PROPERTY DESCRIPTION LOT 8B**

Block 1, 0.184 acres (0.4423 acres less) tract of land situated in Montgomery County, Texas, located in the Madison C. Clark Survey, Abstract No. 8 and being part of and out of a ceded parcel of land being particularly described by reference to the M.C.R.P.N. 2008-057808, which bears South 079727' West a distance of 0.70 feet.

TRACED, South 079727' West, a distance of 37.05 feet along the south line of said 2.274 acre tract to the northeast corner of the parcel described herein from the intersection of which bears South 079727' West a distance of 0.40 feet.

TRACED, South 079727' West, a distance of 222.16 feet to a 5/8 inch line of Diamond Head North Road (bearing north) and one bearing the southeast corner of the herein described tract.

TRACED, North 861702' West, with the east authority (64' of every foot of Diamond Head North Road (bearing north) a distance of 37.54 feet to a set 5/8 inch iron nail with RODS CAP.

TRACED, South 079727' West, a distance of 37.05 feet along the south line of said 2.274 acre tract to the northeast corner of the parcel described herein from the intersection of which bears South 079727' West a distance of 0.70 feet.

TRACED, South 079727' West, with the eastern line of said Lot 8 Block 1 Water Oak Section 2 and the westerly line of said 2.274 acre a distance of 37.05 feet from which a copy of the plat of said 2.274 acre tract is on file in the Public Office of Montgomery County, Texas, from which a copy not set on file.

TRACED, South 079727' West, with the eastern line of said Lot 8 Block 1 Water Oak Section 2 and the westerly line of said 2.274 acre a distance of 37.05 feet from which a copy of the plat of said 2.274 acre tract is on file in the Public Office of Montgomery County, Texas, from which a copy not set on file.

TRACED, South 079727' West, with the eastern line of said Lot 8 Block 1 Water Oak Section 2 and the westerly line of said 2.274 acre a distance of 37.05 feet from which a copy of the plat of said 2.274 acre tract is on file in the Public Office of Montgomery County, Texas, from which a copy not set on file.

TRACED, South 079727' West, with the eastern line of said Lot 8 Block 1 Water Oak Section 2 and the westerly line of said 2.274 acre a distance of 37.05 feet from which a copy of the plat of said 2.274 acre tract is on file in the Public Office of Montgomery County, Texas, from which a copy not set on file.

TRACED, South 079727' West, with the eastern line of said Lot 8 Block 1 Water Oak Section 2 and the westerly line of said 2.274 acre a distance of 37.05 feet from which a copy of the plat of said 2.274 acre tract is on file in the Public Office of Montgomery County, Texas, from which a copy not set on file.

TRACED, South 079727' West, with the eastern line of said Lot 8 Block 1 Water Oak Section 2 and the westerly line of said 2.274 acre a distance of 37.05 feet from which a copy of the plat of said 2.274 acre tract is on file in the Public Office of Montgomery County, Texas, from which a copy not set on file.

TRACED, South 079727' West, with the eastern line of said Lot 8 Block 1 Water Oak Section 2 and the westerly line of said 2.274 acre a distance of 37.05 feet from which a copy of the plat of said 2.274 acre tract is on file in the Public Office of Montgomery County, Texas, from which a copy not set on file.

TRACED, South 079727' West, with the eastern line of said Lot 8 Block 1 Water Oak Section 2 and the westerly line of said 2.274 acre a distance of 37.05 feet from which a copy of the plat of said 2.274 acre tract is on file in the Public Office of Montgomery County, Texas, from which a copy not set on file.

**WILLIAM C. CLARK SURVEY, ABSTRACT No. 6**  
MONTGOMERY COUNTY, TEXAS

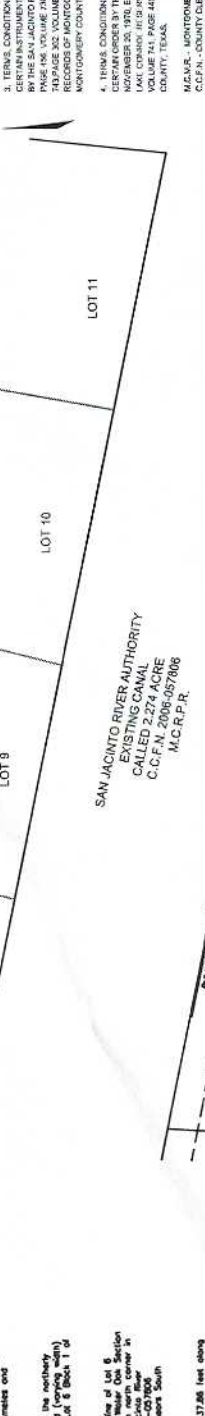
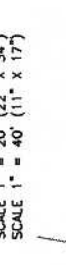

**WATER OAK SECTION TWO**  
**CABINET 2, SHT 492.**  
**2011-06245906**  
**M.C.M.R.**

San Jacinto River Authority  
EXISTING CANAL  
CALLED 2,274 ACRE  
C.C.F.N. 2008-057808  
M.C.R.P.N.

LOT 5  
0.194 Acres  
8462 Sq. Feet  
VACANT

LOT 6A  
0.188 Acres  
8200 Sq. Feet  
VACANT

LOT 6B  
0.188 Acres  
8200 Sq. Feet  
VACANT

LOT 7  
12.83 Acres  
26,892 Acres Tract Described in R.P.M.C. File No. 2008288

LOT 8  
15 U.E. C.C.F.N. 2004-518657  
26,892 Acres Tract Described in R.P.M.C. File No. 2008288

SHOWN TO BE IN DIS  
1. ALL BEARINGS ARE BASED ON THE PLAT OF WATER OAK SECTION TWO AS RECORDED IN CABINET 2, SHEET 492, FILE NO. 2011-06245906 M.C.M.R.

2. THIS SURVEY WAS PREPARED WITHOUT BENEFIT OF A CURRENT TITLE COMMITMENT.

3. TERMS, CONDITIONS AND SPECIFICATIONS CONTAINED IN THESE CERTAIN INSTRUMENTS PERTAINING TO FLOWAGE RIGHTS PRESENTED BY THE SAN JACINTO RIVER AUTHORITY AS SET OUT IN VOLUME 750 OF THE PUBLIC OFFICE OF MONTGOMERY COUNTY, TEXAS, AND IN VOLUME 743, PAGE 114 AND 141, PAGE 51 OF THE DEED RECORDS OF MONTGOMERY COUNTY, TEXAS AND UNDER MONTGOMERY COUNTY CLERK'S FILE NOS. 2008058331.

4. TERMS, CONDITIONS AND SPECIFICATIONS CONTAINED IN THAT CERTAIN ORDER BY THE TEXAS WATER QUALITY BOARD, DATED NOVEMBER 20, 1978, ESTABLISHING A WATER QUALITY ZONE AROUND THE SAN JACINTO RIVER AND IN VOLUME 743, PAGE 51 OF THE DEED RECORDS OF MONTGOMERY COUNTY, TEXAS.

M.C.M.S. - MONTGOMERY COUNTY MAP RECORDS  
C.C.F.N. - COUNTY CLERK'S FILE NUMBER  
M.C.R.P.N. - MONTGOMERY COUNTY REAL PROPERTY RECORDS  
B.L. - BUILDING LINE

**SURVEY MAP**  
0.382 ACRE LOTS  
10.184 AC LOT 6A, 8.188 AC LOT 6B  
IN BLOCK 1, WATER OAK SECTION TWO  
MONTGOMERY COUNTY, TEXAS

I hereby certify that this survey was made on the ground, that the plat correctly represents the facts on the ground and that the boundaries shown on this plat are in accordance with the Survey Standards and Specifications for a Category 1A, Class 1 Survey.

**J.A. O'Connell**  
SURVEYOR  
MONTGOMERY COUNTY, TEXAS  
FEBRUARY 12, 2013

**RODS SURVIVAL**  
SERVING THE SURVEYING INDUSTRY SINCE 1957

REVISION	DATE	INITIALS

DIAMOND HEAD NORTH RD.  
R.O.W. VARIES