

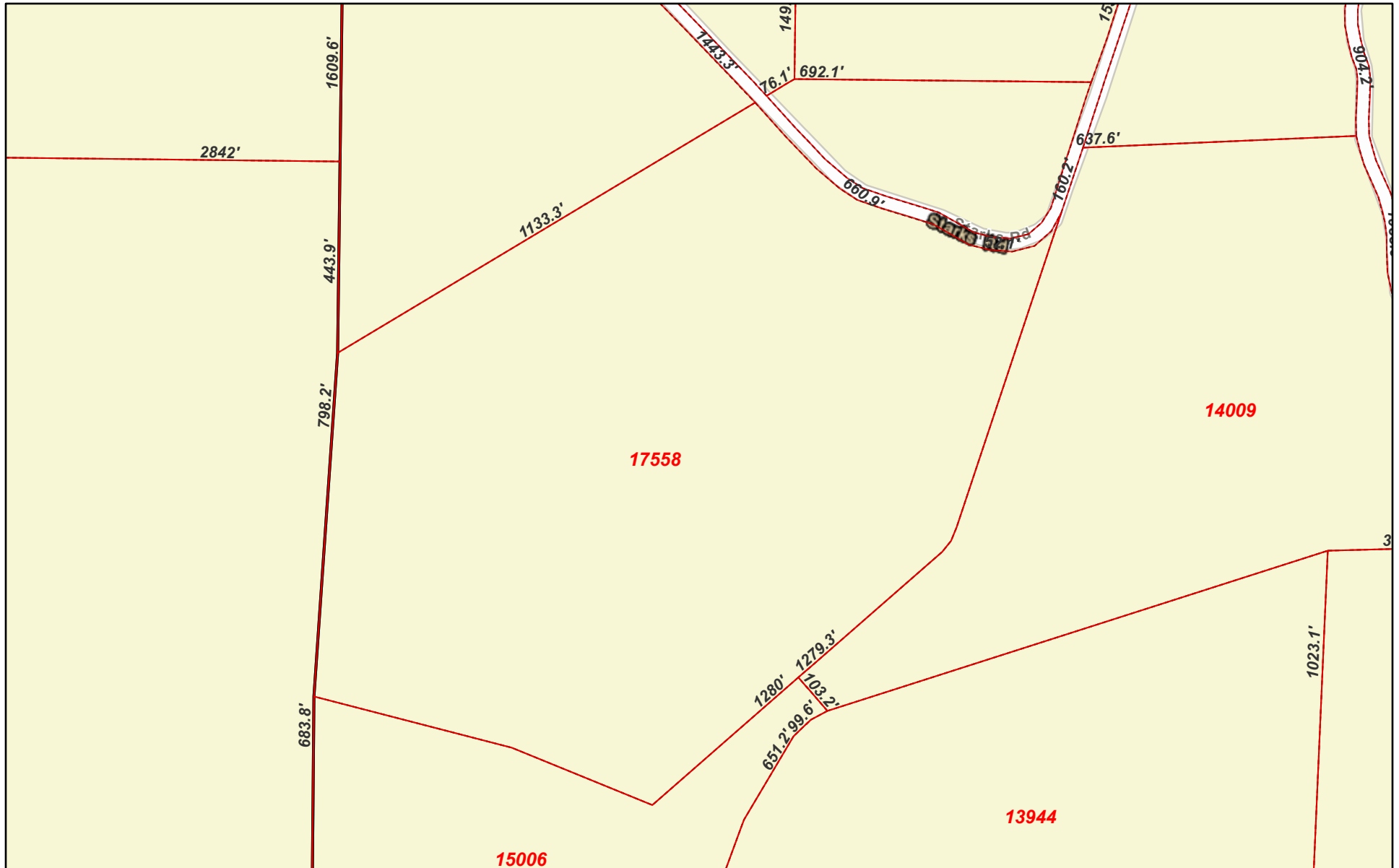



Mason CAD Web Map



11/17/2022, 10:20:44 AM

-  Abstracts
 -  Parcels
 -  Lot Lines
 -  School Districts
- World Transportation

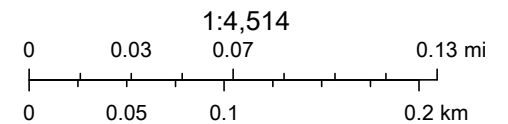

Esri, HERE, GeoTechnologies, Inc., Esri Community Maps Contributors, Texas Parks & Wildlife, © OpenStreetMap, Microsoft, CONANP, Esri, HERE,

Mason Central Appraisal District, BIS Consulting - www.bisconsulting.com

Disclaimer: This product is for informational purposes only and has not been prepared for or be suitable for legal, engineering, or surveying purposes. It does not represent an on-the-ground survey and represents only the approximate relative location of boundaries.