

MACK R. HARVEY &  
DEBORAH M. HARVEY  
(A.K.A. TRACT 151)  
(CF NO. 20090198789)

MICHAEL WAYNE REGISTER  
0.29 ACRE TRACT  
(A.K.A. TRACT 150)  
(CF NO. U165457)

FND. 1/2" PIPE

FND. 1/2" PIPE

WATERFALL DR.  
(60' R.O.W.)

EDGE OF PVMT.

N 00°55'45" W

(CALC'D BEARING BASIS)  
S 00°32'30" E 116.62'

CM 1/2" I.R.

FND. 1" I.P. BEARS  
S 60°52'06" E 0.70'

THECIA N. KIRKWOOD  
0.29 ACRE TRACT  
(A.K.A. TRACT 203)  
(CF NO. R741825)

THECIA N. KIRKWOOD  
0.29 ACRE TRACT  
(A.K.A. TRACT 204)  
(CF NO. R741824)

THECIA NICOLE KIRKWOOD  
(A.K.A. N. 1/2 OF LOT 205)  
(DESCRIBED IN CF NO. R741826)

0.1375 ACRE TRACT  
(A.K.A. S. 1/2 OF LOT 205)  
(CF NO. R741827)  
5988 SQ. FT.

RANDOLPH H. SMITH &  
MEGAN R. ESSENEMACHER  
0.6547 ACRE TRACT  
(A.K.A. TRACTS 206 & 207)  
(CF NO. 20150474157)

HAYARD RD.

FND. 3/4" I.P. BEARS  
N 71°38'45" E 0.68'

JM120 REGENCY TRUST  
(TRACT 198)  
(DESCRIBED IN CF NO. T220129)

MARK CRAIGHEAD  
(TRACT 197)  
CF NO. 20130162115

MARK CRAIGHEAD  
(TRACT 196)  
CF NO. 20130162115

**LEGEND**

These standard symbols will be found in the drawing.

- BOUNDARY LINE
- EASEMENT LINE
- BUILDING SETBACK LINE
- SET 1/2" IRON ROD WITH CAP
- PROPERTY CORNER
- FOUND IRON ROD
- FOUND METAL PIPE
- POWER POLE
- CONTROL MONUMENT

CURVE	RADIUS	ARC LENGTH	CHORD LENGTH	CHORD BEARING	DELTA ANGLE
C1	330.00'	40.00'	39.98'	N 06°53'02" E	6°56'42"

**SURVEYOR'S NOTE(S):**  
THIS SURVEY MEETS THE CURRENT STANDARDS OF THE TEXAS SOCIETY OF PROFESSIONAL SURVEYORS STANDARDS AND SPECIFICATION FOR A CATEGORY 1A, CONDITION II SURVEY.

THE SETBACKS AND EASEMENTS SHOWN ON THIS DRAWING ARE THE BEST INTERPRETATION OF THE SURVEYORS BASED ON THE INFORMATION AVAILABLE TO US AT THE TIME OF THE DRAWING.

THIS SURVEY IS BASED ON A TITLE COMMITMENT REPORT ISSUED BY TITLE RESOURCES GUARANTY COMPANY GF NO. 5080921-049177 ISSUED ON 07/25/22.

FLOOD INFORMATION  
FIRM: 48201C PANEL: 0340 L  
REV. DATE: 06/18/2007  
ZONE: "X"

FLOOD INFORMATION PROVIDED HEREON IS BASED ON SCALING THE LOCATION OF THE SUBJECT TRACT ON THE FLOOD INSURANCE RATE MAPS. THE INFORMATION SHOULD BE USED TO DETERMINE FLOOD INSURANCE RATES ONLY AND IS NOT INTENDED TO IDENTIFY SPECIFIC FLOODING CONDITIONS. WE ARE NOT RESPONSIBLE FOR THE F.I.R.M.'S ACCURACY.

Being a 0.1375 acre tract of land located in the Gilbert Brooks Survey, A-6, Harris County, Texas, said 0.1375 acre tract being south 1/2 of Tract 205 of Water Wonderland, an unrecorded subdivision in Harris County, Texas, and same being described in Clerk's File Number R741827 (Kirkwood tract), of the Official Public Records of Real Property, Harris County (O.P.R.P.H.C.), Texas, said 0.1375 acre tract being more particularly described by metes and bounds as follows (bearings are based on the south line of said Tract 205):

**BEGINNING** at the northwest corner of said south 1/2 of Tract 205 and the southwest corner of the north 1/2 of said Tract 205 described in a deed to Thecia Nicole Kirkwood (Fruco tract), as recorded under Clerk's File Number R741826 of the O.P.R.P.H.C., and on the east right-of-way line of Waterfall Dr. (60 feet wide) from which a 1-inch iron pipe bears N00°21'03" W, 0.21';

**THENCE**, South 85 degrees 04 minutes 21 seconds East, a distance of 126.61 feet, with the common line of said south and north 1/2 of said Tract 205, to a 1/2-inch iron rod with cap stamped "OSC" set for the common east corner of said south and north 1/2 of Tract 205, and on the west line of Tract 197, described in a deed to Mark Craighead, in Clerk's File Number 20130162115 of the O.P.R.P.H.C.;

**THENCE**, South 00 degrees 55 minutes 45 seconds East, a distance of 52.90 feet, with the east line of said south 1/2 of Tract 205, to a 1/2-inch iron rod with cap stamped "OSC" set for the southeast corner of said Tract 205, and being the northeast corner of a called 0.6547-acre tract of land described in a deed to Randolph H. Smith & Megan R. Essenmacher in Clerk's File Number 20150474157 of the O.P.R.P.H.C.;

**THENCE**, North 79 degrees 38 minutes 37 seconds West, a distance of 133.98 feet, with the common line of said Tract 205 and said 0.6547-acre tract, to a 1/2-inch iron rod with cap stamped "OSC" set for the common west corner of said Tract 205 and said 0.6547-acre tract, and being on the east right-of-way line of said Waterfall Dr., for the beginning of a non-tangent curve to the left;

**THENCE**, 40.00 feet along the arc of said curve to the left, with the east right-of-way line of said Waterfall Dr. common to the west line of said Tract 205, said curve having a radius of 330.00', a central angle of 06°56'42" and a chord bearing North 06 degrees 53 minutes 02 seconds East, a distance of 39.98 feet to the **POINT OF BEGINNING** and containing 0.1375 acres of land.

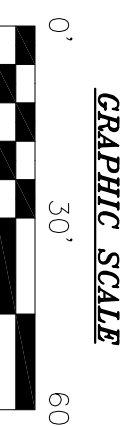

GRAPHIC SCALE

LAND TITLE SURVEY			
JOB NO.:	NO.	REVISION	DATE
2208036108			
DATE:	08/15/22		
DRAWN BY:	UB		
APPROVED BY:	LJD		

I, LUTHER J. DALY, a Registered Professional Land Surveyor in the State of Texas, do hereby certify to ZS REAL ESTATE HOLDINGS LLC and AMERICAN TITLE COMPANY OF HOUSTON that the above map is true and correct according to an actual field survey, made by me or under my supervision, of the property shown hereon or described by field notes accompanying this drawing. I further certify that all easements and rights-of-way of which I have been advised are shown hereon and that, except as shown, there are no apparent visible encroachments, no apparent visible overlapping of improvements and no apparent discrepancies or conflicts in the boundary lines, as of the date of the field survey.

Description: BEING A 0.1375 ACRE PARCEL OF LAND recorded in Clerk's File R741827, of the Map/Deed and Plat Records of HARRIS County, Texas, located in the ZS REAL ESTATE HOLDINGS LLC Borrower/owner: ZS REAL ESTATE HOLDINGS LLC Address: WATERFALL DR., HUFFMAN, TX 77336 GF No. 3080921-04917

PROPERTY PHOTOGRAPH:

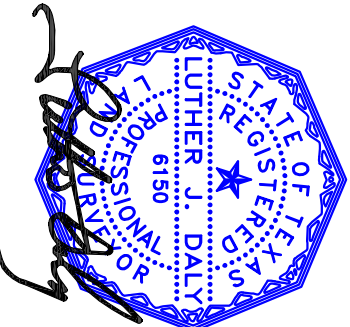

FIRM REGISTRATION NO. 10190700

LUTHER J. DALY, R.P.L.S.  
Registered Professional Land Surveyor  
Registration No. 6150

COPYRIGHT ALL RIGHTS RESERVED TO OVERLAND CONSORTIUM INC.

**Overland Consortium Inc.**  
Surveyors

Tel: 281-940-8869 Fax: 281-207-6476

999 E. BASSE ROAD, SUITE 180 BOX 521, SAN ANTONIO, TEXAS 78212