

**SPECIAL FEATURES
3820 KRAUSE RD
ROUND TOP, TX 78954**

LIGHTING:

Light fixtures in the living room, dining room and entry hall are individually created replicas from the early days of gas/electric lighting. The one in the dining room would have been a combination of gas lighting (the two upright arms) and electric lighting (the two down facing arms). The combination was used because electricity, when first used in homes, was only available for certain hours each day. The same artist, who was in Bastrop, designed the light fixture in the master bedroom. This was about 30 years ago.

LANDSCAPE:

In the center driveway circle, a large petrified log provides a seat at the end of the walkway. The walk is edged by native plants and roses. There are over 100 narcissus, Grand Primo, bulbs in the circle which come into bloom in late winter. We started off with less than a dozen, all of them being "Pass Along" plants. They are supposedly deer resistant and have been since being planted almost 25 years ago.

There are over 70 antique rose bushes on the property. Many plants reseed and bloom in season. In early spring these include poppies, larkspur and an excellent species of hardy dill. In summer zinnias will appear in a wide variety of colors.

Tony created the recirculating stream that flows across the front yard, under the walkway and down toward the pond. Water from the stream recirculates from the pond through underground pipes back up to the start of the stream. Several varieties of Louisiana Iris bloom along the stream in springtime.

There are several different varieties of day lilies growing in the kitchen garden and in other locations. Small Texas tarragon bushes provide yellow blossoms and sweet fragrance in autumn. A recirculating fountain was placed in the center of the kitchen garden. Below ground is a 6' blue plastic child's play pool. It is automatically refilled.

Rock Culvert Walls: The four walls on the sides of the driveway entrances were built with footings going down below grade and re-bar supports along the length of the walls at every level.

WOOD FLOORING:

More than 30 years ago Tony and Kay went on a home and winter garden tour in the Dallas area where they were living at the time. The entire first floor one house they looked at was finished to look as if it were built in the 1800s. One particularly striking feature were floors. When asked about them the docent explained it was actually new wood but it was put in, uncured, lightly sanded and stained. After the first winter it cured and became 'wavy-ish'. Visitors would stop and ask how old the house was because of the floors. That's what WE

wanted. So we told our builder, Charles Marburger, we wanted that vintage look. Now when people visit and ask when the house was built, I tell them it was “before the turn of century”. Looks of disbelief are then followed by laughter with my saying, “Well, I didn’t say what century.”

PORCHES:

There are spacious 12 – foot wide porches front and back. The front porch spans the width of the house (48’X12’). The off-the-ground construction makes the house appear as if it is pier and beam (in the old style). And actually the front porch is on pier and beam while the whole of the first floor is on slab.

The back porch floor is a concrete, L-shape. The concrete was poured to be a couple of inches lower than the back of the house so that plank flooring could be added over the concrete if ever desired.

KIDDIE TREE FORT:

That’s what the grand kids and new great-grand kids call it. It was built in Baytown, taken apart and rebuilt here.

FLOWER BED WATERING:

All the flower beds around the house have their own drip watering systems. Several of the bed systems are even set to be run on timers during the warm weather months to include the tomato bed. The rest of the beds can be automated if so desire.

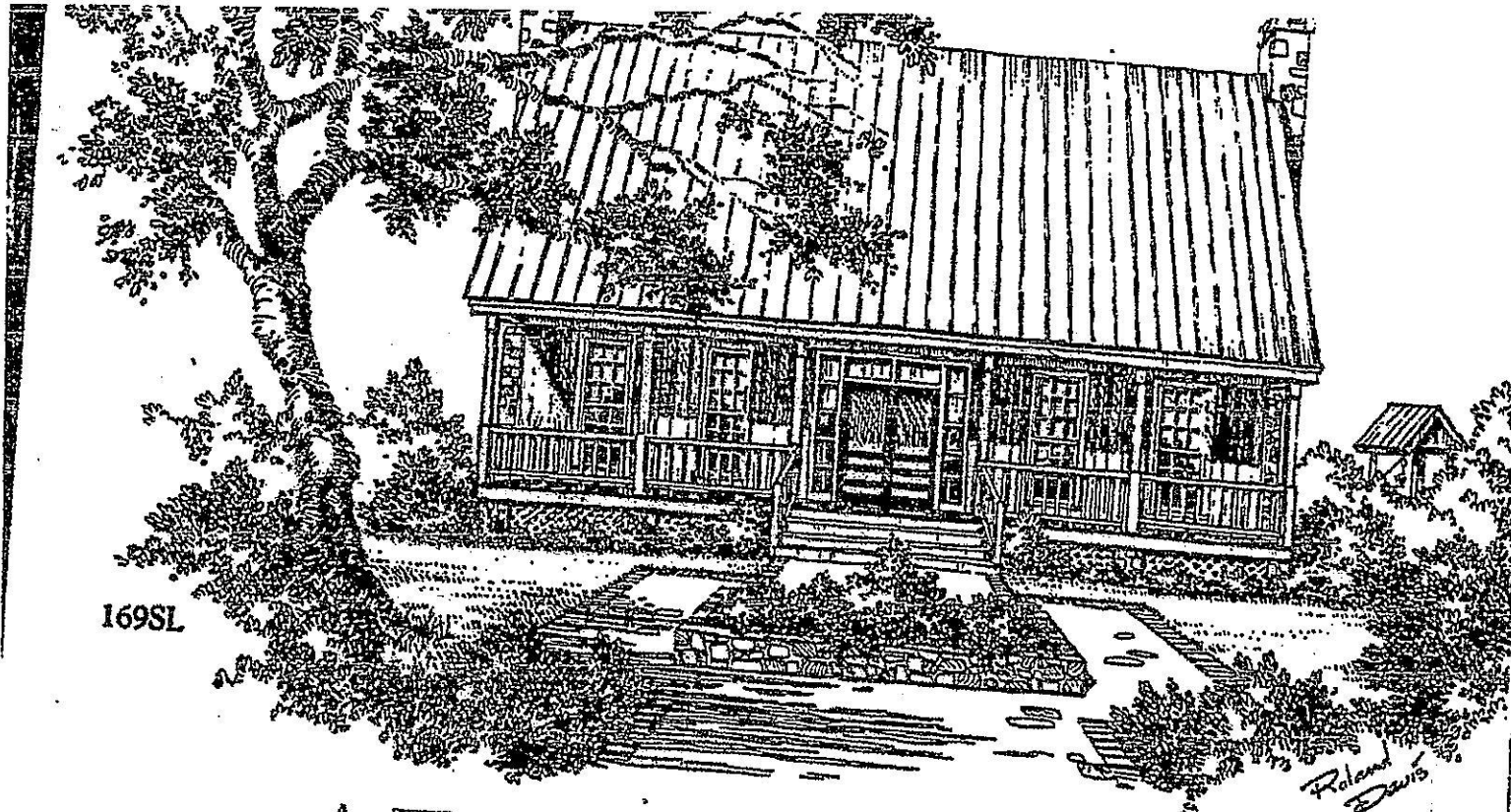

169SL

A Texas-Style Farmhouse

Set between sturdy stone chimneys, our early Texas-Style Farmhouse, with board-and-batten walls, carries useful lessons for today.

The roof is steeply pitched for shedding summer downpours, and it overhangs 12-foot-deep porches. Doors and floor-length windows give thorough cross-ventilation. Smaller "Texas windows" beneath the roof pull cool air into upstairs rooms.

Designed by Architect Barry Moore, FAIA, of Houston, the house is basic in the best sense, with rooms laid out in a simple, straightforward manner. Many of its details are adapted from historic Texas houses at Round Top.

The entry hall is wide and welcoming, derived from the open dogtrot of early Southern homes. At each end, screened double-door openings with transoms continue the tradition of a breezeway.

The dogtrot becomes part of a generous sweep of space between living room and dining room. Large cased openings give a long view of the twin fireplaces at the sides of the front rooms. A cozy inglenook off the living room holds a window seat and built-in bookcases.

The master bedroom is located in the

L-wing at the back of the house. It features a vaulted ceiling with skylight, double walk-in closets, and an adjoining bath.

Upstairs are two large bedrooms and a shared bath, which includes double dressing areas, bathtub, and separate shower.

The plan contains about 2,600 square feet of heated space with another 1,150 square feet in porches.

Working drawings for our Texas-Style Farmhouse are available through Southern Living. To order, see information below.

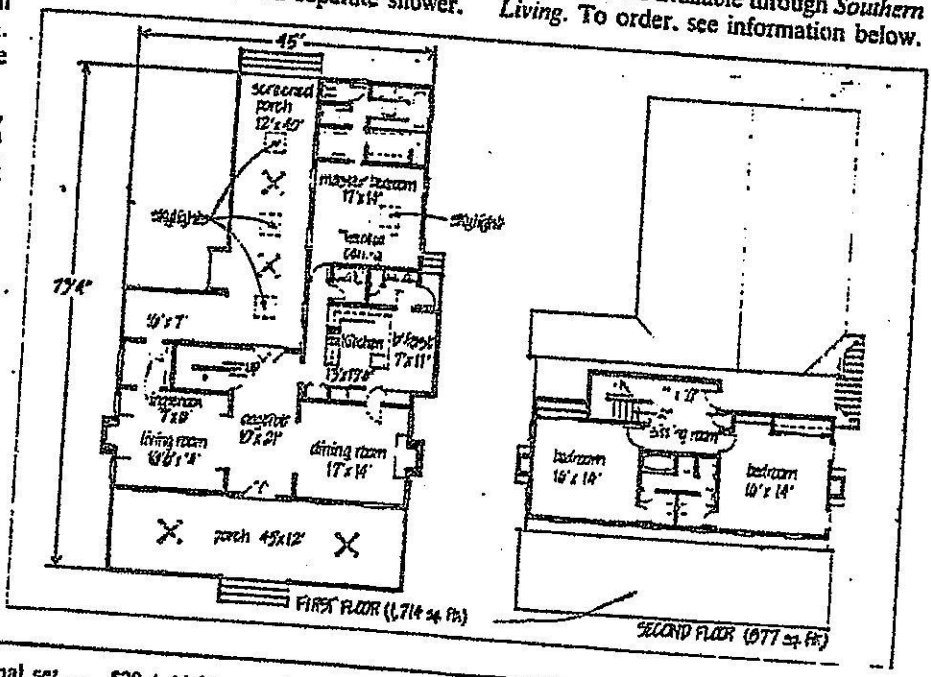

1 set . . . \$135 / 5 sets . . . \$185 / each additional set . . . \$20 / Alabama residents add 4% sales tax. Credit card orders call TOLL FREE 1-800-633-8628. In Alabama call 1-800-292-8667. Please make checks payable to Southern Living Plans, Box C-349, Birmingham, AL 35283.