

GENERAL NOTES:
 1) THE SURVEYOR HAS NOT INSPECTED THE SUBJECT OF RECORD, BUT HAS REVERSED THE SUBJECT OF RECORD, THAT MAY AFFECT THIS TRACT.
 2) BEARING LINES, EASEMENTS, FEED RESTRICTIONS, AND OTHER MATTERS MAY AFFECT THIS TRACT.
 3) BEARING STRUCTURE BASED ON TEXAS STATE PLANE COORDINATE SYSTEM AND 83 TRACT CENTRAL ZONE.
 4) THIS SURVEY IS BASED ON INFORMATION PROVIDED BY THE CLIENT AND WITHOUT THE BENEFIT OF A TITLE COMMITTEE.
 5) THE SURVEY IS NOT TO BE USED FOR ANY ON-GOING CONSTRUCTION PURPOSES. THE SURVEYOR DOES NOT WARRANT THAT THE PROPERTY COORDINATES WILL BE ACCURATE 24 HOURS PRIOR TO AND UNLESS-ALIGNED AND/OR REPORT IS ISSUED.
 6) SURVEYORS, ENGINEERS AND ARCHITECTS SHOULD VERIFY ALL DIMENSIONS, BEARING LINES, FEED RESTRICTIONS, EASEMENTS, AND OTHER MATTERS PRIOR TO ANY CONSTRUCTION.
 7) STATE OF TEXAS COUNTY RESTRICTIONS AND REGULATIONS REGARDING SUBDIVISION PLATTING AND SUBDIVISION RECORDING MAY AFFECT THIS TRACT AND SHOULD BE REVIEWED BY THE CLIENT.
 8) ALL SET BACKS AND DISTANCES ARE MARKED WITH CAP CHARACTERS UNLESS OTHERWISE NOTED.
 9) UPDATES TO SHOW 12.92 ACRES, 90.38 ACRES, & 220.68 ACRES TRACT NO. 2-28-2023.

FLOOD ZONE
 FOR INFORMATION PURPOSES ONLY
 THE SURVEYOR HAS NOT INSPECTED THE SUBJECT OF RECORD, BUT HAS REVERSED THE SUBJECT OF RECORD, THAT MAY AFFECT THIS TRACT.
 MAP NO. 440202023, DATED 11-14-2019.

LINE TABLE

LINE	DISTANCE	BEARING
L1	191.19'	N 02°59'20" W
L2	157.86'	N 19°45'33" E
L3	296.79'	N 16°23'11" W
L4	210.39'	N 20°13'19" E
L5	204.93'	N 18°32'04" W
L6	227.87'	N 69°21'20" W
L7	316.81'	N 19°56'08" W
L8	155.48'	S 46°20'51" W
L9	240.35'	S 40°18'11" W
L10	91.59'	S 02°50'02" E
L11	380.32'	S 72°51'18" E
L12	83.93'	S 64°31'21" E
L13	547.69'	S 37°13'01" E
L14	13.99'	N 74°43'44" E
L15	99.64'	N 15°11'59" W

CURVE TABLE

CURVE	RADIUS	ARC	BEARING	CHORD
C1	7589.50'	439.98'	N 70°20'23" E	439.92'
C2	7589.50'	361.42'	N 73°21'53" E	361.38'

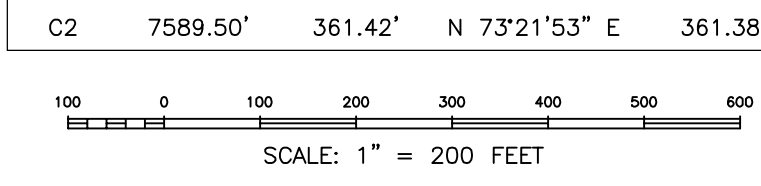

SURVEY PREPARED FOR: JAMES ROBERT FARMS
 DESCRIPTION OF PROPERTY:
 12.92 ACRES, 90.38 ACRES & 220.68 ACRES, BEING SITUATED IN THE VITAL FLORES SURVEY ABSTRACT NO. 14 & THE ARCHIBALD McNEIL SURVEY ABSTRACT NO. 218 SAN JACINTO COUNTY TEXAS. (REFER TO SEPARATE LEGAL DESCRIPTION)
 I HEREBY CERTIFY THAT THIS PLAT IS TRUE AND CORRECT TO THE BEST OF MY KNOWLEDGE AND BELIEF AS SURVEYED ON THE GROUND, JANUARY 3, 2023.
 PRELIMINARY: THIS DOCUMENT SHALL NOT BE RECORDED FOR ANY PURPOSE AND SHALL NOT BE USED OR VIEWED OR RELIED UPON AS A FINAL SURVEY DOCUMENT.
 LOUIS W. BERGMAN IV
 R.P.L.S. NO. 2815
 Humble Surveying Company
 700 South Broadway, Suite 404
 Houston, TX 77030
 (281) 446-0118 Fax (281) 992-7138
 TITUS TEXAS REG. NO. 0114600
 Chapter # 2800 No Rights Reserved
 1/3/2023 - 3:54 March 2023.493
 Sheet: 17 of 207 Total: 2-28-2023
 Drawn by: FG