

- NOTES:**
- 1) -# DENOTES WOOD FENCE.
 - 2) CABLE T.V AGREEMENT BY H.C.C.F. No. H 428719.
 - 3) GARAGE IS NOT WITHIN THE 5' x 20' AERIAL ESMT.

ALL BEARINGS BASED ON RECORDED PLAT. FLOOD ZONE DETERMINED BY GRAPHIC PLOTTING ONLY. WE DO NOT ASSUME RESPONSIBILITY FOR EXACT DETERMINATION. THIS SURVEY HAS BEEN COMPILED IN ACCORDANCE WITH INFORMATION CONTAINED IN THE TITLE COMMITMENT REFERENCED IN GF NO. 475-95-4327

LOT 40	BLOCK 6	SECTION 1	SUBDIVISION LAKEWOOD FOREST		This lot <u>DOES NOT</u> lie in the 100 year flood plan and is in <u>ZONE "X"</u> as located by the Federal Insurance Administration designated Flood Hazard Area by Community Panel No. <u>480287 0090G</u> dated <u>09-28-90</u>
RECORDATION VOL. 192, PG. 130, H C M R		COUNTY HARRIS	STATE TEXAS	SURVEY —	
LENDER —		TITLE CO. TEXAS AMERICAN TITLE CO.			
PURCHASER MARK RUSSELL AND KATHRYN A. RUSSELL ADDRESS 11611 JAYCREEK DRIVE.					JOB NO. 17527 W

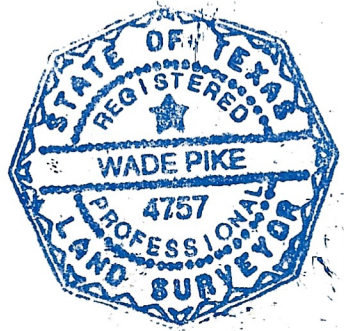

I do hereby certify to TEXAS AMERICAN TITLE COMPANY that this survey was this day made on the ground and that this plat correctly represents the property legally described hereon (or on attached sheet). That the facts found at the time of this survey show the improvements and that there are no encroachments apparent on the ground, except as shown.

[Signature]

FIELD WORK	04-01-96	RG
DRAFTED BY	04-02-96	VN
CHECKED BY	04-02-96	WP
KEY MAP NO.	369 A	

THE WINDROSE SURVEY COMPANY
 11301 Richmond, Suite K105
 Houston, Texas 77082
 (713) 558-8006