

Tract 1 called 13713 Acres to  
 Albert M. Smith 3/10/70, Vol. 657, P. 55, 1/4 AC  
 Actual 13.7323 Acres

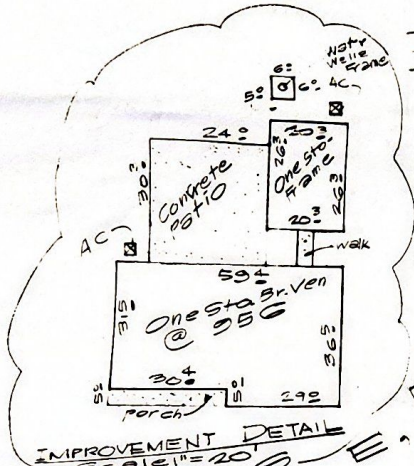

**NOTE**  
 All bearings refer to the  
 West L.L. Tr. to the  
 2nd 2nd Sec. 36, T. 10 N.,  
 R. 23 E., 10th & 11th R.  
 of the 3rd Meridian.  
 The tract is in Zone  
 1804. Main Per Firm No. 100  
 48043800758 (9/30/1988)

Daniel & Doris Dructor  
 191, 139 AC, Tract  
 Vol. 1526, Pg. 368, 1/4 AC

J. Steve Pipkin, et ux Stacy  
 27.4552 Acres

24 Gulf States (Energy)  
 Elec. Service 240/504PK  
 Shd. of 15m + 1079/548  
 1748/400 PK.

Tract 2 called 13125  
 desc. in Vol. 129, P. 10, 1/4 AC  
 Actual 13.125 Acres

Original Parent Tract  
 Cont. to Vol. 129, P. 10, 1/4 AC  
 Vol. 129, Pg. 461, 1/4 AC.

OAK SHADED DRIVE  
 COUNTY RD. No. 2212

Tarkington Special Util. Dist  
 Easement 1822/437, 1/4 AC

WIDE GINNING 1/2 AC  
 Tract 129 AC, Tract  
 82 1/4 AC, 129 AC

**TO ALL PARTIES INTERESTED IN TITLE TO PREMISES SURVEYED:**

I certify this plat to represent a survey made under my supervision on the ground, showing all improvements thereon and all encumbrances of which I have knowledge.



**BOUNDARY LAND TITLE SURVEY OF**  
 27.4552 ACRES BEING 13.7323 AC.  
 TRACT 1 & 13.125 ACRE TRACT NO. 2  
 OUT OF D.V. SMITH 82 1/4 AC PARENT TRACT,  
 OUT OF THE  
 MOSES DONAHOE LEAGUE, ABST. 25,  
 LIBERTY COUNTY,  
 TEXAS