

HILLTOP VILLAGE
BLOCK 2
CAB. E, SHEET 110B
M.R.M.C.T.

SYMBOL LEGEND

- FOUND SURVEY MONUMENT
- SET SURVEY MONUMENT



LOT 27

SET 1/2" I.R.
W/TPS CAP

FND 3/4" I.P.
N 11°49'29" E 381.05'

S 77°59'39" E 183.22'

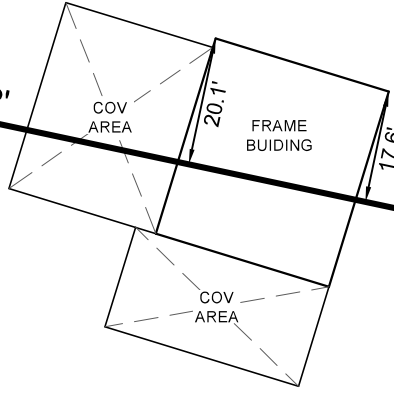

SET 1/2" I.R.
W/TPS CAP

N 12°27'17" E 117.55'

HAIRSTON DRIVE (60' R.O.W.)

N 11°49'31" E 285.43'

10' U.E.

25' B.L.

LOT 26

S 12°27'17" W 286.42'

GM OMEGA FARMS RV PARK LLC
"MULTIPLE TRACTS"
C.F. NO. 2014080996
O.P.R.M.C.T.

SET 1/2" I.R.
W/TPS CAP

N 77°40'57" W 180.08'

SET 1/2" I.R.
W/TPS CAP

**BOUNDARY & IMPROVEMENT
SURVEY**

SURVEYOR HAS RELIED ON INFORMATION PROVIDED BY:
FIRST AMERICAN TITLE GUARANTY COMPANY
G.F. NO. 2790776-HO43
EFFECTIVE DATE: JANUARY 6, 2023

HF HOLDING COMPANY LLC
M.C.A.D. ID NO. R532495

THE SUBJECT TRACT(S) AS SHOWN HEREON MAY BE SUBJECT TO THE
FOLLOWING ITEM LISTED IN SCHEDULE B, OF SAID TITLE COMMITMENT:

1. THOSE AS PER ITEM 10(A), SCHEDULE B, OF SAID TITLE COMMITMENT.
2. UNOBSTRUCTED AERIAL EASEMENT 5' IN WIDTH, FROM A PLANE 20'
ABOVE THE GROUND, UPWARD, LOCATED ADJACENT TO ALL UTILITY
EASEMENTS SHOWN HEREON.

I HEREBY CERTIFY THAT THIS SURVEY WAS THIS DAY MADE UNDER MY SUPERVISION
ON THE GROUND OF THE ABOVE DESCRIBED PROPERTY, AND THAT THE ABOVE PLAT
OR DRAWING REFLECTS THE FINDINGS ON THE GROUND OF THE PROPERTY AT THIS
TIME AND THAT THIS SURVEY SUBSTANTIALLY CONFORMS TO THE CURRENT TEXAS
SOCIETY OF PROFESSIONAL SURVEYORS STANDARDS AND SPECIFICATION FOR A
CATEGORY 1A, CONDITION II SURVEY.

NO PORTION OF THIS PROPERTY APPEARS TO LIE WITHIN THE 100
YEAR FLOODPLAIN PER GRAPHIC SCALING OF COMMUNITY PANEL
NO. 48339C0225G HAVING AN EFFECTIVE DATE OF 08/18/2014.

ALL COORDINATES, BEARINGS AND DISTANCES ARE REFERENCED TO THE
TEXAS COORDINATE SYSTEM OF 1983 (2011 ADJUSTMENT), CENTRAL ZONE
(TXC-4203), U.S. SURVEY FEET, AND ARE BASED ON GPS OBSERVATIONS MADE
BY TEXAS PROFESSIONAL SURVEYING, LLC.

PROJECT NUMBER	30761
DATE	01-26-2023
DRAWN BY	ADV
CHECKED BY	GM
FIELD CREW	VL
REVISION 1	---
REVISION 2	---
REVISION 3	---
REVISION 4	---



PURCHASER.....TEXAS LIBERTY HOLDINGS, LLC
ADDRESS.....11876 HAIRSTON DRIVE, WILLIS, TX, 77318
SURVEY.....F.K. HENDERSON, A - 248
SUBJECT.....LOT 26, BLOCK 2
SUBDIVISION.....HILLTOP VILLAGE
RECORDING.....CABINET E, SHEET 110B, MAP RECORDS
COUNTY.....MONTGOMERY

Carey A. Johnson
Registered Professional Land Surveyor No. 6524

