

1	D.001	DEMOLITION	REAR PATIO
2	A.001	SITE PLAN	
3	A.002	PROPOSED FLOOR PLAN	2104283 REVIEWED FOR COMPLIANCE
4	A.003	EXTERIOR ELEVATIONS	Redline of this review does not relieve the applicant from full responsibility to comply with all applicable codes, ordinances and regulations. 11/29/21
5	A.004	EXTERIOR ELEVATIONS	
6	E.001	ELECTRICAL FLOOR PLAN	
7	E.002	ENERGY CODE REQUIREMENTS	
8	S.001	CEILING FRAMING PLAN	
9	S.002	FOUNDATION FOOTING DETAIL	
10	G.001	IRC-2012 DETAILS (CROSS-SECTION)	
11	G.002	IRC-2012 NOTES & (NAIL SCHEDULES)	

SCOPE OF WORK
Repair & Small Remodel

1. PROPOSED REMOVE / REPLACE EXIST. WD. BEAM ALSO INCLUDE DAMAGED CEILING JOISTS.
2. RELOCATE EXISTING KITCHEN AS SHOWN ON DWG A.002
3. REMOVE KITCHEN CABINETS & BUILD NEW AS SHOWN SEE DWG A.002 FOR NEW KITCHEN LAYOUT.
4. REMOVE EXISTING WALL & PROVIDE STRUCTURAL BEAM FOR CEILING & ROOF SUPPORT.
5. REMOVE PARTITION WALL SEE DWG A.002 FOR LAYOUT.
6. ADD SUPPORT BEAM AS SHOWN & REPLACE DAMAGED WOOD AS REQUIRED.
7. CONVERT EXIST. BATH #3 INTO A JACK & JILL TYPE SEE DWG A.002 FOR NEW BATHROOM LAYOUT.
8. CONVERT THE EXISTING GREAT ROOM IN THE BACK INTO A MASTER BEDROOM INCORPORATE EXIST. BATH & WALK IN CLOSET SEE DWG A.001
9. REPLACE ALL DAMAGED WOOD AT REAR PATIO DECK INCLUDE STEPS, GUARDRAILS & HANDRAILS.
10. REMOVE / REPLACE ALL WINDOWS & DOORS AS PER ENERGY CODE REPORT .
11. REPLACE ALL 1/2" SHEETROCK AT CEILING & WALLS ALSO REPLACE FLOOR FINISHES AS SHOWN ON A.001
12. REPLACE EXTERIOR SIDING AS SHOWN ON SHEET A.001 ALSO REPLACE ROOF SHINGLES .
13. PAINT INTERIOR & EXTERIOR OF HOUSE

ALL PLUMBING, ELECTRICAL
& HVAC WORK BY
MASTER TECHNICIANS

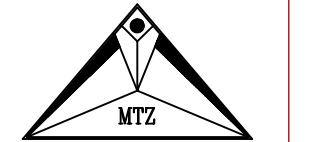

MTZ CAD SERVICES INC.
2500 STRAWBERRY PASADENA TX 77502
AutoCAD DRAFTING
Tel: (713) 477-0659 Cell: (713) 419-0638

DESIGN & PLANNING SERVICES

ALL DRAWINGS HAVE BEEN REVIEWED AND COMPLY TO SUITE OWNER'S SPECIFICATIONS. ALL REASONABLE ATTEMPTS AND PRECAUTIONS HAVE BEEN MADE TO AVOID OWNER CONFLICT. THE OWNER AND/OR CONTRACTOR SHALL VERIFY AND APPROVE ALL DIMENSIONS, DETAILS AND SPECIFICATIONS BEFORE CONSTRUCTION MAY COMMENCE.

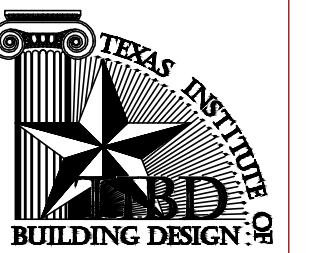

Designer: Prisciliano Martinez

CUSTOMER: FRANCISCO CAMPOS
HOUSE REPAIRS & SMALL REMODELING
ADDRESS: 741 WINDING RD. PASADENA TX. 77504
EXISTING FLOOR PLAN & SCOPE OF WORK

Revisions:

1 09/10/21 FOR CONSTRUCTION

Date: 09/10/21

Drawn: PM

Approved:

Cadd File No: 2021_JOBS/MTZ

C.O.H. JOB NO: Project No: 21044

Sheet Title: FLOOR PLAN

Sheet No: D.001

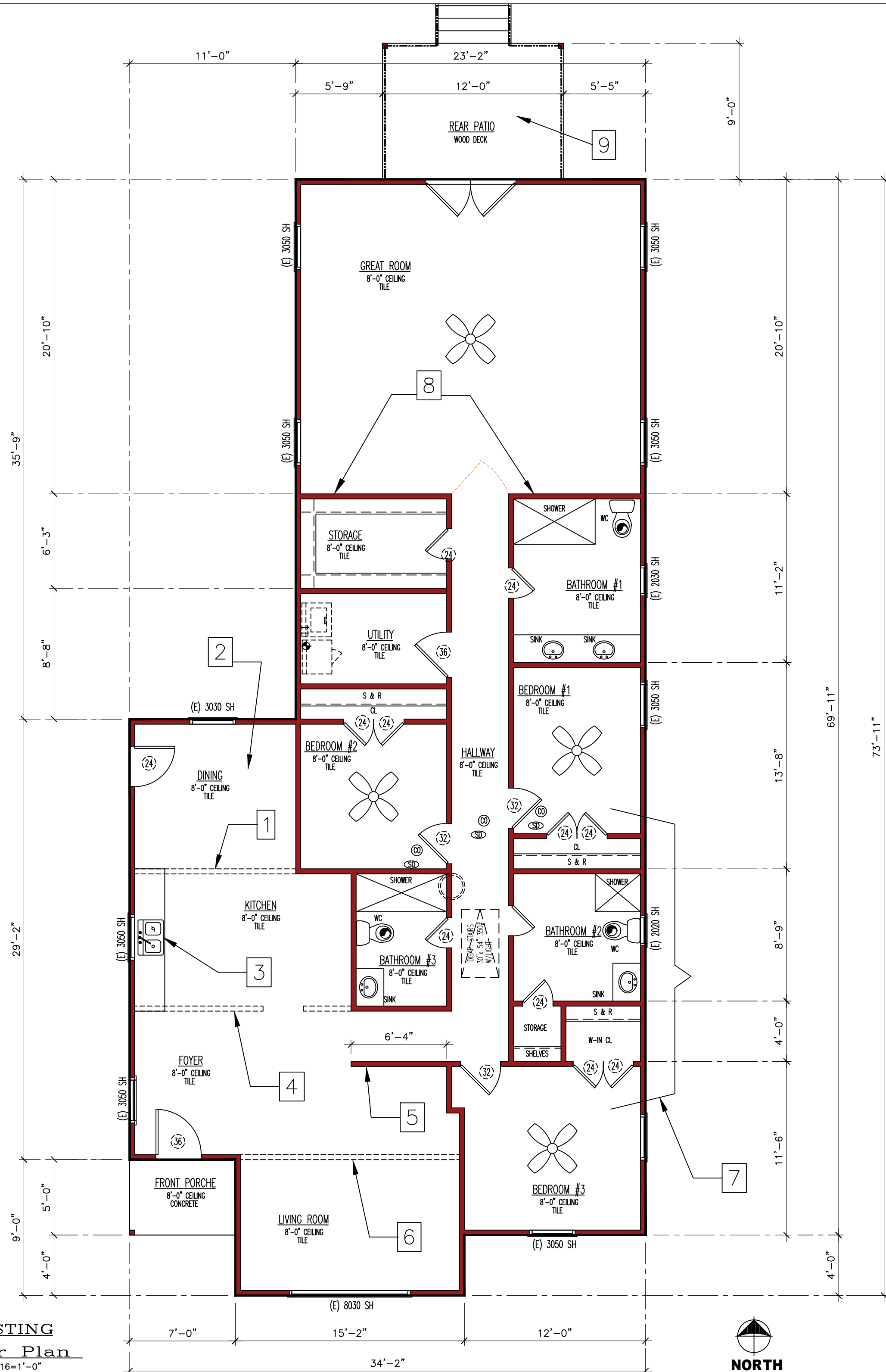

EXISTING
Floor Plan
Scale: 3/16=1'-0"

