

LEGEND	—/— WOODEN FENCE	ELEV. ELEVATION	(B.O.) BUILDER GUIDELINES	⊞ INLET	⊞ MANHOLE & INLET	⊞ CABLE PEDESTAL	⊞ TELEPHONE PEDESTAL	⊞ GRATE DRAIN
▬ FLATWORK	—/— WROUGHT IRON FENCE	T.O.F. TOP OF FORM	M.A.E. MAINTENANCE EASEMENT	⊞ UTILITY VAULT	⊞ FND. FOUND	⊞ WATER METER	⊞ FIRE HYDRANT	⊞ GAS METER
—/— PROPERTY LINE	—/— CHAIN LINK FENCE	F.F. FINISHED FLOOR	R.O.W. RIGHT-OF-WAY	⊞ FND. BLDG. BUILDING	⊞ A.E. AERIAL EASEMENT	⊞ WATER VALVE	⊞ LIGHT POLE	⊞ MANHOLE
—/— BUILDING LINE	—/— OVERHEAD ELECTRIC	EXT. EXTENDED	S.L.E. STREET LIGHT EASEMENT					⊞ GUY ANCHOR
—/— EASEMENT	B.L. BUILDING LINE	PVT. PRIVATE	D.E. DRAINAGE EASEMENT					⊞ POWER POLE
	U.E. UTILITY EASEMENT	CONC. CONCRETE	E.E. ELECTRIC EASEMENT					
	W.L.E. WATER LINE EASEMENT	I.R. IRON ROD	S.S.E. SANITARY SEWER EASEMENT					
		I.P. IRON PIPE	STM.S.E. STORM SEWER EASEMENT					

RESERVE "E"

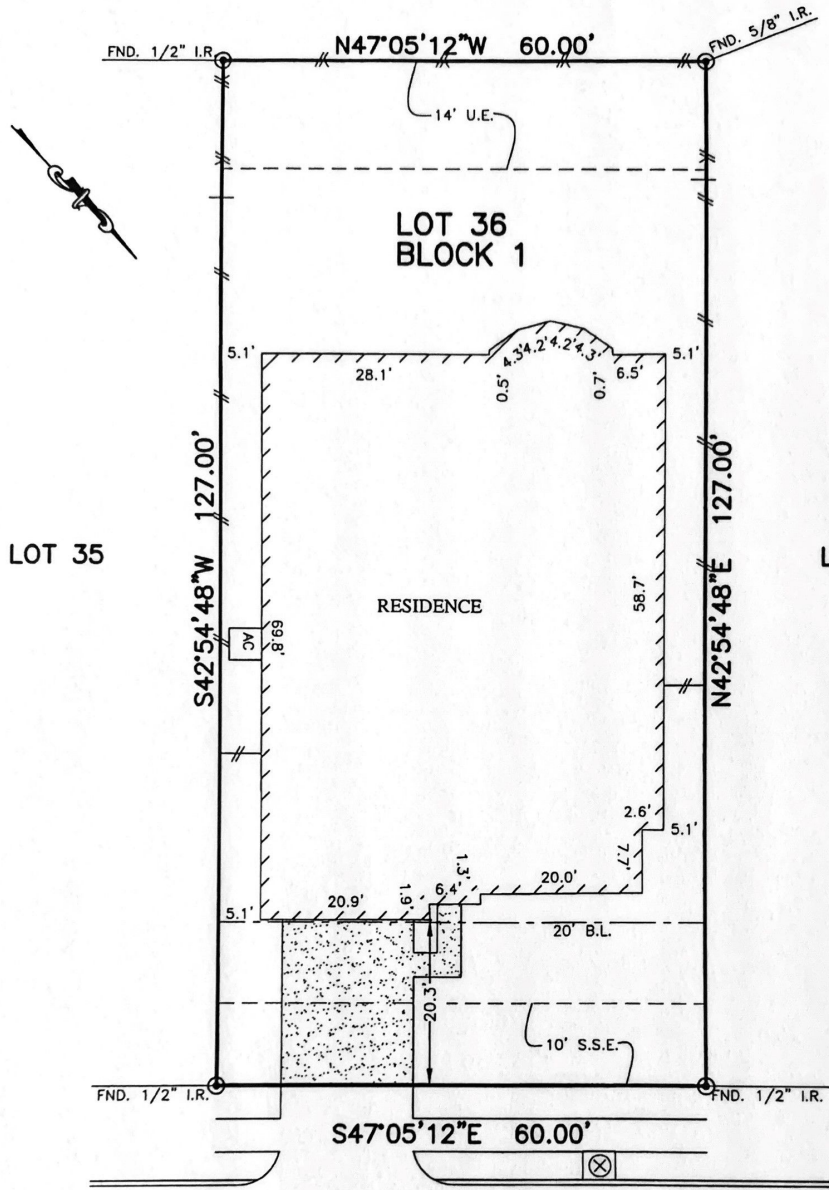

24327
MAJESTIC CROWN COURT
 (50' R.O.W.)

- NOTES:
1. ALL BEARINGS SHOWN HEREON ARE BASED ON THE RECORDED PLAT.
 2. SURVEYOR HAS NOT ABSTRACTED THE SUBJECT PROPERTY. ABSTRACTING BY TITLE COMPANY ONLY. THERE MAY BE EASEMENTS, RESTRICTIONS AND OTHER MATTERS OF RECORD NOT SHOWN HEREON.

PLAT OF SURVEY
 SCALE: 1" = 20'

FLOOD MAP:
 THIS PROPERTY LIES IN ZONE "X-SHADED"
 AS DEPICTED ON COMMUNITY PANEL
 No. 48201C0585L, EFFECTIVE DATE: 06-18-07

"THIS INFORMATION IS BASED ON GRAPHIC PLOTTING.
 WE DO NOT ASSUME RESPONSIBILITY FOR EXACT
 DETERMINATION"

© 2017, ALLPOINTS SERVICES, CORP., All Rights Reserved. This original work is protected under copyrights laws, Title 17 U.S. Code Sections 101 & 102. All violators will be prosecuted to the extent of the law. This survey is being provided solely for the use of the recipients and no license has been created, express or implied, to copy the survey except as is necessary in conjunction with the original transaction.

FOR: PULTE HOMES of TEXAS
 ADDRESS: 24327 MAJESTIC
 CROWN COURT
 ALLPOINTS JOB #:PH133276CO
 G.F.:

LOT 36, BLOCK 1,
 KING CROSSING, SECTION 8,
 FILM CODE NO. 678302, MAP RECORDS,
 HARRIS COUNTY, TEXAS

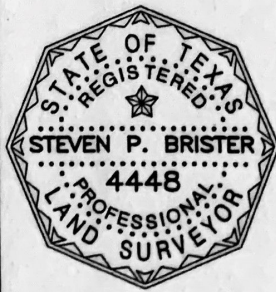

ALLPOINTS
 SERVICES CORP
 PHONE: 713-468-7707
 T.B.P.L.S. NO. 10122600

I HEREBY CERTIFY THAT THIS PLAT REPRESENTS THE
 RESULTS OF A SURVEY MADE ON THE GROUND, ON THE 3RD
 DAY OF APRIL, 2017.

Steven P. Brister