



PRECISION FOUNDATION SERVICE, INC.
Since 1972

MPL# 39111

T. Everett, Inspector
March 21, 2019

RE: 6130 Sugar Hill Drive
Houston, Texas 77057

General Info: An underground sewer inspection was performed at 6130 Sugar Hill, Houston, Texas 77057. This home was built in 1957. Sewer systems of this age are typically cast iron and concrete. The sewer system consists of 4 baths, kitchen sinks and washing machine. Five clean outs were located. The purpose of the inspection was to determine the condition of the existing underground sewer system. Please note that when performing a camera inspection, not all drain lines will be accessible with the camera. Camera did not access all lines shown on attached drawing.

Camera Inspection:

Under slab lines: Ran camera through five accessible clean outs. All under slab lines have been replaced with sch 40 pvc and looked to be in good condition. No breaks, bellies or separations were visible with the camera.

Exterior Main line: Ran camera through 4" clean out. Exterior main line is pvc indicating it has previously been replaced. The exterior line looked to be in good condition. No breaks, bellies or separations were visible with the camera.

Recommendations:

No repairs or maintenance is recommended at this time.

Should you have any questions, please contact our office at (713) 973-0114.

Thank you.

Trey Everett

8427 HAMMERLY BLVD. HOUSTON, TEXAS 77055
(713) 973-0114 FAX: (281) 944-9096



Since 1972

PRECISION FOUNDATION SERVICE, INC.

8427 HAMMERLY BLVD. HOUSTON, TEXAS 77055
(713) 973-0114 FAX: (713) 973-0159

STORIES:	1	1.5	2	2.5	3	Other: _____
FOUNDATION:	S/R	P/T	B&B	P&B	Other: _____	
VENEER:	B/V	W/S	Alum.	Other: _____		
LOT TYPE:	S/D	∅	T/H	Other: _____		

NUMBER OF BREAK OUTS: _____
 TYPE: P/G _____ OTHER: _____ # _____
 DIRT: _____ P/B's: _____
 LIFT: _____ ADJ's: _____

NAME _____ HOME _____ HIS WORK _____
 ADDRESS 6130 Sugar Hill KEY MAP # _____ # HOLES _____
 CITY HOUSTON TX 77057

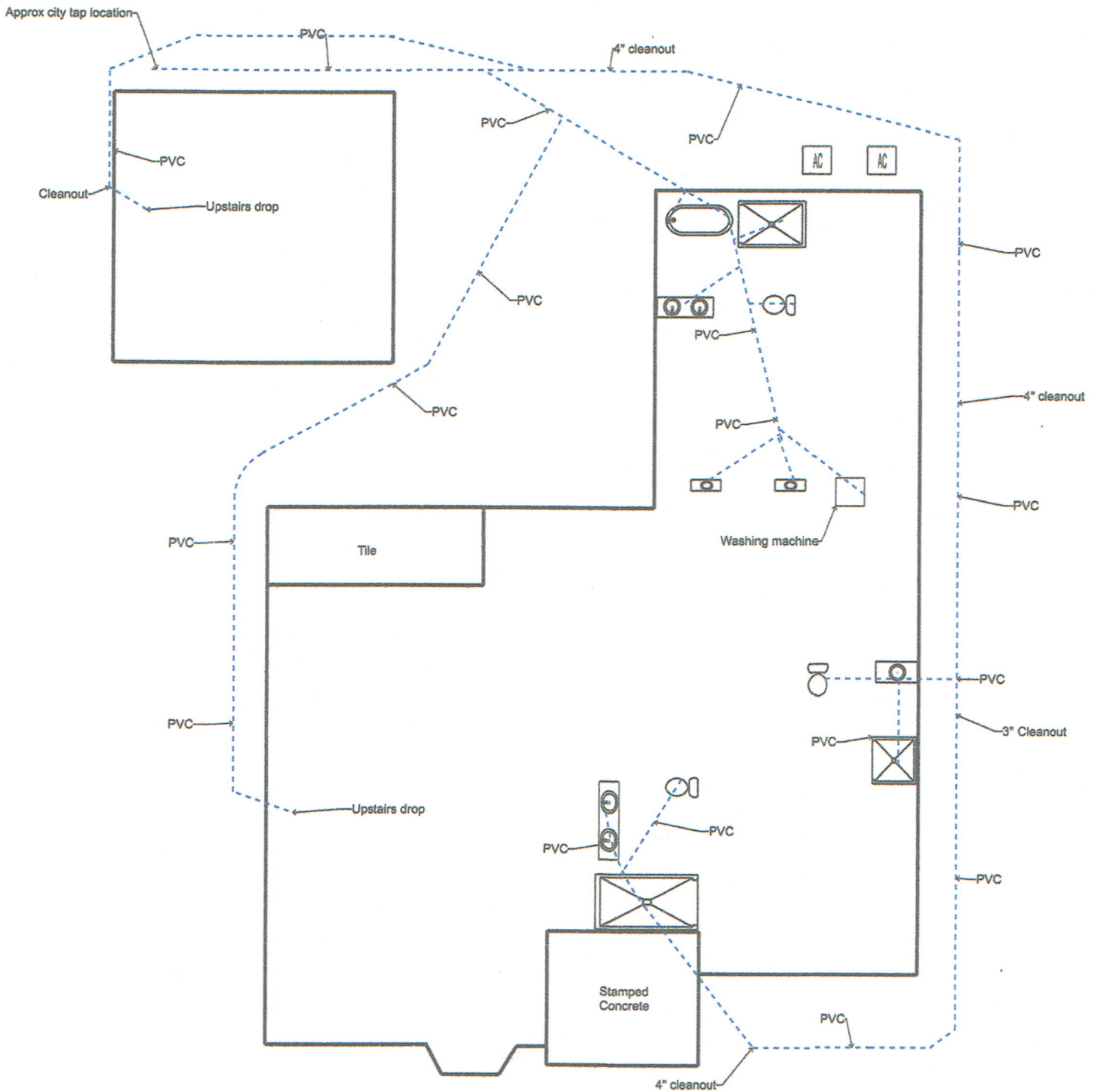

Note: Line locations are approximate. Not all lines shown were accessible to the camera.