

AMERITEX HOMES®
1231 PLAN

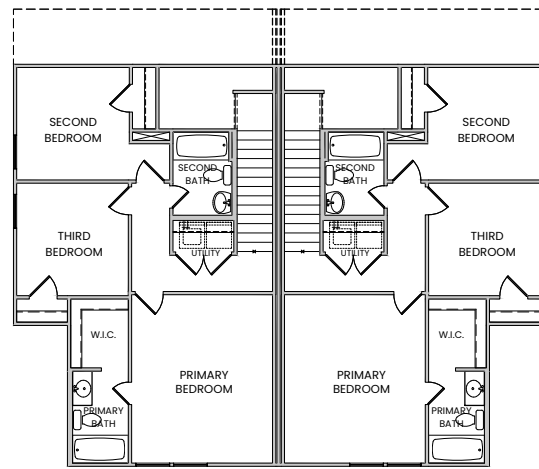

- ✓ Two Duplex Units, 1231 Sqft Each
- ✓ 3 Beds / 2.5 Baths / 2-Car Garage
- ✓ Certified Energy-Efficient
- ✓ Smart Home Technology
- ✓ Open Concept Living/Dining
- ✓ Granite Countertops
- ✓ Samsung Appliance Package
- ✓ Shaw Expo Vinyl Plank Flooring
- ✓ New Home Warranty



SECOND FLOOR

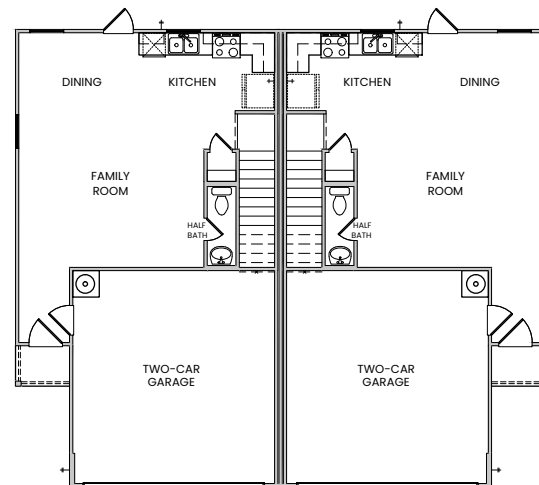

FIRST FLOOR





Ameritex home owners save an average of \$855+ per year on energy costs.*



THE AMERITEX DIFFERENCE

By equipping our homes with the latest energy-efficient technology, durable building materials and warranted workmanship, Ameritex Homes® is able to achieve a superior H.E.R.S. energy rating, increased cost savings and minimized energy consumption than the average household.

Ultimately with an Ameritex home, you are receiving the newest building materials and modern finishings designed to make living more comfortable and efficient all while reducing long-term costs.

We call this the Ameritex PinECONe Advantage.



KEY FEATURES

- Granite Countertops
- Shaker Style Wood Cabinets
- Energy-Efficient Samsung Appliances
- Shaw Expo 6MIL Vinyl Plank Wood-Look Flooring
Color/Style: Dublin
- Programmable Thermostat
- Smart Home Z-Wave Hub & Keyless
- Locks Low-E Windows
- LED Lighting
- Sherwin Williams Exterior/Interior Paint
- 25+ Year 3-Tab Shingled Roof
- 10 Year New Home Warranty

Energy-efficiency results vary and are an estimate or average and not a guarantee. Photos or renderings may be of a staged representative property; Ameritex homes are unfurnished and finishings, landscaping, and other listed features may vary and are dependent on home plan and/or location.



Contact Ameritex Homes® for latest availability & more details!