

FLOORPLAN SKETCH

| | |
|-------------------------------------------|---------------------------|
| Client: Lori Craft | File No.: Maghogany Crest |
| Property Address: 16311 Mahogany Crest Dr | Case No.: |
| City: Cypress | State: Tx Zip: 77429 |

Sketch

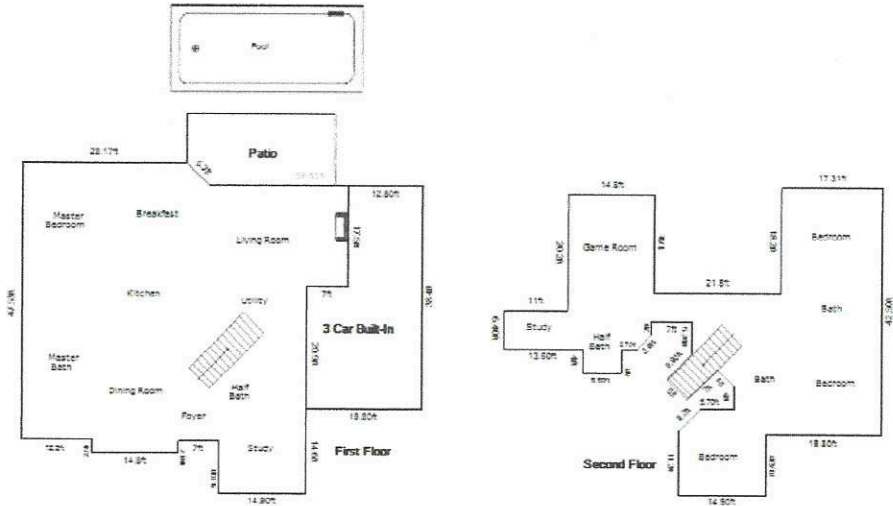

22 ft

| Living Area | | Area Calculation | | | |
|-------------------------------------|-------------------------|--------------------------------------------------|-------------------------|--|--|
| First Floor | 3190.48 ft ² | First Floor x 1.00 = 3190.48 ft ² | | | |
| 3 Car Built-In | -637.82 ft ² | 68.70ft x 38.4ft x 1.00 = | 2639.08 ft ² | | |
| Second Floor | 1763.13 ft ² | 14.6ft x 14.90ft x 1.00 = | 217.54 ft ² | | |
| Nonliving Area | | 12.2ft x 5.10ft x 1.00 = | 62.22 ft ² | | |
| Patio | 309.05 ft ² | 7ft x 5.5ft x 1.00 = | 38.5 ft ² | | |
| | | 14.8ft x 7.60ft x 1.00 = | 112.48 ft ² | | |
| | | 4.03ft x 5.7ft x 0.35 = | 8.12 ft ² | | |
| | | 28.17ft x 4.03ft x 1.00 = | 113.54 ft ² | | |
| | | 3 Car Built-In x -1.00 = -637.82 ft ² | | | |
| | | 19.80ft x 20.9ft x 1.00 = | 413.82 ft ² | | |
| | | 17.5ft x 12.80ft x 1.00 = | 224.00 ft ² | | |
| | | Second Floor x 1.00 = 1763.13 ft ² | | | |
| | | 4ft x 6.60ft x 1.00 = | 26.40 ft ² | | |
| | | 2ft x 25.45ft x 1.00 = | 50.89 ft ² | | |
| | | 11ft x 1.85ft x 1.00 = | 20.40 ft ² | | |
| | | 17ft x 14.8ft x 1.00 = | 251.60 ft ² | | |
| | | 21.45ft x 5.05ft x 1.00 = | 108.39 ft ² | | |
| | | 10.25ft x 10.25ft x 0.50 = | 52.58 ft ² | | |
| | | 10.42ft x 14.90ft x 1.00 = | 155.22 ft ² | | |
| | | 0.78ft x 0.78ft x 0.50 = | 0.31 ft ² | | |
| | | 5.2ft x 1.11ft x 0.50 = | 2.88 ft ² | | |
| | | 4.40ft x 6.23ft x 0.35 = | 9.59 ft ² | | |
| | | 5.90ft x 5ft x 0.50 = | 14.75 ft ² | | |
| | | 7.73ft x 7ft x 0.32 = | 17.5 ft ² | | |
| | | 8.40ft x 3.35ft x 0.35 = | 9.96 ft ² | | |
| | | 3.72ft x 14.50ft x 0.35 = | 19.07 ft ² | | |
| | | 5.12ft x 11.03ft x 0.50 = | 28.23 ft ² | | |
| | | 4ft x 4.40ft x 0.50 = | 8.80 ft ² | | |
| | | 5.66ft x 8.40ft x 0.35 = | 16.80 ft ² | | |
| | | 4.40ft x 3.11ft x 0.35 = | 4.84 ft ² | | |
| | | 5.35ft x 3.11ft x 1.00 = | 16.64 ft ² | | |
| | | 5.32ft x 2.89ft x 0.42 = | 6.45 ft ² | | |
| | | 5.70ft x 4.46ft x 1.00 = | 25.42 ft ² | | |
| | | 17.31ft x 29.84ft x 0.41 = | 210.32 ft ² | | |
| | | 4.90ft x 24.3ft x 1.00 = | 119.07 ft ² | | |
| | | 3.6ft x 2.55ft x 0.35 = | 3.24 ft ² | | |
| | | 22.9ft x 2.55ft x 1.00 = | 58.29 ft ² | | |
| | | 29.84ft x 24.3ft x 0.29 = | 210.32 ft ² | | |
| | | 18.2ft x 17.31ft x 1.00 = | 315.05 ft ² | | |
| Total Living Area (rounded): | | 4316 ft² | | | |