

STATE OF TEXAS :
COUNTY OF FORT BEND:

I, BRIANNE L. DYLLA A/K/A BRIANNE DYLLA, A MARRIED PERSON, OWNER; HEREINAFTER REFERRED TO AS OWNERS OF THE 10.9814 ACRE TRACT DESCRIBED IN THE ABOVE AND FOREGOING MAP OF DYLLA RANCH ESTATES, DO HEREBY MAKE AND ESTABLISH SAID SUBDIVISION AND DEVELOPMENT PLAN OF SAID PROPERTY ACCORDING TO ALL LINES, DEDICATIONS, RESTRICTIONS, AND NOTATIONS ON SAID MAP OR PLAT DO HEREBY DEDICATE TO THE USE OF THE PUBLIC FOREVER, ALL STREETS, ALLEYS, PARKS, WATER COURSES, DRAINS, EASEMENTS, AND PUBLIC PLACES SHOWN THEREON FOR THE PURPOSES AND CONSIDERATIONS THEREIN EXPRESSED; AND DO HEREBY BIND MYSELF, MY HEIRS, SUCCESSORS AND ASSIGNS TO WARRANT AND FOREVER DEFEND THE TITLE TO THE LAND SO DEDICATED.

FURTHER, OWNERS HAVE DEDICATED AND BY THESE PRESENTS DO DEDICATE TO THE USE OF THE PUBLIC FOR PUBLIC UTILITY PURPOSES FOREVER UNOBSTRUCTED AERIAL EASEMENTS. THE AERIAL EASEMENTS SHALL EXTEND HORIZONTALLY AN ADDITIONAL ELEVEN FEET, SIX INCHES (11' 6") FOR TEN FEET (10' 0") PERIMETER GROUND EASEMENTS OR SEVEN FEET, SIX INCHES (7' 6") FOR FOURTEEN FEET (14' 0") PERIMETER GROUND EASEMENTS OR FIVE FEET, SIX INCHES (5' 6") FOR SIXTEEN FEET (16' 0") PERIMETER GROUND EASEMENTS, FROM A PLANE SIXTEEN FEET (16' 0") ABOVE GROUND LEVEL UPWARD, LOCATED ADJACENT TO AND ADJOINING SAID PUBLIC UTILITY EASEMENTS THAT ARE DESIGNED WITH AERIAL EASEMENTS (U.E. AND A.E.) AS INDICATED AND DEPICTED HEREON, WHEREBY THE AERIAL EASEMENT TOTALS TWENTY ONE FEET, SIX INCHES (21' 6") IN WIDTH.

FURTHER, OWNERS HAVE DEDICATED AND BY THESE PRESENTS DO DEDICATE TO THE USE OF THE PUBLIC FOR PUBLIC UTILITY PURPOSES FOREVER UNOBSTRUCTED AERIAL EASEMENTS. THE AERIAL EASEMENTS SHALL EXTEND HORIZONTALLY AN ADDITIONAL TEN FEET (10' 0") FOR TEN FEET (10' 0") BACK-TO-BACK GROUND EASEMENTS OR EIGHT FEET (8' 0") FOR FOURTEEN FEET (14' 0") BACK-TO-BACK GROUND EASEMENTS OR SEVEN FEET (7' 0") FOR SIXTEEN FEET (16' 0") BACK-TO-BACK GROUND EASEMENTS, FROM A PLANE SIXTEEN FEET (16' 0") ABOVE GROUND LEVEL UPWARD, LOCATED ADJACENT TO BOTH SIDES AND ADJOINING SAID PUBLIC UTILITY EASEMENTS THAT ARE DESIGNED WITH AERIAL EASEMENTS (U.E. AND A.E.) AS INDICATED AND DEPICTED HEREON, WHEREBY THE AERIAL EASEMENT TOTALS THIRTY FEET (30' 0") IN WIDTH.

FURTHER, OWNERS DO HEREBY DECLARE THAT ALL PARCELS OF LAND DESIGNATED AS LOTS ON THIS PLAT ARE INTENDED FOR THE CONSTRUCTION OF SINGLE FAMILY RESIDENTIAL DWELLING UNITS THEREON AND SHALL BE RESTRICTED FOR SAME UNDER THE TERMS AND CONDITIONS OF SUCH RESTRICTIONS FILED SEPARATELY.

FURTHER, OWNERS DO HEREBY COVENANT AND AGREE THAT ALL OF THE PROPERTY WITHIN THE BOUNDARIES OF THIS PLAT SHALL BE RESTRICTED TO PREVENT THE DRAINAGE OF ANY SEPTIC TANK INTO ANY PUBLIC OR PRIVATE STREET, ROAD OR ALLEY OR ANY DRAINAGE DITCH, EITHER DIRECTLY OR INDIRECTLY.

FURTHER, OWNERS DO HEREBY DEDICATE TO THE PUBLIC A STRIP OF LAND TWENTY (20' 0") FEET WIDE ON EACH SIDE OF THE CENTER LINE OF ANY AND ALL BAYOUS, CREEKS, GULLIES, RAVINES, DRAINS, SLOUGHS, OR OTHER NATURAL DRAINAGE COURSES LOCATED IN SAID PLAT, AS EASEMENTS FOR DRAINAGE PURPOSES, GIVING FORT BEND COUNTY, OR ANY OTHER GOVERNMENTAL AGENCY, THE RIGHT TO ENTER UPON SAID EASEMENT AT ANY TIMES FOR THE PURPOSE OF CONSTRUCTION AND MAINTENANCE OF DRAINAGE FACILITIES AND STRUCTURES.

FURTHER, OWNERS DO HEREBY COVENANT AND AGREE THAT ALL OF THE PROPERTY WITHIN THE BOUNDARIES OF THIS PLAT AND ADJACENT TO ANY DRAINAGE EASEMENT, DITCH, GULLY, CREEK OR NATURAL DRAINAGE WAY IS HEREBY RESTRICTED TO KEEP SUCH DRAINAGE WAYS AND EASEMENTS CLEAR OF FENCES, BUILDINGS, PLANTING AND OTHER OBSTRUCTIONS TO THE OPERATIONS AND MAINTENANCE OF THE DRAINAGE FACILITY AND THAT SUCH ADJUTING PROPERTY SHALL NOT BE PERMITTED TO DRAIN DIRECTLY INTO THIS EASEMENT EXCEPT BY MEANS OF AN APPROVED DRAINAGE STRUCTURE.

FURTHER, OWNERS DO HEREBY ACKNOWLEDGE THE RECEIPT OF THE ORDERS FOR REGULATION OF OUTDOOR LIGHTING IN THE UNINCORPORATED AREAS OF FORT BEND COUNTY, TEXAS, AND DO HEREBY COVENANT AND AGREE AND SHALL COMPLY WITH THIS ORDER AS ADOPTED BY FORT BEND COUNTY COMMISSIONERS COURT ON MARCH 23, 2004, AND ANY SUBSEQUENT AMENDMENTS.

WITNESS MY HAND IN FORT BEND COUNTY, TEXAS, THIS ____ DAY OF _____, 2022.

BY: BRIANNE L. DYLLA A/K/A BRIANNE DYLLA, A MARRIED PERSON

STATE OF TEXAS:
COUNTY OF FORT BEND:

BEFORE ME, THE UNDERSIGNED AUTHORITY, ON THIS DAY PERSONALLY APPEARED BRIANNE L. DYLLA A/K/A BRIANNE DYLLA, A MARRIED PERSON, KNOWN TO ME TO BE THE PERSON WHOSE NAME IS SUBSCRIBED TO THE FOREGOING INSTRUMENT AND ACKNOWLEDGED TO ME THAT SHE EXECUTED THE SAME FOR THE PURPOSES AND CONSIDERATIONS THEREIN EXPRESSED AND IN THE CAPACITY THEREIN STATED.

GIVEN UNDER MY HAND AND SEAL OF OFFICE, THIS ____ DAY OF _____, 2022.

NOTARY PUBLIC IN AND FOR THE STATE OF TEXAS

MY COMMISSION EXPIRES _____ NOTARY PUBLIC

I, ROBERT CHRIS KELLY, AM AUTHORIZED UNDER THE LAWS OF THE STATE OF TEXAS TO PRACTICE THE PROFESSION OF SURVEYING AND HEREBY CERTIFY THAT THE ABOVE SUBDIVISION IS TRUE AND ACCURATE; WAS PREPARED FROM AN ACTUAL SURVEY OF THE PROPERTY MADE UNDER MY SUPERVISION ON THE GROUND; THAT, EXCEPT AS SHOWN ALL BOUNDARY CORNERS, ANGLE POINTS, POINTS OF CURVATURE AND OTHER POINTS OF REFERENCE HAVE BEEN MARKED WITH IRON RODS HAVING AN OUTSIDE DIAMETER OF FIVE-EIGHTHS (5/8) INCH AND A LENGTH OF THREE (3) FEET; AND THAT THE PLAT BOUNDARY CORNERS HAVE BEEN TIED TO THE TEXAS COORDINATE SYSTEM OF 1983, SOUTH CENTRAL ZONE.

ROBERT CHRIS KELLY, R.P.L.S.
TEXAS REGISTRATION NO. 6833



I, OSIEL PEREZ-ANGON, A PROFESSIONAL ENGINEER REGISTERED IN THE STATE OF TEXAS, DO HEREBY CERTIFY THAT THIS PLAT MEETS THE REQUIREMENTS OF FORT BEND COUNTY TO THE BEST OF MY KNOWLEDGE.

OSIEL PEREZ-ANGON, P.E.
TEXAS REGISTRATION NO. 141865

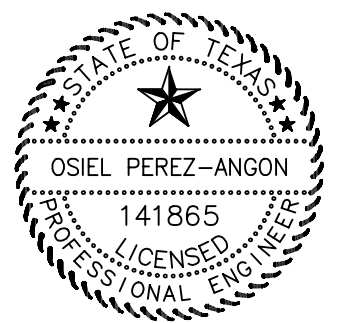

TROY ALLEN MILLS
AND CHELSEA E. MILLS
11.95 ACRES
(F.B.C.C.F. NO. 2021113537)

VALLU RIBBECK
10.24 ACRES
(F.B.C.C.F. NO. 2021091096)

KREITZ REVOCABLE LIVING TRUST
CALLED WEST 1/4 OF SECTION 46
(F.B.C.C.F. NO. 9537397)

GAYLA MARIE SCHMIDT MILLER
CALLED 1.333 ACRES
(VOL. 1714, PG. 101; F.B.C.D.R.)

BYRON JAMES MILLER
CALLED 39.983 ACRES
(VOL. 2399, PG. 292; F.B.C.D.R.)

H. & T. C. R. R. COMPANY SURVEY
(F. FORSTER SURVEY)
SECTION NO. 40
ABSTRACT NO. 470

H. & T. C. R. R. COMPANY SURVEY
SECTION NO. 41
ABSTRACT NO. 225

H. & T. C. R. R. COMPANY SURVEY
(G. HILBERT SURVEY)
SECTION NO. 46
ABSTRACT NO. 475

- LEGEND
- B. L. - BUILDING LINE
 - ESMT - EASEMENT
 - F. B. C. C. F. - FORT BEND COUNTY CLERK'S FILE
 - F. B. C. D. R. - FORT BEND COUNTY DEED RECORDS
 - F. B. C. D. D. - FORT BEND COUNTY DRAINAGE DISTRICT
 - F. B. C. P. R. - FORT BEND COUNTY PLAT RECORDS
 - FND - FUND
 - IP - IRON PIPE
 - IR - IRON ROD
 - L. E. - LANDSCAPE EASEMENT
 - R. D. V. - RIGHT OF WAY
 - SQ. FT. - SQUARE FEET
 - S. W. C. F. - STORM WATER CONTROL FACILITIES
 - W/ - WITH
 - - DENOTES A 5/8" IR W/CAP "MCKIM & CREED", UNLESS OTHERWISE NOTED

- NOTES:
- THE COORDINATES SHOWN HEREON ARE TEXAS SOUTH CENTRAL ZONE NO. 4204 STATE PLANE SURFACE COORDINATES (NAD '83) AND MAY BE CONVERTED TO GRID BY MULTIPLYING BY THE FOLLOWING COMBINED SCALE FACTOR OF 0.99986404721.
 - ACCORDING TO THE FEDERAL EMERGENCY MANAGEMENT AGENCY'S FLOOD INSURANCE RATE MAP FOR FORT BEND COUNTY, TEXAS AND INCORPORATED AREAS, COMMUNITY PANEL NO. 48157-C-0400 M, EFFECTIVELY DATED JANUARY 29, 2021, THIS PROPERTY LIES IN ZONE "X", AN AREA DETERMINED TO BE OUTSIDE OF THE 0.2% ANNUAL CHANCE FLOODPLAIN.
 - THE DRAINAGE SYSTEM FOR THIS SUBDIVISION SHALL BE DESIGNED TO MEET THE REQUIREMENTS OF THE FORT BEND COUNTY DRAINAGE CRITERIA MANUAL, WHICH ALLOWS STREET FLOODING WITH INTENSE RAINFALL EVENTS.
 - ALL DRAINAGE EASEMENTS TO BE KEPT CLEAR OF FENCES, BUILDINGS, VEGETATION AND OTHER OBSTRUCTIONS TO THE OPERATION AND MAINTENANCE OF THE DRAINAGE FACILITY.
 - THE TOP OF ALL FLOOR SLABS SHALL BE A MINIMUM OF 84.74 FEET (NAVD '88) ABOVE MEAN SEA LEVEL. IN ADDITION, NO SLAB SHALL BE LESS THAN 2.0 FEET ABOVE THE HIGHEST NATURAL GROUND ALONG THE PERIMETER OF THE BUILDING FOUNDATION OR LESS THAN 1.0 FOOT ABOVE ANY DOWN GRADIENT ROADWAY OR DRAINAGE RESTRAINT.
 - ALL PROPERTY TO DRAIN INTO DRAINAGE EASEMENT ONLY THROUGH AN APPROVED DRAINAGE STRUCTURE.
 - ALL OF THE PROPERTY SUBDIVIDED IN THE FOREGOING PLAT IS WHOLLY WITHIN THE NEEDVILLE I.S.D. AND FORT BEND COUNTY, TEXAS.
 - THIS PROPERTY IS IN DESIGNATED LIGHTING ZONE L2Z.
 - NO KNOWN PIPELINE NOR KNOWN PIPELINE EASEMENTS WERE FOUND OF RECORD OR ON-THE-GROUND WITHIN THE SUBJECT PROPERTY.
 - ABSENT WRITTEN AUTHORIZATION BY THE AFFECTED UTILITIES, ALL UTILITY AND AERIAL EASEMENTS MUST BE KEPT UNOBSTRUCTED FROM ANY NON-UTILITY IMPROVEMENTS OR OBSTRUCTIONS BY THE PROPERTY OWNER. ANY UNAUTHORIZED IMPROVEMENTS OR OBSTRUCTIONS MAY BE REMOVED BY ANY PUBLIC UTILITY AT THE PROPERTY OWNER'S EXPENSE. WHILE WOODEN POSTS AND PANELED WOODEN FENCES ALONG THE PERIMETER AND BACK TO BACK EASEMENTS AND ALONGSIDE REAR LOTS LINES ARE PERMITTED, THEY TOO MAY BE REMOVED BY PUBLIC UTILITIES AT THE PROPERTY OWNER'S EXPENSE SHOULD THEY BE AN OBSTRUCTION. PUBLIC UTILITIES MAY PUT SAID WOODEN POSTS AND PANELED WOODEN FENCES BACK UP, BUT GENERALLY WILL NOT REPLACE WITH NEW FENCING.
 - SITE PLANS SHALL BE SUBMITTED TO FORT BEND COUNTY AND ANY OTHER APPLICABLE JURISDICTION FOR REVIEW AND APPROVAL. DEVELOPMENT PERMITS AND ALL OTHER APPLICABLE PERMITS SHALL BE OBTAINED FROM FORT BEND COUNTY PRIOR TO BEGINNING CONSTRUCTION.
 - MAINTENANCE OF THE STORM WATER CONTROL FACILITIES SHALL BE THE RESPONSIBILITY OF THE LOT OWNERS; HOWEVER, FORT BEND COUNTY RESERVES THE RIGHT TO MAINTAIN THESE STORM WATER CONTROL FACILITIES, IF NECESSARY.
 - A MINIMUM DISTANCE OF 10 FEET SHALL BE MAINTAINED BETWEEN RESIDENTIAL DWELLINGS.
 - LAND USE WITHIN THE SUBDIVISION IS LIMITED TO AN AVERAGE IMPERVIOUSNESS OF NO MORE THAN 16.4 PERCENT. THE DRAINAGE AND/OR DETENTION SYSTEM HAS BEEN DESIGNED WITH THE ASSUMPTION THAT THIS AVERAGE PERCENT IMPERVIOUSNESS WILL NOT BE EXCEEDED. IF THIS PERCENTAGE IS TO BE EXCEEDED, A REPLAT AND/OR REDESIGN OF THE SYSTEM MAY BE NECESSARY.
 - THIS RURAL SUBDIVISION EMPLOYS A NATURAL DRAINAGE SYSTEM WHICH IS INTENDED TO PROVIDE DRAINAGE FOR THE SUBDIVISION THAT IS SIMILAR TO THAT WHICH EXISTED UNDER PRE-DEVELOPMENT CONDITIONS. THUS, DURING LARGE STORM EVENTS, PONDING OF WATER SHOULD BE EXPECTED TO OCCUR IN THE SUBDIVISION TO THE EXTENT IT MAY HAVE PRIOR TO DEVELOPMENT, BUT SUCH PONDING SHOULD NOT REMAIN FOR AN EXTENDED PERIOD OF TIME.

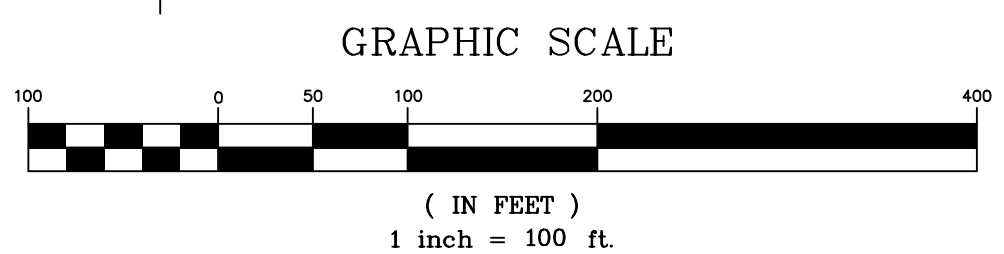
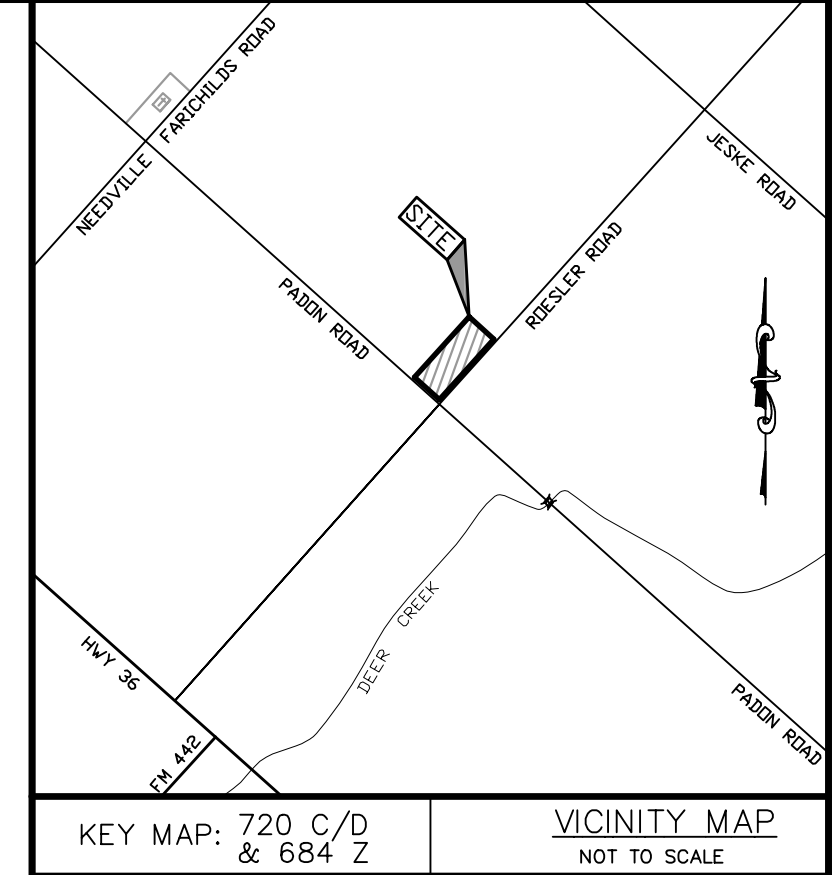

I, J. STACY SLAWINSKI, P.E., FORT BEND COUNTY ENGINEER, DO HEREBY CERTIFY THAT THE PLAT OF THIS SUBDIVISION COMPLES WITH ALL OF THE EXISTING RULES AND REGULATIONS OF THIS OFFICE AS ADOPTED BY THE FORT BEND COUNTY COMMISSIONERS' COURT; HOWEVER, NO CERTIFICATION IS HEREBY GIVEN AS TO THE EFFECT OF DRAINAGE FROM THIS SUBDIVISION ON THE INTERCEPTING DRAINAGE ARTERY OR PARENT STREAM OR ON ANY OTHER AREA OR SUBDIVISION WITHIN THE WATERSHED.

J. STACY SLAWINSKI, P.E.,
FORT BEND COUNTY ENGINEER

APPROVED BY THE COMMISSIONERS' COURT OF FORT BEND COUNTY, TEXAS THIS ____ DAY OF _____, 2022.

- VINCENT M. MORALES, JR., COMMISSIONER PRECINCT 1
- GRADY PRESTAGE, COMMISSIONER PRECINCT 2
- KP GEORGE, COUNTY JUDGE
- W. A. "ANDY" MEYERS, COMMISSIONER PRECINCT 3
- KEN R. DEMERCHANT, COMMISSIONER PRECINCT 4

I, LAURA RICHARD, COUNTY CLERK IN AND FOR FORT BEND COUNTY, DO HEREBY CERTIFY THAT THE FOREGOING INSTRUMENT WITH ITS CERTIFICATE OF AUTHENTICATION WAS FILED FOR RECORDATION IN MY OFFICE ON _____, 2022, AT _____ O'CLOCK _____ M, IN PLAT NUMBER(S) _____ OF THE PLAT RECORDS OF SAID COUNTY.

WITNESS MY HAND AND SEAL OF OFFICE, AT RICHMOND, TEXAS, THE DAY AND DATE LAST ABOVE WRITTEN.

BY: LAURA RICHARD, COUNTY CLERK
FORT BEND COUNTY, TEXAS
DEPUTY

LINE	BEARING	DISTANCE
L1	S 87°00'21" W	35.36'

DISTRICT NAMES	
COUNTY ASSISTANCE DISTRICT	N/A
WCID	N/A
MUD	N/A
LID	N/A
DID	N/A
SCHOOL	NEEDVILLE ISD
FIRE	N/A
IMPACT FEE AREA	N/A
CITY OR CITY ETJ	N/A
UTILITIES CO.	CENTERPOINT

WE, CAPITAL FARM CREDIT, ACA, OWNER AND HOLDER OF A LIEN AGAINST THE PROPERTY DESCRIBED IN THE PLAT KNOWN AS DYLLA RANCH ESTATES, IN INSTRUMENT OF RECORD IN FORT BEND COUNTY CLERK'S FILE NOS. 2021094555, DO HEREBY IN ALL THINGS SUBORDINATE TO SAID PLAT AND WE HEREBY CONFIRM THAT WE ARE THE PRESENT OWNERS OF SAID LIEN AND HAVE NOT ASSIGNED THE SAME NOR ANY PART THEREOF.

THIS ____ DAY OF _____, 2022.
BY: _____
BY: _____ (PRINT NAME AND TITLE)

STATE OF TEXAS:
COUNTY OF _____
BEFORE ME, THE UNDERSIGNED AUTHORITY, ON THIS DAY PERSONALLY APPEARED _____ OF CAPITAL FARM CREDIT, ACA, KNOWN TO ME TO BE THE PERSON WHOSE NAME IS SUBSCRIBED TO THE FOREGOING INSTRUMENT AND ACKNOWLEDGED TO ME THAT HE/SHE EXECUTED THE SAME FOR THE PURPOSES AND CONSIDERATIONS THEREIN EXPRESSED AND IN THE CAPACITY THEREIN STATED, AND AS THE ACT AND DEED OF SAID BANKING ASSOCIATION.
GIVEN UNDER MY HAND AND SEAL OF OFFICE, THIS ____ DAY OF _____, 2022.
NOTARY PUBLIC IN AND FOR THE STATE OF TEXAS
MY COMMISSION EXPIRES: _____ NOTARY

DYLLA RANCH ESTATES

A SUBDIVISION OF A 10.9814 ACRE TRACT OF LAND
IN THE H. & T. C. R. R. COMPANY SURVEY,
SECTION NO. 41, ABSTRACT NO. 225,
FORT BEND COUNTY, TEXAS

1 BLOCK - 5 LOTS - 0 RESERVES

~ OWNER ~
BRIANNE L. DYLLA
A/K/A BRIANNE DYLLA, A MARRIED PERSON
6626 Crown Oak Court
Richmond, Texas 77469
PHONE: 409.454.1566

~ SURVEYOR / ENGINEER ~
MCKIM & CREED
ENGINEERS, SURVEYORS, PLANNERS
12718 Century Drive
Stafford, Texas 77477
281.491.2525
www.mckimcreed.com
TBPELS Firm Registration No. 10177600
JOB NO. 08637-0001
MAY 18, 2022

SECTION NO. 41
H. & T. C. R. R. COMPANY SURVEY
ABSTRACT NO. 225

RICHMOORE FAMILY, LLC
CALLED 101.44 ACRES
(F.B.C.C.F. NO. 2020111217)

GRAPHIC SCALE

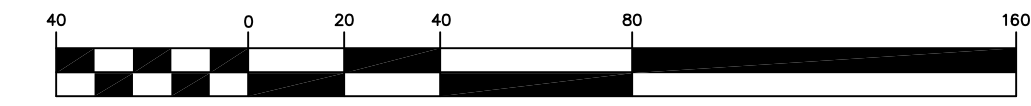

ELEVATIONS ARE BASED ON GPS OBSERVATIONS IN THE FIELD USING NGS C.O.R.S. (NAVD '88, GEOID 12A)

TBM A:
BOX CUT ON 24" RCP LOCATED AT THE INTERSECTION OF PADON ROAD AND ROESLER ROAD, AS SHOWN.
ELEVATION = 81.82'

N 42°00'26" E - 1,081.65'

1,056.65'

LOT 1
1.8565 ACRES

LOT 2
1.8565 ACRES

LOT 3
1.8565 ACRES

LOT 4
1.8565 ACRES

LOT 5
1.8565 ACRES

BRIANNE L. DYLLA c/k/a BRIANNE DYLLA
(F.B.C.C.F. NO. 2021094554)

S 87°00'21" W
35.36'

ROESLER ROAD (60' R.O.W.)

S 42°00'26" W - 1,081.65'

SECTION NO. 46
H. & T. C. R. R. COMPANY SURVEY
(G. HILBERT SURVEY)
ABSTRACT NO. 475

LEGEND

- BWF - BARBED WIRE FENCE
- CLS - CRUSHED LIMESTONE
- CMF - CORRUGATED METAL PIPE
- CP - CABLE PEDESTAL
- DG - DOWN GUY
- EB - ELECTRIC BOX
- F. B. C. C. F. - FORT BEND COUNTY CLERK'S FILE
- F. B. C. D. R. - FORT BEND COUNTY DEED RECORDS
- F. B. C. P. R. - FORT BEND COUNTY PLAT RECORDS
- FL - FLOW LINE
- FND - FOUND
- FDM - FIBER OPTIC CABLE MARKER
- IP - IRON PIPE
- IR - IRON ROD
- P- - OVERHEAD POWER LINE
- PP - POWER POLE
- RCF - REINFORCED CONCRETE PIPE
- R. D. W. - RIGHT OF WAY
- SQ. FT. - SQUARE FEET
- STM - STORM
- TBM - TEMPORARY BENCHMARK
- TP - TELEPHONE PEDESTAL
- UCM - UNDERGROUND CABLE MARKER
- W - WITH
- (NFV) - NOT FIELD VERIFIED

NOTES:

- 1.) BEARINGS SHOWN HEREON ARE BASED ON TEXAS STATE PLANE COORDINATE SYSTEM, SOUTH CENTRAL ZONE (NAD83) USING NGS CONTINUOUSLY OPERATING REFERENCE STATIONS.
- 2.) THE SURVEYOR HAS NOT ABSTRACTED THIS PROPERTY. DEED INFORMATION SHOWN HEREON WAS RESEARCHED AND PROVIDED BY OTHERS.
- 3.) THE CERTIFICATE SHOWN HEREON IS VALID ONLY IF THIS DOCUMENT CONTAINS AN ORIGINAL STAMPED OR IMPRESSION SEAL AND SIGNATURE OF THE SURVEYOR, SAID CERTIFICATION SHALL NOT APPLY TO ANY COPIES OR ALTERED ORIGINALS.
- 4.) THIS SURVEY WAS PERFORMED WITHOUT THE BENEFIT OF A CURRENT TITLE REPORT. ADDITIONAL ENCUMBRANCES MAY EXIST THAT ARE NOT SHOWN
- 5.) ACCORDING TO THE FEDERAL EMERGENCY MANAGEMENT AGENCY'S FLOOD INSURANCE RATE MAP FOR FORT BEND COUNTY, TEXAS AND INCORPORATED AREAS, COMMUNITY PANEL NO. 48157-C-0440 M EFFECTIVELY DATED JANUARY 29, 2021, THIS PROPERTY LIES IN ZONE "X", AN AREA DETERMINED TO BE OUTSIDE OF THE 0.2% ANNUAL CHANCE FLOODPLAIN.
- 6.) A METES-AND-BOUNDS DESCRIPTION WAS COMPILED IN CONJUNCTION WITH THIS SURVEY.
- 7.) ALL RODS SET ARE 5/8" IRON RODS WITH CAPS STAMPED: T.E.A.M. - 281-491-2525.
- 8.) THIS TRACT OF LAND WAS SURVEYED IN THE FIELD ON SEPTEMBER 27, 2021. ANY CHANGES MADE AFTER THIS DATE ARE NOT SHOWN HEREON.
- 9.) ALL UNDERGROUND UTILITIES MAY NOT BE SHOWN HEREON. THE LOCATIONS OF UTILITIES SHOWN HEREON ARE SHOWN PER RECORD DRAWINGS AND ABOVE GROUND EVIDENCE, SIZES, DEPTHS, AND LOCATIONS MAY VARY. FOR THE LOCATION OF ANY ADDITIONAL UTILITIES THAT MAY EXIST, PLEASE CALL THE "TEXAS ONE CALL" LOCATING SERVICE.

TEXAS ENGINEERING AND MAPPING CO.
12718 CENTURY DRIVE
STAFFORD, TEXAS 77477
PHONE: 281.491.2525 FAX: 281.491.2535
www.team-civil.com
Surveying Firm No. 10119000 / Engineering Firm No. F-2906

TOPOGRAPHIC SURVEY
OF
A 10.9814 ACRE TRACT OF LAND
IN SECTION NO. 41,
H. & T. C. R. R. COMPANY SURVEY,
ABSTRACT NO. 225,
FORT BEND COUNTY, TEXAS

CREW: RL	DRAWN BY: RCA	CALC. BY: BSN	CK BY: BSN
DATE: 10/05/21	SCALE: 1"=40'	KEY MAP: 720 D	JOB NO.: 0837-000

DRAWING INFO:

SECTION NO. 40
H. & T. C. R. R. COMPANY SURVEY
(F. FORSTER SURVEY)
ABSTRACT NO. 470

SECTION NO. 47
H. & T. C. R. R. COMPANY SURVEY
ABSTRACT NO. 228