

# KINGS MANOR

A MASTER PLAN OF ±318 ACRES  
 MONTGOMERY COUNTY AND HARRIS COUNTY, TEXAS.  
 PREPARED FOR FRIENDSWOOD DEVELOPMENT COMPANY  
**973 TOTAL LOTS**

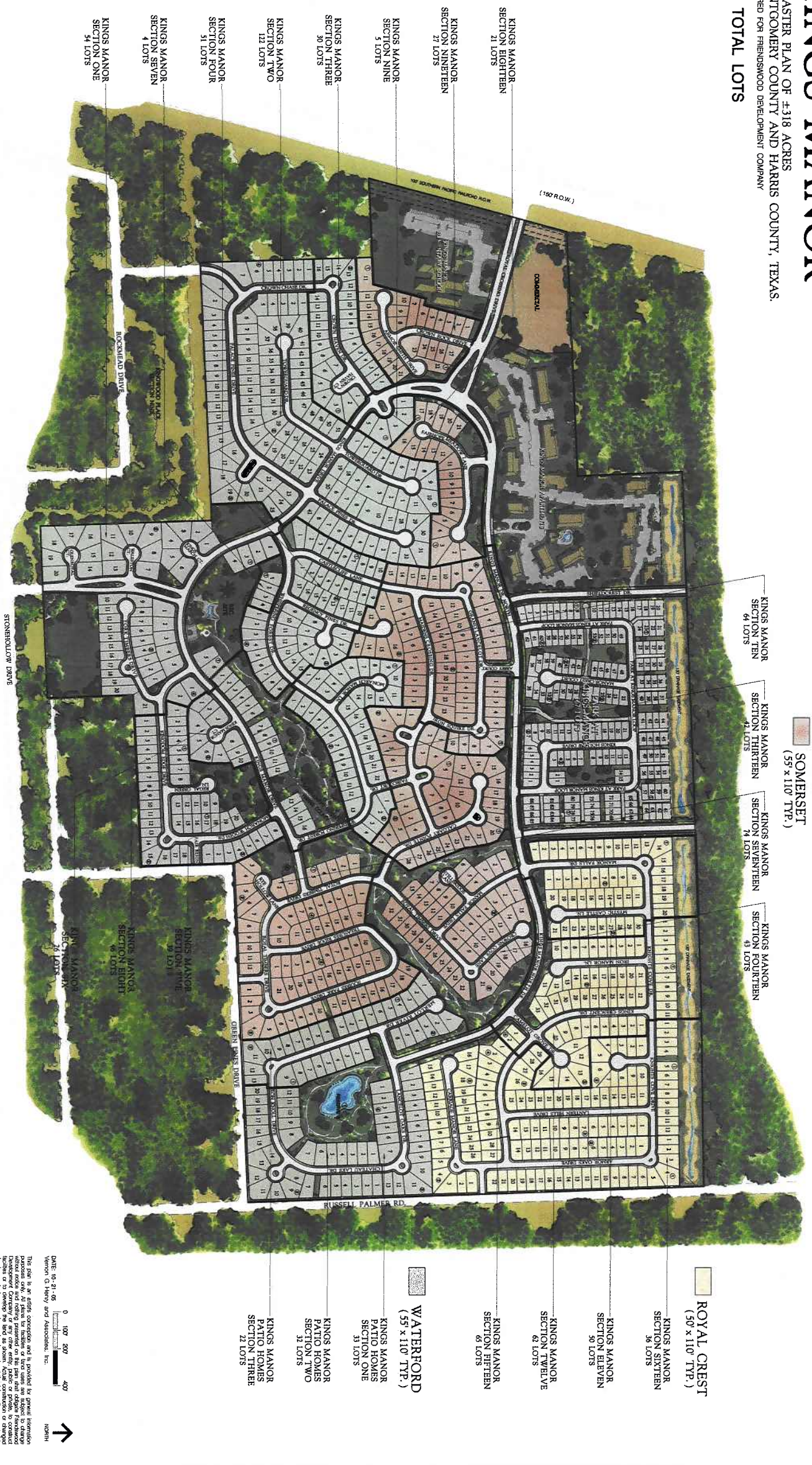

**SOMERSET**  
 (55' x 110' TYP.)

KINGS MANOR  
 SECTION EIGHTEEN  
 21 LOTS

KINGS MANOR  
 SECTION NINETEEN  
 27 LOTS

KINGS MANOR  
 SECTION NINE  
 5 LOTS

KINGS MANOR  
 SECTION THREE  
 30 LOTS

KINGS MANOR  
 SECTION TWO  
 12 LOTS

KINGS MANOR  
 SECTION FOUR  
 31 LOTS

KINGS MANOR  
 SECTION SEVEN  
 4 LOTS

KINGS MANOR  
 SECTION ONE  
 54 LOTS

KINGS MANOR  
 SECTION TEN  
 64 LOTS

KINGS MANOR  
 SECTION THIRTEEN  
 42 LOTS

KINGS MANOR  
 SECTION SEVENTEEN  
 74 LOTS

KINGS MANOR  
 SECTION FOURTEEN  
 43 LOTS

**ROYAL CREST**  
 (50' x 110' TYP.)

KINGS MANOR  
 SECTION SIXTEEN  
 36 LOTS

KINGS MANOR  
 SECTION SEVEN  
 90 LOTS

KINGS MANOR  
 SECTION TWELVE  
 62 LOTS

KINGS MANOR  
 SECTION FIFTEEN  
 65 LOTS

**WATERFORD**  
 (55' x 110' TYP.)

KINGS MANOR  
 PATIO HOMES  
 SECTION ONE  
 31 LOTS

KINGS MANOR  
 PATIO HOMES  
 SECTION TWO  
 32 LOTS

KINGS MANOR  
 PATIO HOMES  
 SECTION THREE  
 22 LOTS

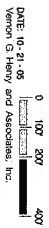

DATE: 10-21-08  
 Vernon G. Henry and Associates, Inc.



This plan is an artist's conception and is provided for general information only. It is not intended to be used as a legal document. The actual layout of the project may vary from the plan due to changes in site conditions, engineering requirements, or other factors. The developer reserves the right to modify the plan at any time without notice. The information presented in this plan is for informational purposes only and does not constitute an offer of real estate.