

LOCUST GROVE DRIVE (50')
 PINE FALLS DRIVE (50')
 N55°39'14"E 47.00'
 S34°20'46"E 83.53'
 S48°14'21"W 72.61'
 N34°20'46"W 117.90'
 S48°14'21"W 72.61'

L = 39.27'
 R = 25.00'

10' BL

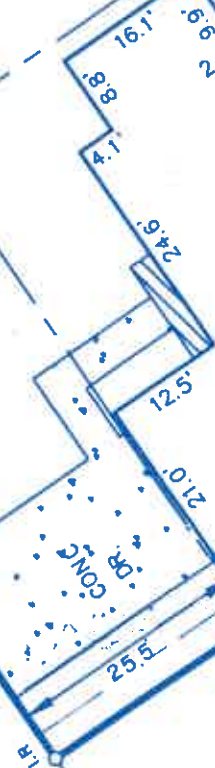

2 STORY BRICK/FRAME RESIDENCE

FND 5/8" I. ROD

LOT 15

LOT 14

BLOCK

(49)

LOT 16

[Signature]
 9/15/01

NOTES:
 1.) RESTRICTIVE COVENANTS AS SET OUT IN VOLUME 304, PAGE 84 H.C.M.R. AND UNDER H.C.C.F.# G-140051, G-181204, G-302044, AND H-249068.
 2.) H.L. & P. CO. AGREEMENT IN H.C.C.F.# H-272837.
 3.) GARAGE & BLDG. SET BACK LINES AND ESMIT'S AS RECORDED IN H.C.C.F.# G-140051, AND G-181204.
 4.) 3' SIDE LINE DRAINAGE EASEMENT PER H.C.C.F. NO. : G 140051 & G 181204
 5.) 2" WIDE CABLE (AUDIO/VIDEO) EASEMENT PER H.C.C.F. NO. G 181204 & G 140051
 SURVEYOR HAS NOT ABSTRACTED SUBJECT PROPERTY.
 SURVEY IS BASED ON TITLE COMMITMENT LISTED BELOW.
 ALL BEARINGS SHOWN ARE REFERENCED PER RECORDED PLAT OF SAID SUBDIVISION.
 ALL BUILDING LINES AND EASEMENTS ARE PER RECORDED PLAT UNLESS OTHERWISE SHOWN.
 THIS SURVEY IS CERTIFIED FOR THIS TRANSACTION ONLY. IT IS NOT TRANSFERABLE TO ADDITIONAL INSTITUTIONS OR SUBSEQUENT OWNERS.

LOT	BLOCK	SUBDIVISION	SECTION
15	49	COPPERFIELD NORTHMEAD VILLAGE	2
COUNTY	STATE	RECORDED	SURVEY:
HARRIS	TEXAS	VOLUME 304, PAGE 84 H.C.M.R.	ADDRESS
PURCHASER	KARI MARTIN		
15803 LOCUST GROVE DRIVE, HOUSTON, TEXAS 77095			
SCALE: 1" = 20'			

QUALIFIED REAL ESTATE SERVICES

9800 RICHMOND AVENUE
 SUITE 490
 HOUSTON, TEXAS 77042
 TEL: (713) 266-2990
 FAX: (713) 266-3080



[Signature]
 JOSE H. GONZALEZ
 I DO HEREBY CERTIFY THAT THIS SURVEY WAS THIS DAY MADE ON THE GROUND OF THE PROPERTY LEGALLY DESCRIBED HEREON AND IS CORRECT, AND THERE ARE NO ENCROACHMENTS UNLESS SHOWN HEREON.
 P.L.S. NO. 4478
 3/12/99

* Subject Property IS NOT Located in
 a Federal Insurance Administration Designated Flood
 Hazard Area.
 As per map
 Panel 0420J Dated NOV. 6, 1996
 480287
 * THIS INFORMATION IS BASED ON GRAPHIC
 PLOTTING ONLY. WE DO NOT ASSUME
 RESPONSIBILITY FOR EXACT DETERMINATION.

FIELD WORK	3-10-99	R/C
DRAFTING	3-11-99	WFS
FINAL CHECK	3-12-99	AT
KEY MAP	408E	

MORT. CO.	AURORA LOAN SERVICES
TITLE CO.	STEWART TITLE
G.F. NO.	98125743
JOB NO.	9903119
REV. DATE	