

NOTE: Restrictive Covenants as recorded in V-18, P-985, CC, Film Code No. 009-68-0793, 012-25-1352, OR.
 NOTE: An Unlocated Pipeline Right-of-Way Easement, as recorded in V-725, P-581, CC. (does not visibly affect property)

BUYER	John T. Russo and Wendy L. Russo	PROPERTY ADDRESS	24th Avenue North
-------	-------------------------------------	------------------	-------------------

DESCRIBED PROPERTY Lot 1, in Block 1, of WESTVIEW PARK SUBDIVISION ADDITION NO. 2, a subdivision in Galveston County, Texas, according to the map or plat thereof, recorded in Volume 18, Page 985, in the Office of the County Clerk of Galveston County, Texas.

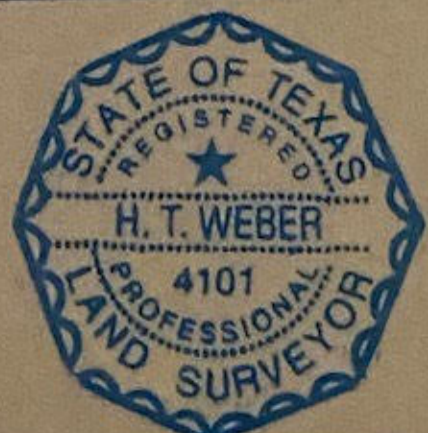

I do hereby certify that this survey was this day made on the ground of the property legally described hereon, (or on the attached sheet), is correct, and there are no encroachments except as shown, and was done by me or under my supervision, and conforms to or exceeds the current standards as adopted by the Texas Board of Professional Land Surveying.

H. T. Weber

SUBJECT PROPERTY DOES NOT LIE IN A F.I.A. DESIGNATED FLOOD ZONE AS PER FLOOD MAP NO. 485514 0035 C 5-2-83 Zone B

INVOICE #	22568	JOB #	6-74-05
G.F. #	05208017	DATE	6-2-05

NOTES
 -ALL BEARINGS ARE PER PLAT, DEED, OR AS ASSUMED
 -THIS SURVEY IS CERTIFIED FOR THIS TRANSACTION ONLY, IT IS NOT TRANSFERABLE TO ADDITIONAL INSTITUTIONS OR SUBSEQUENT OWNERS.
 -SUBJECT TO ANY AND ALL RECORDED AND UNRECORDED EASEMENTS.
 -FLOOD INFORMATION IS BASED ON GRAPHIC PLOTTING ONLY, DUE TO INHERENT INACCURACIES ON FEMA MAPS, WE CANNOT ASSUME RESPONSIBILITY FOR EXACT DETERMINATION.
 -THERE ARE NO NATURAL DRAINAGE COURSES ON THIS PROPERTY.

OFFICE	RS
DRAFTING	
FINAL CHECK	

SURVEY 1, INC.
 P. O. BOX 2543 • ALVIN, TX 77512
 (281) 393-1382 • Fax (281) 393-1383