



### INFORMATION ABOUT ON-SITE SEWER FACILITY

USE OF THIS FORM BY PERSONS WHO ARE NOT MEMBERS OF THE TEXAS ASSOCIATION OF REALTORS®, INC. IS NOT AUTHORIZED.  
©Texas Association of REALTORS®, Inc., 2004

17025 FM 2726

CONCERNING THE PROPERTY AT

Washington, TX 77880

#### A. DESCRIPTION OF ON-SITE SEWER FACILITY ON PROPERTY:

- (1) Type of Treatment System:  Septic Tank     Aerobic Treatment     Unknown
- (2) Type of Distribution System: field lines north downhill     Unknown
- (3) Approximate Location of Drain Field or Distribution System: forward the north wrought iron fence     Unknown
- (4) Installer: \_\_\_\_\_     Unknown
- (5) Approximate Age: 10 yrs     Unknown

#### B. MAINTENANCE INFORMATION:

- (1) Is Seller aware of any maintenance contract in effect for the on-site sewer facility?     Yes     No  
If yes, name of maintenance contractor: \_\_\_\_\_  
Phone: \_\_\_\_\_ contract expiration date: \_\_\_\_\_  
*Maintenance contracts must be in effect to operate aerobic treatment and certain non-standard on-site sewer facilities.)*
- (2) Approximate date any tanks were last pumped? never pumped
- (3) Is Seller aware of any defect or malfunction in the on-site sewer facility?     Yes     No  
If yes, explain: \_\_\_\_\_
- (4) Does Seller have manufacturer or warranty information available for review?     Yes     No

#### C. PLANNING MATERIALS, PERMITS, AND CONTRACTS:

- (1) The following items concerning the on-site sewer facility are attached:  
 planning materials     permit for original installation     final inspection when OSSF was installed  
 maintenance contract     manufacturer information     warranty information     Drawing
- (2) "Planning materials" are the supporting materials that describe the on-site sewer facility that are submitted to the permitting authority in order to obtain a permit to install the on-site sewer facility.
- (3) It may be necessary for a buyer to have the permit to operate an on-site sewer facility transferred to the buyer.

(TXR-1407) 1-7-04

Initialed for identification by Buyer \_\_\_\_\_ and Seller SBH

Page 1 of 2

D. INFORMATION FROM GOVERNMENTAL AGENCIES: Pamphlets describing on-site sewer facilities are available from the Texas Agricultural Extension Service. Information in the following table was obtained from Texas Commission on Environmental Quality (TCEQ) on 10/24/2002. The table estimates daily wastewater usage rates. Actual water usage data or other methods for calculating may be used if accurate and acceptable to TCEQ.

<u>Facility</u>	<u>Usage (gal/day) without water-saving devices</u>	<u>Usage (gal/day) with water-saving devices</u>
Single family dwelling (1-2 bedrooms; less than 1,500 sf)	225	180
Single family dwelling (3 bedrooms; less than 2,500 sf)	300	240
Single family dwelling (4 bedrooms; less than 3,500 sf)	375	300
Single family dwelling (5 bedrooms; less than 4,500 sf)	450	360
Single family dwelling (6 bedrooms; less than 5,500 sf)	525	420
Mobile home, condo, or townhouse (1-2 bedroom)	225	180
Mobile home, condo, or townhouse (each add'l bedroom)	75	60

This document is not a substitute for any inspections or warranties. This document was completed to the best of Seller's knowledge and belief on the date signed. Seller and real estate agents are not experts about on-site sewer facilities. Buyer is encouraged to have the on-site sewer facility inspected by an inspector of Buyer's choice.

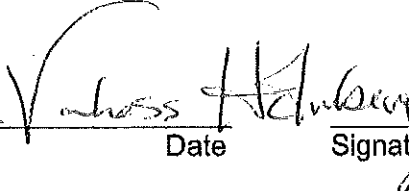
Signature of Seller \_\_\_\_\_ Date \_\_\_\_\_ Signature of Seller \_\_\_\_\_ Date 4-6-2003

Receipt acknowledged by:

Signature of Buyer \_\_\_\_\_ Date \_\_\_\_\_ Signature of Buyer \_\_\_\_\_ Date \_\_\_\_\_

WASHINGTON COUNTY ENVIRONMENTAL HEALTH DEPT.

AS-BUILT  
OSSF 11216



1 inch = 40 feet

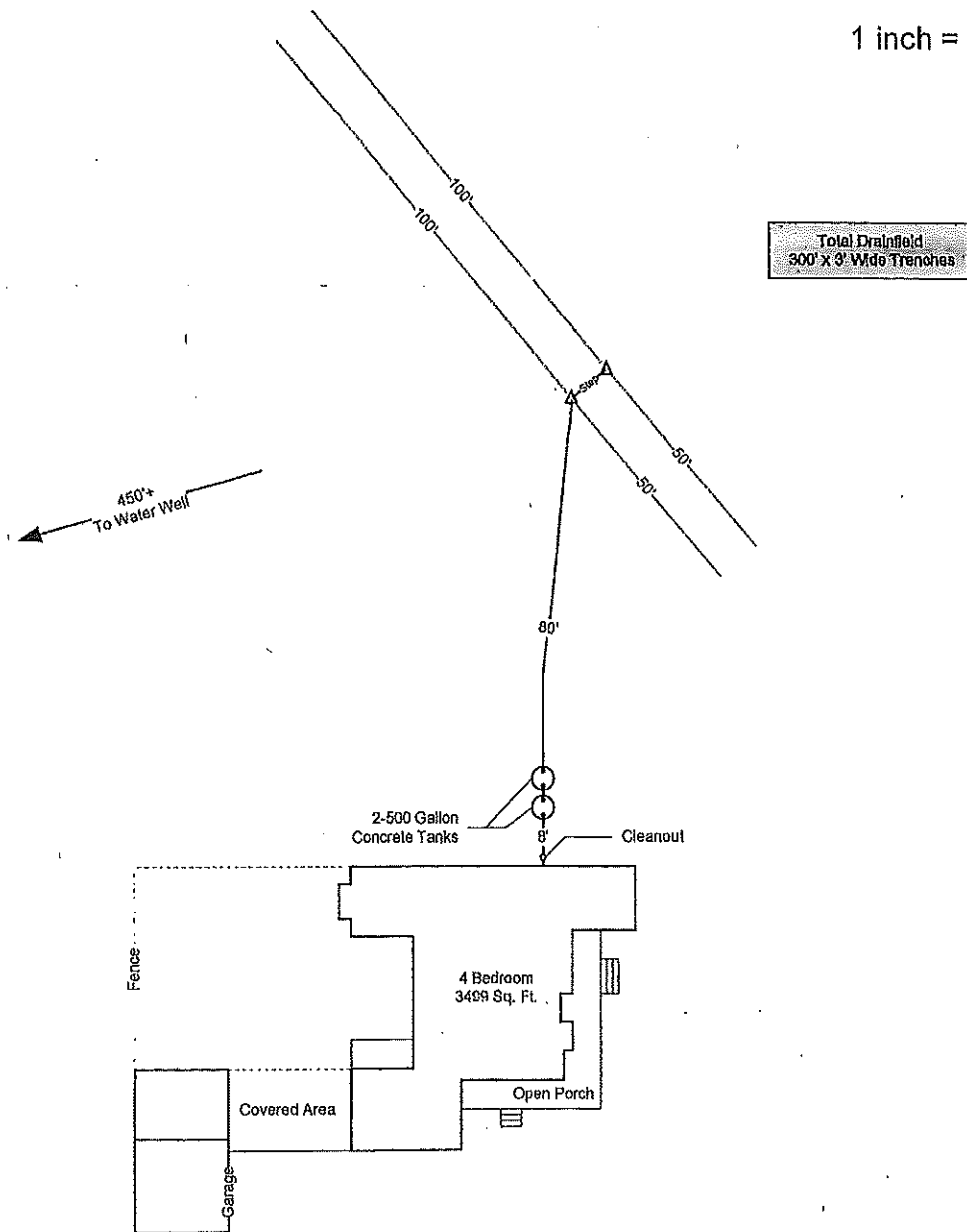

RENEE KMIIEC  
Designated Representative

OS25772

9/23/13  
DATE