

LOT 13

LOT 14

LOT 15

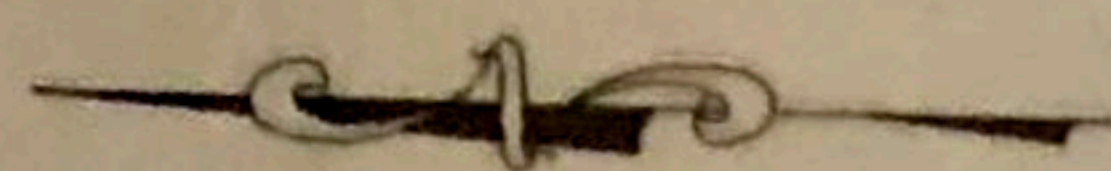

5' UE
5'x 20' AE

FENCE CORNER
(0.6' SOUTH
1.2' EAST)

FND. 3/4" IP
(EAST 0.9')

SOUTH 25.00'

SOUTH 1/2 OF
LOT 7
CF# T613542

NORTH 1/2 OF
LOT 7
CF# T412516

LOT 8

LOT 7

LOT 6

CF# U070370

③

2-1/2 STORY BRICK & FRAME
1713

2-1/2 STORY BRICK & FRAME
1715

S89°35'50"W

BRICK

0.0

0.0

10' BL

8'x50' SSE
CF# N922250

FND. "X"
CUT ON BRICK

NORTH 25.00'

FND. 1/2" IR

FND. 1/2" IR

FND. 1/2" IR

McDUFFIE
(50' R.O.W.)

NOTES:

1.) RESTRICTIVE COVENANTS AS SET OUT IN SCHEDULE "B", ITEM 1, OF TITLE COMMITMENT.

- IF CONSTRUCTION UPON OR A DIVISION OF SUBJECT TRACT IS PROPOSED AND IF TRACT LIES IN THE CITY OF HOUSTON OR ITS EXTRATERRITORIAL JURISDICTION, PLATTING AND OTHER REQUIREMENTS MAY APPLY PER CITY OF HOUSTON ORDINANCES.
- ABSTRACTING BY TITLE COMPANY.
- ALL BEARINGS SHOWN ARE BASED ON THE EAST RIGHT-OF-WAY LINE OF McDUFFIE ASSUMED TO BEAR "NORTH".

LEGAL		BLOCK	SUBDMISION		SECTION
SOUTH 1/2 OF LOT 7		3	WILFRAN PLACE		-
COUNTY	STATE	RECORDED		SURVEY:	SCALE: 1" = 20'
HARRIS	TEXAS	VOLUME 725 PAGE 230 H.C.D.R.		FIELD WORK: 3-20-00/PD	FINAL CHECK: 3-23-00/CB
PURCHASER	ASHTON J. HECKER AND DIANNE C. HECKER		DRAFTING: 3-22-00/BB	KEY MAP: 492R	
ADDRESS: 1715 McDUFFIE, HOUSTON, TEXAS					



ALLTEX
REALTY SERVICES

REAL ESTATE SURVEY DIVISION
9610 LONG POINT ROAD
SUITE 150
HOUSTON, TEXAS 77055

TEL: (713) 468-7707
FAX: (713) 468-8815

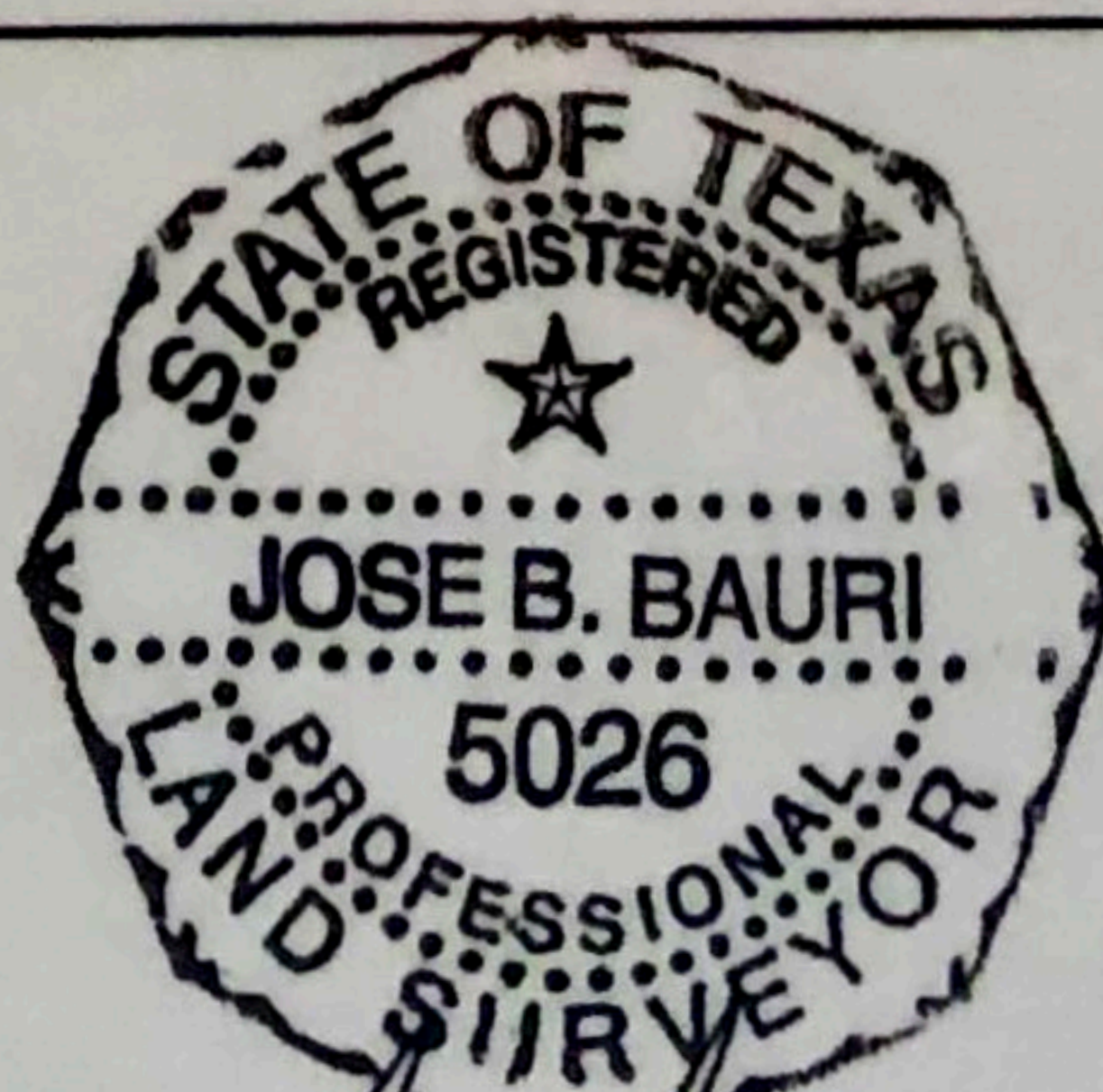

Jose B. Bauri

I DO HEREBY CERTIFY THAT THIS SURVEY WAS THIS DAY MADE ON THE GROUND OF THE PROPERTY LEGALLY DESCRIBED HEREON AND IS CORRECT AND THERE ARE NO ENCROACHMENTS UNLESS SHOWN HEREON.

• Subject Property IS NOT Located in a Federal Insurance Administration Designated Flood Hazard Area. ZONE "X"
As per map 480296
Panel 0670J Dated NOV. 6, 1996

• THIS INFORMATION IS BASED ON GRAPHIC PLOTTING ONLY. WE DO NOT ASSUME RESPONSIBILITY FOR EXACT DETERMINATION.

MORT. CO.	NORWEST MORTGAGE
TITLE CO.	CHICAGO TITLE CO.
G.F. NO.	254340
JOB NO.	00-25952
REV. DATE	