

Appraiser Certification



Certified Residential Real Estate Appraiser

Appraiser: **Debra Lyn Fitzpatrick**

License #: **TX 1327482 R**

License Expires: **09/30/2023**

Having provided satisfactory evidence of the qualifications required by the Texas Appraiser Licensing and Certification Act, Occupations Code, Chapter 1103, authorization is granted to use this title:
Certified Residential Real Estate Appraiser



Chelsea Buchholtz
Commissioner

For additional information or to file a complaint please contact TALCB at www.talcb.texas.gov.

Building Sketch

Borrower	Gloria Mechaley			
Property Address	16973 Mockingbird Ct			
City	Conroe	County	Montgomery	State TX Zip Code 77385
Lender/Client	Gloria Mechaley			

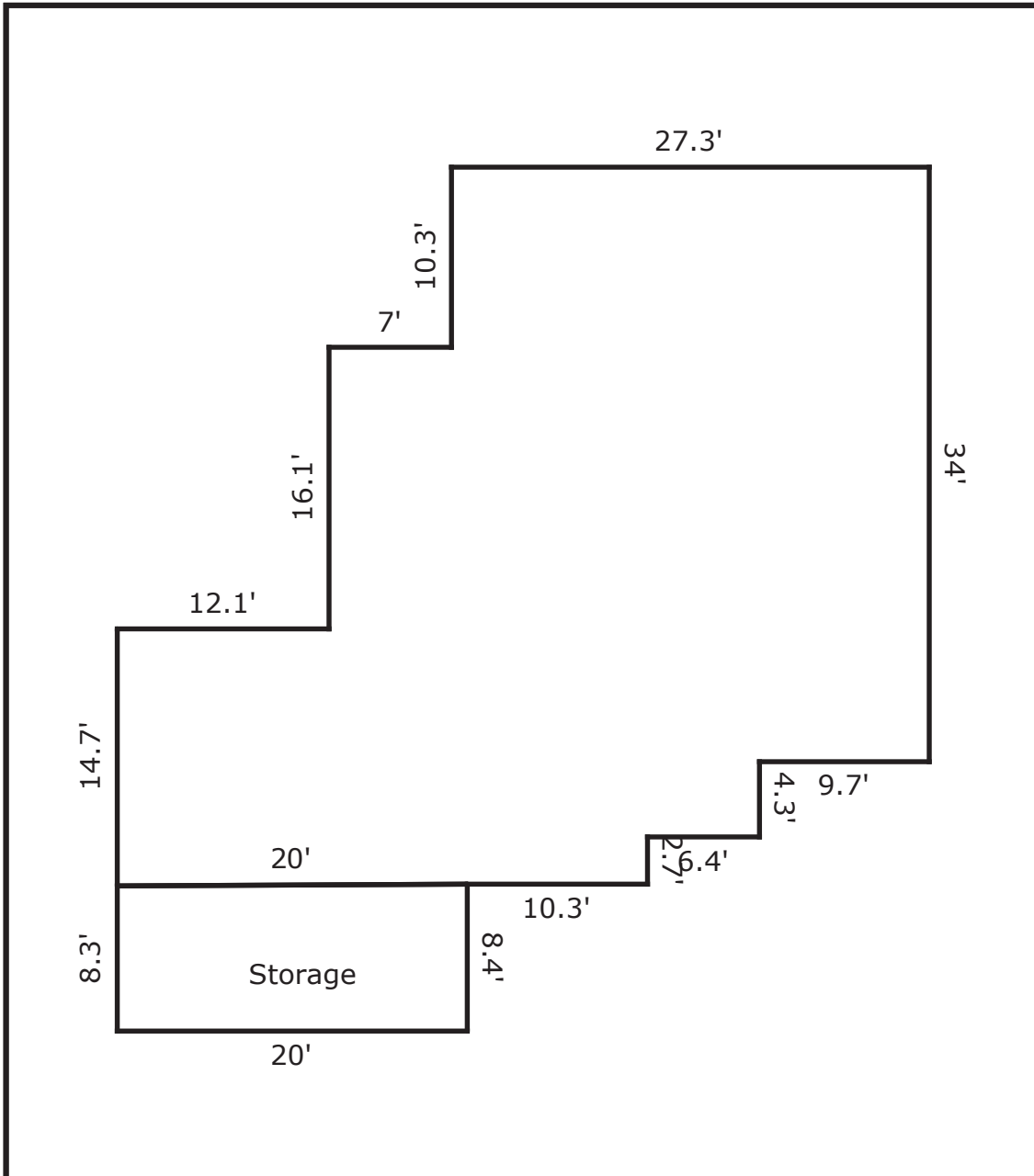

TOTAL Sketch by a la mode, inc.

Area Calculations Summary

Living Area	Area	Calculation Details
First Floor	1426.7 Sq ft	$0.5 \times 20 \times 0.1 = 1$ $30.3 \times 2.7 = 81.8$ $36.7 \times 4.3 = 157.8$ $46.4 \times 7.6 = 352.6$ $34.3 \times 16.1 = 552.2$ $27.3 \times 10.3 = 281.2$
Total Living Area (Rounded):	1427 Sq ft	
Non-living Area		
Storage	167 Sq ft	$20 \times 8.3 = 166$ $0.5 \times 20 \times 0.1 = 1$