

NOTES:
 NO RECORDS SEARCH CONTRACTED.
 SURVEY PREPARED FROM TITLE
 COMPANY SPECIFICATIONS PROVIDED
 BY CLIENT AS PER STEWART TITLE,
 GF #16167032318. CLIENT RELIES SOLELY
 ON TITLE COMPANY SPECIFICATIONS AS
 TO RECORD EASEMENTS, RESTRICTIONS,
 ROADWAYS, RIGHTS-OF-WAY, BUILDING
 LINES, ENCUMBRANCES, ETC.; CLIENT
 HOLDS TLTS, INC. HARMLESS FROM
 RESPONSIBILITY FOR SAME

- Restrictions as per recorded plat unless otherwise noted
- True ground distances shown
- Bearings assumed as platted
- File #2007010693, OCCGC
- :9' side building line (55' lot)
- :10' side street building line
- Survey monuments reconciled w/numerous previous surveys

Scale: 1" = 20'

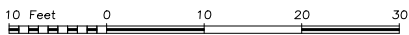

LAND TITLE SURVEY OF A TRACT OF LAND being Lot 9, in Block 2, of SEA ISLE, SECTION 24, a subdivision in Galveston County, Texas, according to the map or plat thereof recorded in Volume 2005A, Page 175, in the Office of the County Clerk of Galveston County, Texas.

Subject property: 22111 Cantina Drive
 Galveston County, Texas

This survey is certified for this transaction only and may only be relied on by Windward Homes. This survey is only valid if print has original seal and signature of surveyor.

I hereby certify that this survey was made on the ground under my direct supervision and that this plat correctly represents the facts found at the time of the survey.

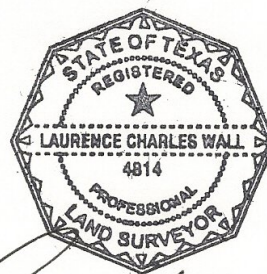

Laurence C. Wall

Laurence C. Wall
 RPLS #4814
 May 3, 2017

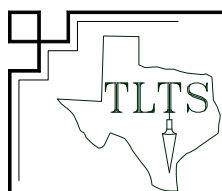

TLTS, Inc.
 TEXAS LAND TITLE SURVEYORS
 1801 Moody Avenue
 Galveston, Texas 77550
 (409) 765-8883