

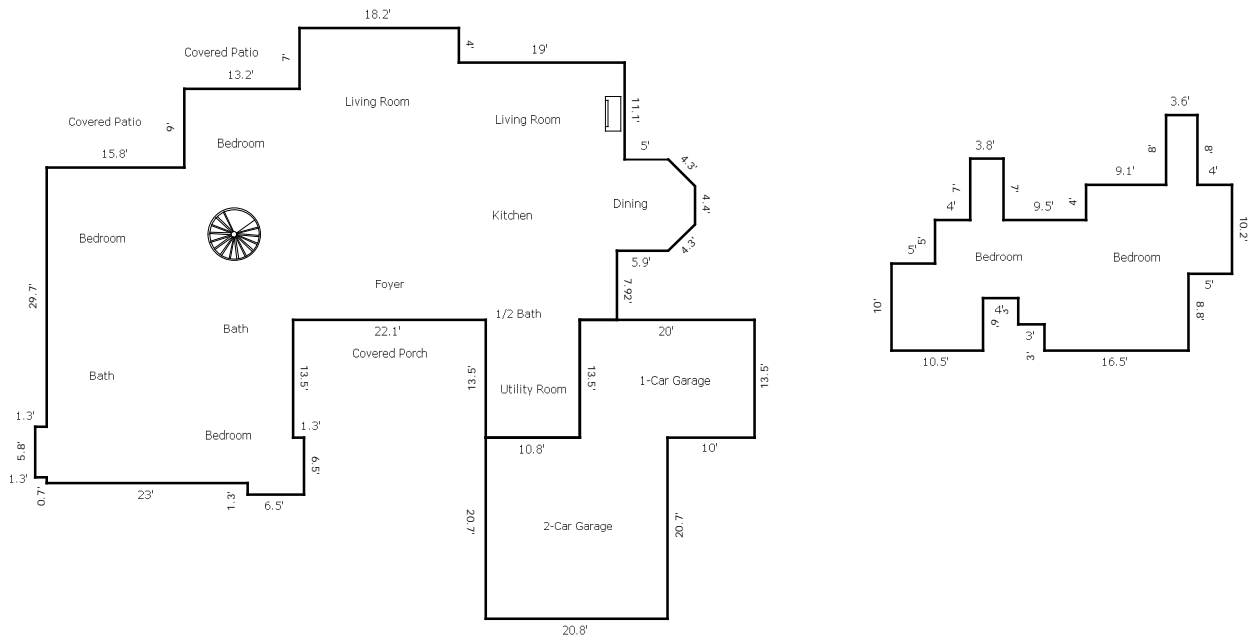

# Building Sketch (Page - 1)

Borrower	Mary Bruns & Christian Bruns III			
Property Address	100 Mesa Dr			
City	Wimberley	County Hays	State TX	Zip Code 78676
Lender/Client	Mary & Christian Bruns III			



TOTAL Sketch by a la mode, inc.

## Building Sketch (Page - 2)

Borrower	Mary Bruns & Christian Bruns III						
Property Address	100 Mesa Dr						
City	Wimberley	County	Hays	State	TX	Zip Code	78676
Lender/Client	Mary & Christian Bruns III						

Living Area			Calculation Details	
First Floor	2560.29 Sq ft		5.8 × 1.3	= 7.54
			10.8 × 13.5	= 145.8
			36.2 × 15.8	= 571.96
			18.2 × 4	= 72.8
			6.5 × 1.3	= 8.45
			13.7 × 5.2	= 71.24
			12.4 × 13.5	= 167.4
			26.5 × 13.2	= 349.8
			29.5 × 36.3	= 1070.85
			0.9 × 11.1	= 9.99
			10.48 × 5.9	= 61.84
			4.4 × 3.04	= 13.38
			0.5 × 3.04 × 3.04	= 4.62
			0.5 × 3.04 × 3.04	= 4.62
Second Floor	605.2 Sq ft		3.8 × 7	= 26.6
			3.6 × 8	= 28.8
			10 × 5	= 50
			10.2 × 5	= 51
			19 × 11.7	= 222.3
			4.8 × 3	= 14.4
			5.5 × 6	= 33
			9 × 9.5	= 85.5
			7.8 × 12	= 93.6
<b>Total Living Area (Rounded):</b>	<b>3165 Sq ft</b>			
<b>Non-living Area</b>				
3 Car Attached	700.56 Sq ft		20.8 × 20.7	= 430.56
			20 × 13.5	= 270

License

Borrower	Mary Bruns & Christian Bruns III				
Property Address	100 Mesa Dr				
City	Wimberley	County	Hays	State	TX Zip Code 78676
Lender/Client	Mary & Christian Bruns III				



**Certified Residential  
Real Estate Appraiser**

Appraiser: **JAMES RYAN BOLDRICK**

License #: **TX 1338616 R**

License Expires: **12/31/2023**

Having provided satisfactory evidence of the qualifications required by the Texas Appraiser Licensing and Certification Act, Occupations Code, Chapter 1103, authorization is granted to use this title:  
Certified Residential Real Estate Appraiser

For additional information or to file a complaint please contact TALCB at [www.talcb.texas.gov](http://www.talcb.texas.gov).

  
Chelsea Buchholtz  
Commissioner