

57

OFFICE  
MO-1424

THOS. P. CAMP & ASSOCIATES  
CIVIL ENGINEERING

NIGHT  
3805 SWARTHMORE  
MO-1424

Ellington Street 60' Wide

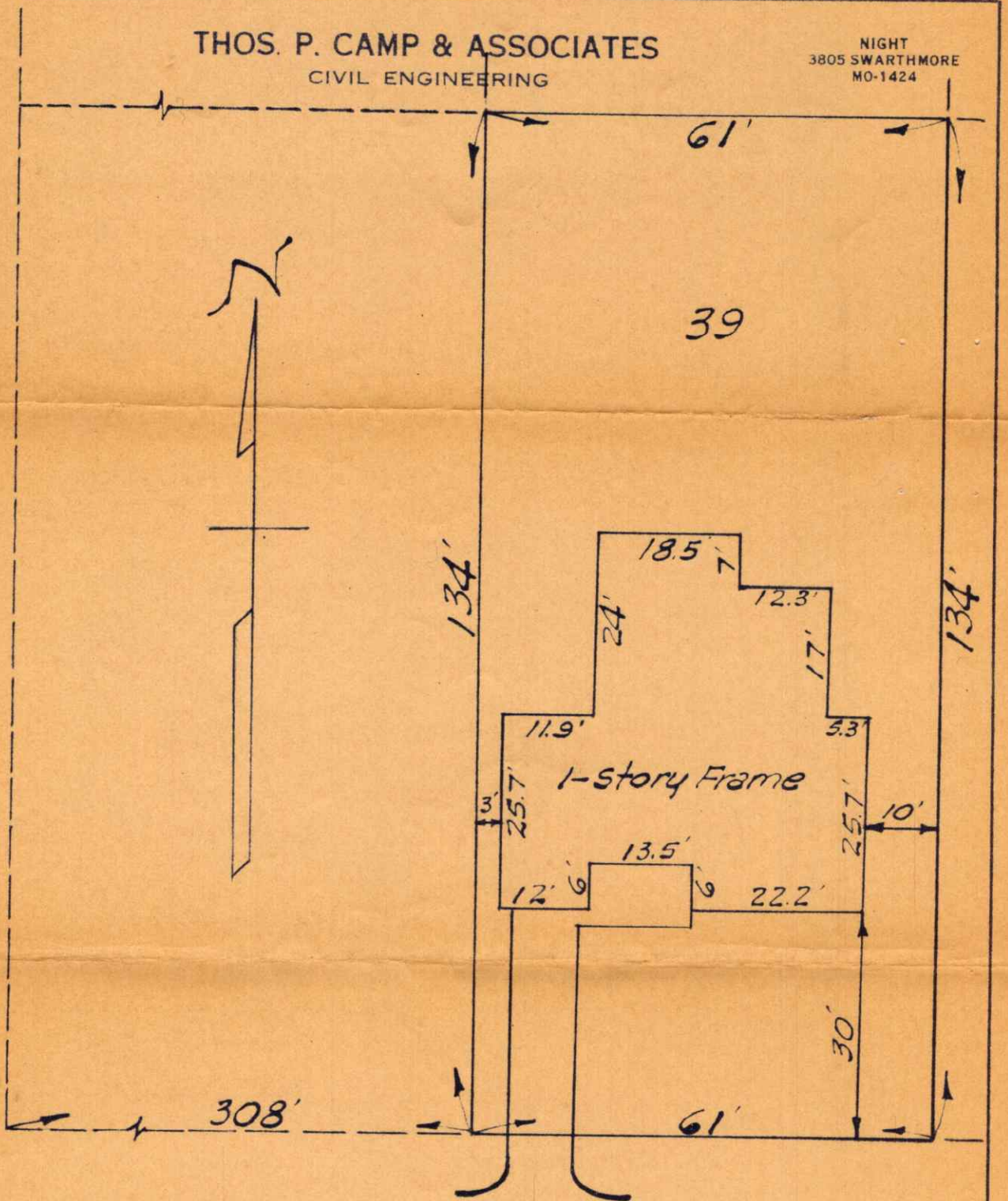

Hickok Lane 60' Wide - shell

PLAT OF PROPERTY

Scale: 1" = 20'

Lot 39 Block 55 Houston Skyscraper Shadows Add., Section 3, a S/D of the John T. Rockwell Survey.

I certify that the above is an accurate plat of the property of Edgar Lucas, at 9821 Hickok Lane, near Houston Texas, made by me on Jan. 18th 1953. The map of this property is recorded in Volume 36 Page 55 of the Map Records of Harris County, Texas.

There are no encroachments on this property at this time and all improvements lie wholly within the lot boundary lines of the property described above, and that the building set back line of \_\_\_\_\_ feet is in accordance with the recorded plat above referred to.

*Thos P. Camp*  
Surveyor

Unless staked, do not use for construction purposes.