

PREPARED BY:

EXACTA
TEXAS SURVEYORS

www.exacta365.com
P 281.763.7766 F 281.763.7767
250 West Oak Loop - Cedar Creek, Texas 78612



PROPERTY ADDRESS: 5922 TEMPLEGATE DRIVE HOUSTON, TEXAS 77066

SURVEY NUMBER: 1308.1540

FIELD WORK DATE: 8/20/2013

REVISION DATE(S): (REV.0 8/21/2013)

1308.1540
BOUNDARY SURVEY
HARRIS COUNTY



NOTES:
SETBACK INFORMATION PROVIDED BY OTHERS, NOT VERIFIED
LOT APPEARS TO BE SERVICED BY CITY WATER AND SEWER
FENCE OWNERSHIP NOT DETERMINED
U.A.E. - UNOBSTRUCTED AERIAL EASEMENT

- NOTES:**
- 1.) SUBJECT TO APPLICABLE RESTRICTIVE COVENANTS RECORDED IN VOL. 185, PG. 1, AND CLERK'S FILE NOS. D034199, M911889, V707873, 20080404654, 20100066883, 20110548217, 20110548218, 20110548219, 20110548220, 20120002499, AND 20120099937.
 - 2.) UNDERGROUND ELECTRIC AGREEMENT PER D045874 (BLANKET TYPE AGREEMENT).
 - 3.) SUBJECT TO THE TERMS, CONDITIONS AND PROVISIONS OF THE CITY OF HOUSTON ORDINANCE NO. 85-1878, RECORDED IN HARRIS COUNTY CLERK'S FILE NO. N253886, REAL PROPERTY RECORDS OF HARRIS COUNTY, TEXAS.
 - 4.) BUILDING SETBACK LINE PER M911889 (SHOWN HEREON).

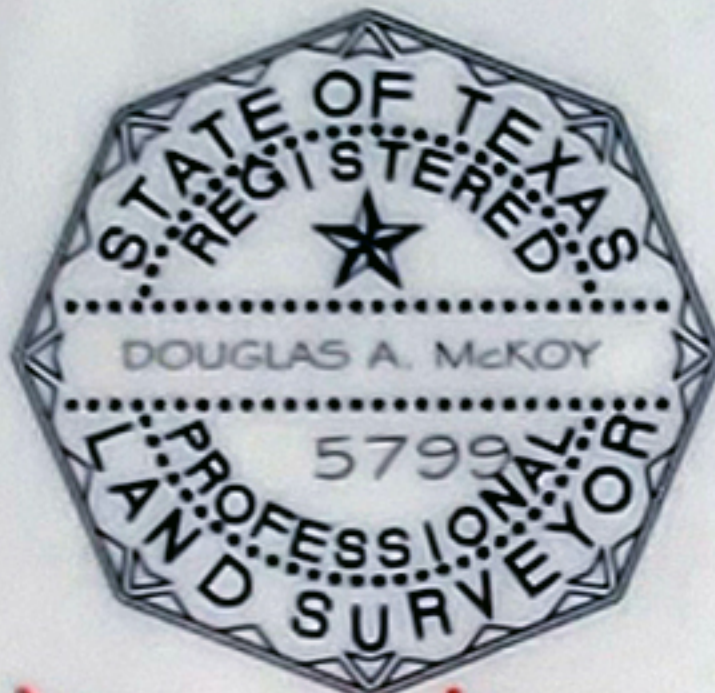

[Handwritten signature]

I HEREBY CERTIFY THAT THIS PLAT REPRESENTS THE RESULTS OF A SURVEY MADE ON THE GROUND ON THE 21st DAY OF AUGUST 2013.



GRAPHIC SCALE (In Feet)
1 inch = 30' ft.



Use of This Survey for Purposes other than Intended, Without Written Verification, will be at the User's Sole Risk and Without Liability to the Surveyor. Nothing hereon shall be Construed to Give ANY Rights or Benefits to Anyone Other than those Certified.

FLOOD INFORMATION:
BY PERFORMING A SEARCH WITH THE LOCAL GOVERNING MUNICIPALITY OR WWW.FEMA.GOV, THE PROPERTY APPEARS TO BE LOCATED IN ZONE X. THIS PROPERTY WAS FOUND IN HARRIS COUNTY, COMMUNITY NUMBER 480287, DATED 06/18/07.

POINTS OF INTEREST
1. SHED OVER 25' B.L. (P) 2. FENCE OVER 10' U.E. (P) 3. P/E OVER 10' U.E. (P) 4. CONC. DRIVEWAY OVER 3' U.E. (P) 5. CONCRETE WALK OVER 3' U.E. (P) 6. FENCE OVER 45'x2' U.E. (P) 7. GAR. OVER 3' B.L. (NOTE 4)

CLIENT NUMBER: 55996

DATE: 8/21/2013

BUYER: James Willis

SELLER: FEDERAL HOME LOAN MORTGAGE CORPORATION

CERTIFIED TO: James Willis; Texas American Title Company; Title Resources Guaranty Company; Citibank, N.A.

SURVEY COORDINATED BY:



P 866-772-8813 F 215-359-1733
www.truelinetech.com

EXACTA
Texas Surveyors, Inc.

www.exactalnd.com
P866-735-1916 • F866-744-2882

This is page 1 of 2 and is not valid without all pages.

LB# 101739-00

13492 Research Boulevard, Suite 120-402 • Austin, TX 78750

Page 1 of 3 in order 55996
File number: 7250-13-1098

Completed: 8/21/2013
Surveyed: 8/20/2013

Client: TEXAS AMERICAN TITLE COMPANY
Lender: CITIBANK, N.A.
Buyer: JAMES WILLIS
Seller: FEDERAL HOME LOAN MORTGAGE CORPORATION

COMMUNITY NUMBER: 480287
PANEL: 0435 SUFFIX: L
INDEX DATE: 06/18/07
F.I.R.M DATE: 06/18/07
ZONE: X

Premises: 5922 TEMPLEGATE DRIVE, HOUSTON, TEXAS 77066 HARRIS

Description of encroachments, violations or other points of interest at the time of the inspection:

1. SHED OVER 25' B.L. (P) 2. FENCE OVER 10' U.E. (P) 3. P/E OVER 10' U.E. (P) 4. CONC. DRIVEWAY OVER 3' U.E. (P) 5. CONCRETE WALK OVER 3' U.E. (P) 6. FENCE OVER 45'X2' U.E. (P) 7. GAR. OVER 3' B.L. (NOTE 4)



CERTIFIED TO: TEXAS AMERICAN TITLE COMPANY, CITIBANK, N.A.

LEGAL DESCRIPTION: LOT SIX (6), IN BLOCK ONE (1), OF GREENWOOD FOREST, SECTION ONE (1), A SUBDIVISION IN HARRIS COUNTY, TEXAS, ACCORDING TO THE MAP OR PLAT THEREOF, RECORDED IN VOLUME 165, PAGE 1 OF THE MAP RECORDS OF HARRIS COUNTY, TEXAS.

TRUeline TECHNOLOGIES LLC: THE FOLLOWING PRODUCT HAS BEEN COMPLETED BY THE STATE LICENSED LAND SURVEYING FIRM AS INDICATED ON THE FOLLOWING PAGE. TRUeline TECHNOLOGIES LLC PROVIDES THE DIGITAL TRANSMISSION AND ARCHIVING OF THE PRODUCT, AND IS NOT INVOLVED IN ANY FACET OF THE TECHNICAL FIELD WORK PERFORMED AND MAKES NO WARRANTIES AS TO THE ACCURACY OF SUCH WORK. ALL TRANSMISSIONS OF THE PRODUCT ARE VIA A SECURE 'SHA-1' SECURE HASH MESSAGE DIGEST AUTHENTICATION CODE WITHIN ITS SIGNATURE FILE. A MANUALLY SIGNED AND SEALED LOG OF THIS SURVEY'S SIGNATURE FILE IS KEPT ON FILE AT THE PERFORMING SURVEYORS OFFICE.

PRINTING PROCEDURES: BECAUSE THIS FILE HAS BEEN SENT ELECTRONICALLY, IT IS IMPERATIVE THAT THE PRINT SETTINGS BE CORRECT IN ORDER TO DEPICT AN ACCURATE REPRESENTATION OF THIS DOCUMENT ON PAPER. INSTRUCTIONS: WHILE VIEWING THE PRODUCT IN ADOBE READER, SELECT PRINT UNDER THE FILE TAB, SELECT COLOR PRINTER, UNDER PRINT RANGE - SELECT ALL, UNDER PAGE HANDLING, SELECT NONE FOR PAGE SCALING AND UNCHECK AUTO ROTATE AND CENTER, CHOOSE PAPER SOURCE BY PDF SIZE, CLICK PRINT.