

CURVE TABLE

CURVE	ARC LENGTH	RADIUS	DELTA ANGLE	CHORD BEARING	CHORD LENGTH
C1	127.42'	328.10'	22°39'14"	S 23°21'15" E	126.62'
C2	205.27'	388.10'	30°18'18"	S 27°27'42" E	202.89'
C3	6.78'	1402.40'	00°16'30"	S 42°30'08" E	6.78'

LINE TABLE

LINE	BEARING	DISTANCE
L1	S 12°33'56" E	47.93'
L2	S 42°33'36" E	757.65'
L3	S 56°31'57" W	534.27'
L4	N 49°54'18" W	568.16'
L5	S 57°28'45" W	271.13'
L6	S 57°27'12" W	297.44'
L7	N 10°49'02" W	435.14'
L8	N 21°52'44" E	158.65'
L9	N 05°56'29" E	106.75'
L10	N 89°25'15" E	100.22'
L11	N 88°34'32" E	99.49'
L12	N 34°58'04" W	15.82'
L13	N 48°57'29" E	675.19'

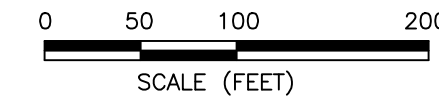

DETAIL N.T.S

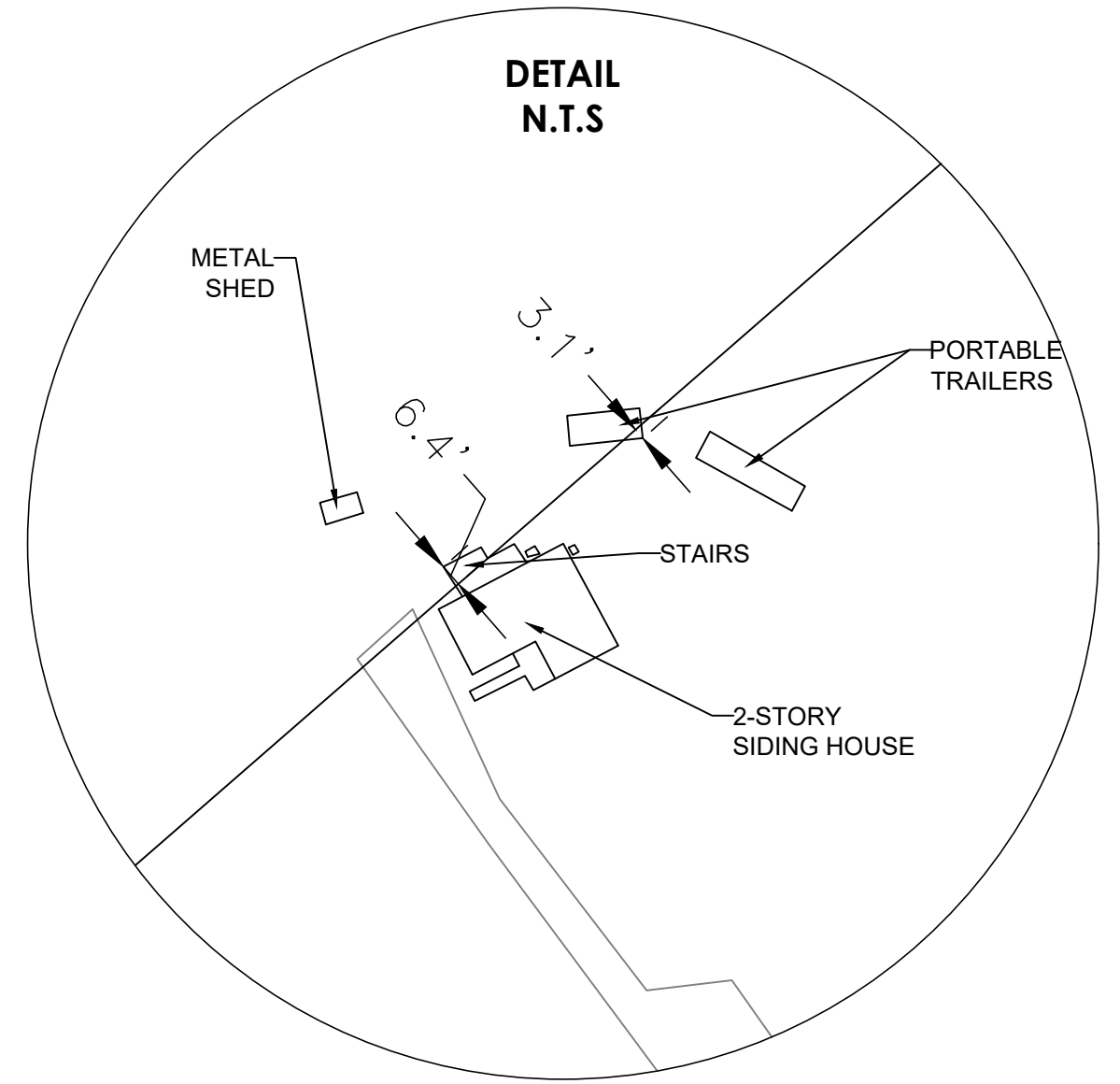

SEE
DETAIL

5.34 ACRES
WILLIAM R. CALL
DOC NO. 201906022132
O.P.R.C.C.T

19.854 ACRES

14.688 ACRES
JOY M. WILLIAMSON
DOC NO. 202106009104
O.P.R.C.C.T

LEGEND

- 1/2" IRON ROD FOUND (UNLESS NOTED)
- 1/2" IRON ROD SET
- CONCRETE MONUMENT
- P.O.B** POINT OF BEGINNING
- GUY WIRE
- POWER POLE
- WIRE FENCE
- CLEAN OUT

LEGAL DESCRIPTION

BEING A 19.854 ACRE TRACT, SITUATED IN THE RUSK TRANSPORTATION CO. SURVEY NO. 803, COMAL COUNTY, TEXAS, AND BEING ALL OF A CALLED 14.688 ACRE TRACT, RECORDED IN DOCUMENT NO. 202106009104, OFFICIAL PUBLIC RECORDS, COMAL COUNTY, TEXAS, AND ALL OF A CALLED 5.20 ACRE TRACT, RECORDED IN VOLUME 247, PAGE 102, DEED RECORDS, COMAL COUNTY, TEXAS.

SURVEYOR NOTES:
THIS BOUNDARY SURVEY WAS COMPLETED WITHOUT ADDITIONAL RESEARCH TO DETERMINE IF OTHER MATTERS OF RECORD, IF ANY, MIGHT AFFECT THIS PROPERTY, SUCH AS EASEMENTS, SETBACKS, OR OTHER ENCUMBRANCES.
BASIS OF BEARING IS NAD83 TEXAS STATE PLANE COORDINATES, SOUTH CENTRAL ZONE
DATE OF FIELDWORK: 06/25/2021

DESIGNED BY:	-
CHECKED BY:	XXXXXXXXXX
DRAWN BY:	DD
JOB:	21GS029
DATE:	06-29-2021
SCALE:	1" = 100'
SHEET:	1 OF 1

19.854 ACRES
CANYON LAKE, COMAL COUNTY, TEXAS

TIFFINY
WILLIAMSON

REVISIONS	DATE

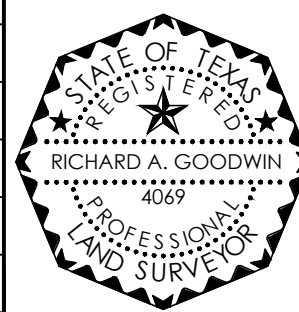

SURVEYORS CERTIFICATE
I, RICHARD A. GOODWIN, A REGISTERED PROFESSIONAL LAND SURVEYOR IN THE STATE OF TEXAS, REGISTRATION NUMBER 4069, HEREBY STATE THAT DURING THE MONTH OF JUNE, 2021, A SURVEY OF THE REAL PROPERTY SHOWN HEREON WAS MADE UPON THE GROUND UNDER MY DIRECTION AND SUPERVISION.
R.A. Goodwin
RICHARD A. GOODWIN
REGISTERED PROFESSIONAL LAND SURVEYOR NO. 4069
DATE: 6-30-21