

GF NO. 1556635-H144 HANSZEN LAPORTE  
 ADDRESS: 14902 CYPRESS MEADE COURT  
 CYPRESS, TEXAS 77429  
 BORROWER: GEORGE H. HAMILTON AND  
 TETYANA B. HAMILTON

# LOT 36, BLOCK 4 AMENDING PLAT OF CYPRESS MILL PARK SECTION 1

SCALE: 1" = 30'

ACCORDING TO THE MAP OR PLAT THEREOF RECORDED  
 IN FILM CODE NO. 417026, OF THE MAP AND/OR PLAT RECORDS  
 OF HARRIS COUNTY, TEXAS



THIS PROPERTY DOES NOT LIE WITHIN THE  
 100 YEAR FLOOD PLAIN AS PER FIRM  
 PANEL NO. 48201C 0405 L  
 MAP REVISION: 06/18/07  
 ZONE X  
 BASED ONLY ON VISUAL EXAMINATION OF MAPS.  
 INACCURACIES OF FEMA MAPS PREVENT EXACT  
 DETERMINATION WITHOUT DETAILED FIELD STUDY

A SUBSURFACE INVESTIGATION  
 WAS BEYOND THE SCOPE OF THIS SURVEY

D.C.L. = DIRECTIONAL CONTROL LINE  
 RECORD BEARING: FILM CODE NO. 417026 H.C.M.R.

DRAWN BY: JZ

I HEREBY CERTIFY THAT THIS SURVEY WAS MADE  
 ON THE GROUND, THAT THIS PLAT CORRECTLY  
 REPRESENTS THE FACTS FOUND AT THE  
 TIME OF SURVEY AND THAT THERE ARE NO  
 ENCROACHMENTS APPARENT ON THE GROUND,  
 EXCEPT AS SHOWN HEREON. THIS SURVEY IS  
 CERTIFIED FOR THIS TRANSACTION ONLY AND  
 ABSTRACTING PROVIDED IN THE ABOVE  
 REFERENCED TITLE COMMITMENT WAS RELIED  
 UPON IN PREPARATION OF THIS SURVEY.

JIMMY RAY JANECEK  
 PROFESSIONAL LAND SURVEYOR  
 NO. 5868  
 JOB NO. 11-06048  
 JULY 08, 2011  
 REVISED: JULY 12, 2011 (LOGO)

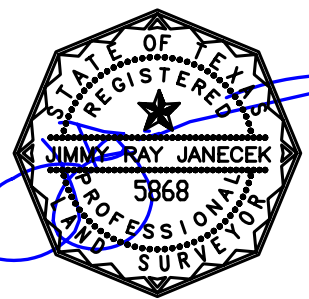

DAREL DAIK  
 713-680-8100



**PRECISION**  
 surveyors

1-800-LANDSURVEY  
 www.precisionsurveyors.com

281-496-1586 FAX 281-496-1867 210-829-4941 FAX 210-829-1555  
 14925 MEMORIAL DRIVE SUITE B100 HOUSTON, TEXAS 77079 1777 NE LOOP 410 SUITE 600 SAN ANTONIO, TEXAS 78217