

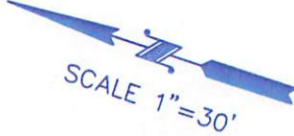

TITLE COMPANY:

Capital Title
 A Shaddock Company
 281-903-7908
 G.F. #: 19-408083-SG ISSUE DATE: 03-15-19

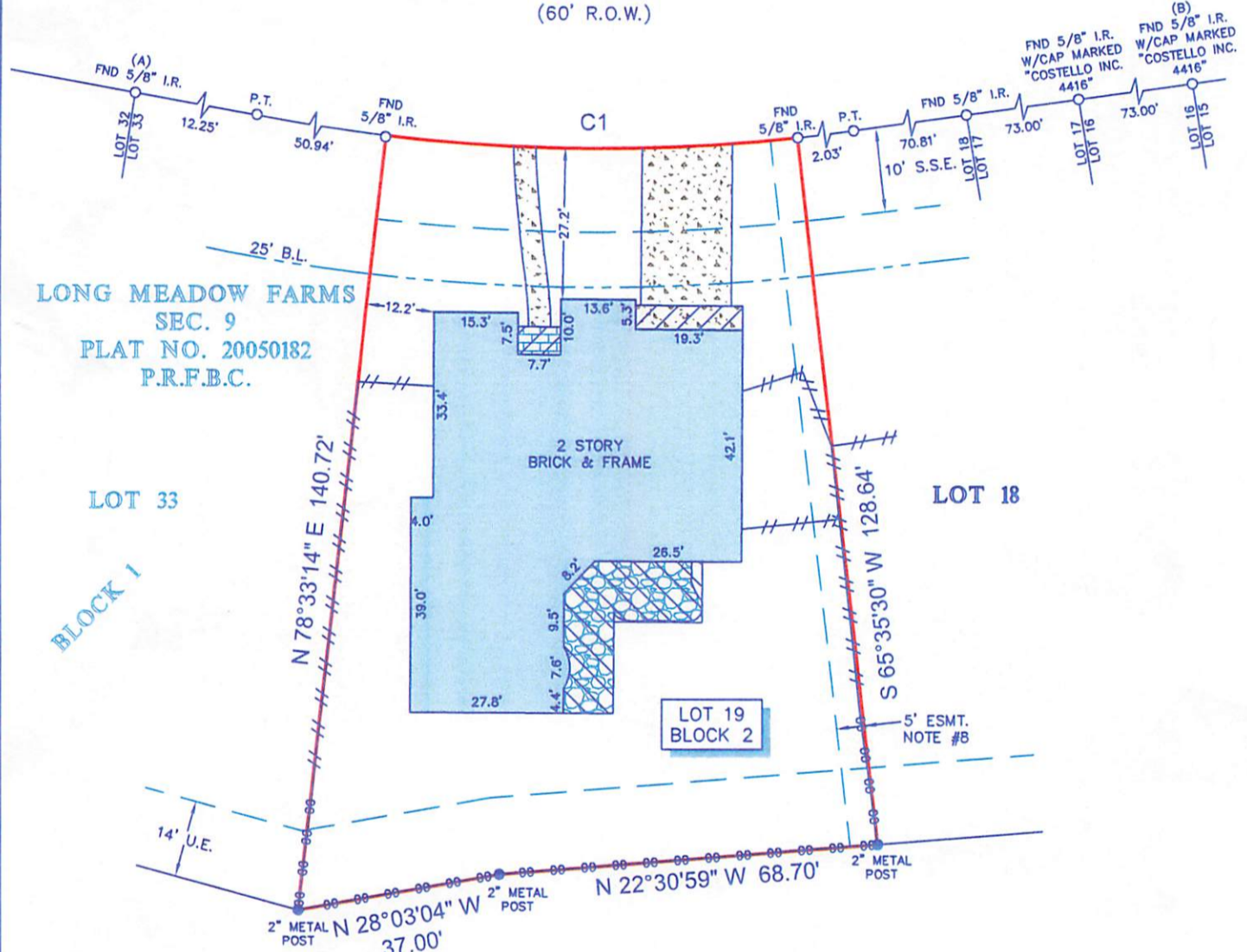







CRESCENT KNOLLS DRIVE
 (60' R.O.W.)

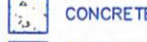

LEGEND

B.L. = BUILDING LINE
 U.E. = UTILITY EASEMENT
 S.S.E. = SANITARY SEWER EASEMENT

 CONCRETE  STONE
 COVERED AREA  ENCLOSED COVERED STONE
 BRICK

FENCE
 METAL
 WOOD

NOTES:

- ALL BEARINGS SHOWN HEREON ARE REFERENCED TO THE SUBDIVISION PLAT NAMED BELOW, POINTS (A) AND (B) WERE HELD FOR HORIZONTAL CONTROL.
- ABSTRACT INFORMATION FOR THE SUBJECT TRACT WAS PROVIDED BY THE TITLE INSURANCE COMPANY LISTED ABOVE.
- THIS SURVEY IS CERTIFIED TO THE TITLE INSURANCE COMPANY LISTED ABOVE FOR THIS TRANSACTION ONLY, IT IS NOT TRANSFERABLE TO ADDITIONAL INSTITUTIONS OR SUBSEQUENT OWNERS.
- ALL EASEMENTS AND BUILDING LINES SHOWN ARE PER THE RECORDED PLAT UNLESS OTHERWISE NOTED.
- THERE ARE NO NATURAL DRAINAGE COURSES ON SUBJECT PROPERTY.
- SUBJECT TO THE RESTRICTIVE COVENANTS AS LISTED IN SCHEDULE B OF THE TITLE COMMITMENT ISSUED ON 03-15-19, UNDER G.F. NO. 19-408083-SG.
- AN AGREEMENT WITH CENTERPOINT ENERGY FOR INSTALLATION, OPERATION & MAINTENANCE OF AN UNDERGROUND/OVERHEAD ELECTRICAL SERVICE DISTRIBUTION SYSTEM AS RECORDED UNDER C.F. NO. 2006088774 O.R.F.B.C.
- AN EASEMENT WITH CENTERPOINT ENERGY, SOUTHWESTERN BELL TELEPHONE AND TEXAS CABLE PARTNERS AS RECORDED UNDER C.F. NO. 2006088767 R.P.R.F.B.C.

| CURVE | RADIUS | LENGTH | CHORD BEARING | CHORD |
|-------|---------|--------|---------------|--------|
| C1 | 330.00' | 74.66' | S 17°55'37" E | 74.50' |

LEGAL DESCRIPTION: LOT 19, IN BLOCK 2, OF LONG MEADOW FARMS SEC. 11, A SUBDIVISION IN FORT BEND COUNTY, TEXAS, ACCORDING TO THE MAP OR PLAT THEREOF RECORDED IN PLAT NO. 20060019, OF THE PLAT RECORDS OF FORT BEND COUNTY, TEXAS.

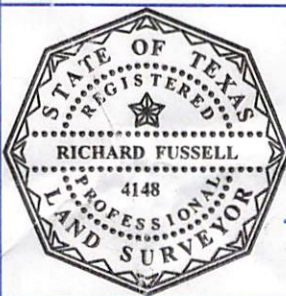

SURVEYORS CERTIFICATE:
 IN MY PROFESSIONAL OPINION, THIS PLAT REPRESENTS THE FACTS FOUND ON THE GROUND DURING THE COURSE OF A BOUNDARY SURVEY CONDUCTED UNDER MY SUPERVISION ON APRIL 8, 2019 AND THAT THIS PLAT SUBSTANTIALLY COMPLES WITH THE CURRENT STANDARDS AS ADOPTED BY THE TEXAS BOARD OF PROFESSIONAL LAND SURVEYING; AND THAT THERE ARE NO ENCROACHMENTS OR PROTRUSIONS EXCEPT AS SHOWN.

Richard Fussell
 RICHARD FUSSELL
 RPLS#4148

CLIENT:
 ANTHONY KEITH WOLVERTON AND SARAH SWINK WOLVERTON

ADDRESS:
 8206 CRESCENT KNOLLS DRIVE

www.survey1inc.com
 survey1@survey1inc.com

Survey 1, Inc.
 Your Land Survey Company
 Firm Registration No. 100758-00
 P.O. Box 2543 | Alvin, TX 77512 | (281)393-1382

| | |
|-------------------------|--------------------|
| FIELD CREW: NG | TECH: DC |
| DRAFTER: JB/DC | FINAL CHECK: EF |
| DATE: APRIL 11, 2019 | |
| JOB# 4-71744-19 | |