

Structural Options:

| | |
|-----------------------------------|-------------|
| 1. Roof Pitch | 6:12 |
| Lot Coverage Calculations: | |
| Lot Area: | 6681 Sq.Ft. |
| Slab Area: | 2117 Sq.Ft. |
| Coverage Ratio: | 32 % |

| | |
|-------------------------|------------|
| SOD Calculation: | |
| Front: | 138 Sq.Yd. |
| Side: | 67 Sq.Yd. |
| Rear: | 292 Sq.Yd. |
| Total: | 497 Sq.Yd. |

| | |
|---------------------------|------------|
| Fence Calculation: | |
| Front | 11 Ln.Ft. |
| Left | 52 Ln.Ft. |
| Right | 54 Ln.Ft. |
| Back | 50 Ln.Ft. |
| Total | 167 Ln.Ft. |

| | |
|------------------------|------------|
| Flatwork Areas: | |
| Private Walk (A): | 42 Sq.Ft. |
| Driveway (B): | 416 Sq.Ft. |
| In-Turn (C): | 202 Sq.Ft. |
| Public Walk (D): | 0 Sq.Ft. |
| Conc. Patio (E): | 0 Sq.Ft. |
| AC Pad: | 16 Sq.Ft. |

| | |
|----------------|--------------------|
| Legend: | |
| —x—x—x— | Fence |
| — | Lot |
| --- | Building Line |
| - - - - | Easement |
| — | Drive/Walk/Patio |
| — | Grade Beam |
| — | Retaining Wall |
| ▨ | Pad Area |
| ▩ | Slab/Porch |
| → | Drainage Direction |

General Notes:

- The purpose of this plan is to show the proposed building footprint as defined by the metes and bounds of the recorded plat.
- Dimensions, setbacks, easements, plan selection, and any other information shown here in shall be verified at permitting and prior to construction for accuracy and compliance with all applicable codes and ordinances.
- Builder is solely responsible for ensuring that the footprint is contained within the prepared building pad. The building pad shall be set high enough to allow for adequate drainage.
- All calculations are approximate. They must be verified prior to permitting, purchasing, and/or construction.

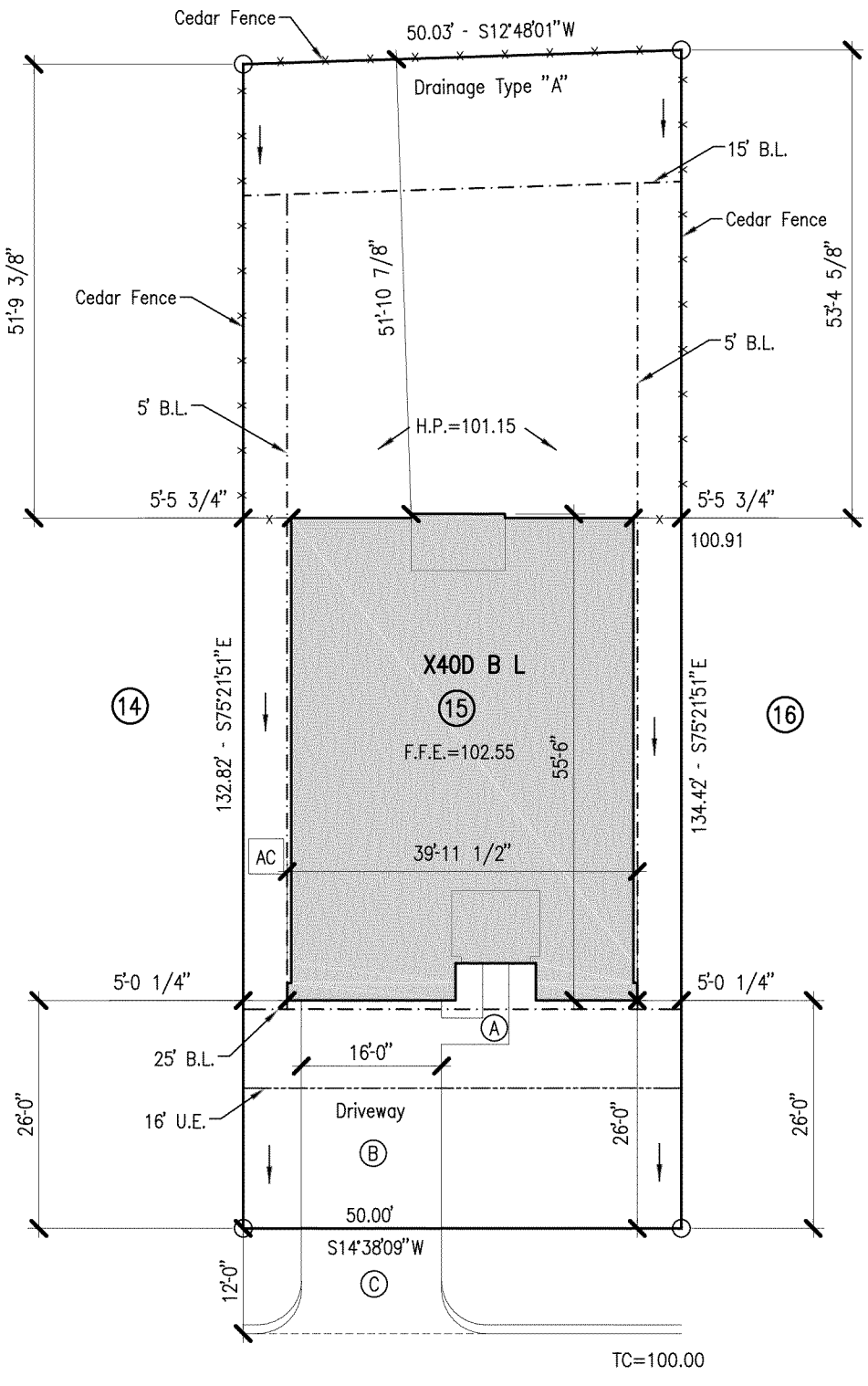

| | | | | | | | |
|-------------------|------------|---|---|------------------|-------------|---|---------------|
| STRAND 2309304 | PL1 | DATE 3/22/23 SCALE 1"=20' DR'N J.J.F. | BUILDER Express Homes Houston (North) SUBD. Summerwood Trails Section 2 LOT 15 BLOCK 7 ADDRESS 15256 Junebug Drive CITY Montgomery County, Texas PLAN X40D B L | PLOT PLAN | 3/27/23 | 10003 Technology Blvd. West Dallas, TX 75220 972-620-8204 Registration No: F-16229 | STRAND |
|-------------------|------------|---|---|------------------|-------------|---|---------------|

The use of these plans and specifications shall be restricted to the site for which they were prepared. Any reproduction or distribution is expressly limited to such use. Any other reproduction, reuse or disclosure by any method, in whole or in part, is prohibited. These drawings and specifications contain proprietary information and title remains in STRAND SYSTEMS ENGINEERING INC