

Building Sketch

Owner	Kenneth & Heather Moseman			
Property Address	3103 Katner Ln			
City	Spring	County	Montgomery	State TX Zip Code 77386
Lender	N/A			

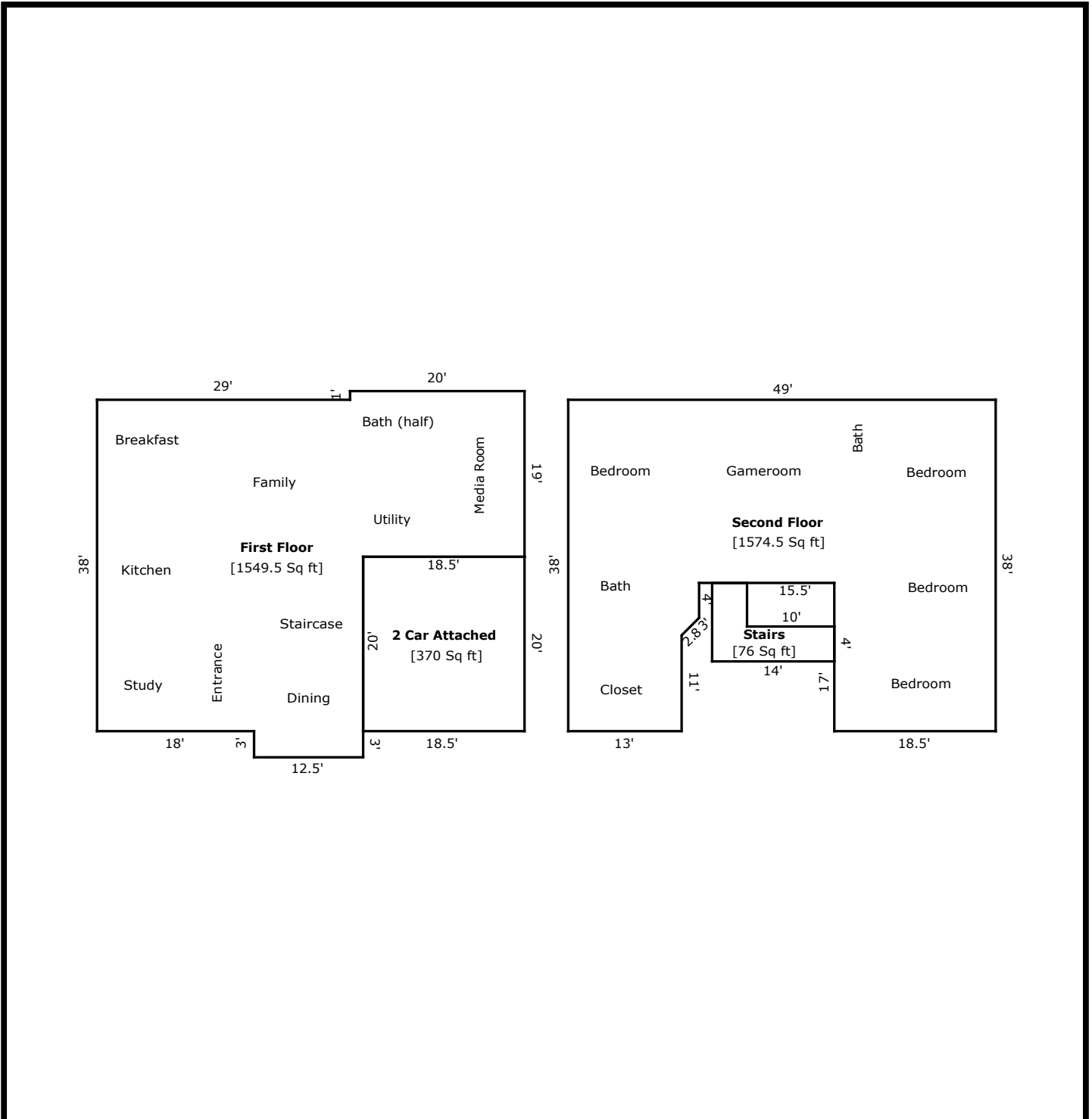

TOTAL Sketch by a la mode, inc.

Area Calculations Summary

Living Area	Area	Calculation Details
First Floor	1549.5 Sq ft	$19 \times 18.5 = 351.5$ $1.5 \times 1 = 1.5$ $30.5 \times 38 = 1159$ $12.5 \times 3 = 37.5$
Stairs	76 Sq ft	$4 \times 5 = 20$ $4 \times 14 = 56$
Second Floor	1574.5 Sq ft	$49 \times 21 = 1029$ $17 \times 18.5 = 314.5$ $0.5 \times 2 \times 2 = 2$ $4 \times 2 = 8$ $17 \times 13 = 221$
Total Living Area (Rounded):	3200 Sq ft	
Non-living Area		
2 Car Attached	370 Sq ft	$18.5 \times 20 = 370$